

65174 (D)

NW CORNER LOT 32, BLOCK 8,  
PARK ADDITION, CITY OF LIVINGSTON

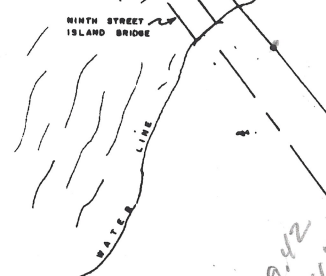

# SURVEY PLAT

OF  
A TRACT OF LAND LYING IN SECTION 24,  
T. 2 S., R. 9 E., P.M.N., Park County, Montana.

This Corner (13)

OWNER  
THELMA M. DUNN

- ISLAND CHATEAUX CONDOMINIUMS -

AS BUILT CURVE DATA  
Δ 89° 02' 30"  
R = 102.00'  
L = 171.83'  
C = 104.12'

ACRES  
2.595

OWNER  
RON HUISENGA, et ux.

N 36° 17' 13" W  
68.01

N 54° 46' 56" E 484.24  
N 74° 53' 09" E 53.54  
N 38° 35' 59" E 99.25

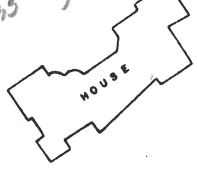

- ISLAND CHATEAUX CONDOMINIUMS -

### DESCRIPTION

A tract of land lying in section 24, T. 2 S., R. 9 E., P.M.N., Park County, Montana, which tract is more particularly described as follows:

From the northwest corner of Lot 32, Block 8, Park Addition to the City of Livingston, Montana, run S. 40° 00' 00" E. along the East line of Ninth Street for 2297.28 feet to the point of beginning of the herein described tract. From said point of beginning continue S. 40° 00' 00" E. for 254.88 feet; thence run S. 15° 38' 08" W. for 89.00 feet; thence run S. 42° 03' 18" E. for 365.04 feet; thence run N. 57° 06' 42" W. for 211.93 feet; thence run N. 56° 47' 13" W. for 68.01 feet; thence run N. 54° 46' 56" E. for 115.66 feet; thence run S. 84° 24' 26" E. for 36.35 feet; thence run N. 54° 53' 09" E. for 53.54 feet; thence run N. 38° 35' 59" E. for 99.25 feet; thence run N. 29° 22' 46" E. for 239.42 feet to the point of beginning. Containing 2.595 acres.

### COUNTY COMMISSIONERS CERTIFICATE OF APPROVAL

Approved this 5th day of June 1974  
County of Park, State of Montana.

By: *Norma Swilliger*  
Commissioner, Board of County Commissioners

### SURVEYORS CERTIFICATE

I hereby certify that the plat herein represented is a true and correct representation of a survey made and plotted under my direction, January 11, 1974.

*Louis V. Tout*  
Louis V. Tout, Registered Land Surveyor



0 - INDICATES IRON PIN SET OR FOUND UNLESS OTHERWISE NOTED. BASIS OF BEARING FROM COUNTY RECORDS OF PREVIOUS SURVEY.

122921  
Date June 5, 1974  
12:01 P.M.  
Margaret Monreal  
County Clerk and Recorder



LY & Associates  
Land Surveyors

88-34