

INSTRUCTIONS

1. Original and/or subsequent record used to evaluate the corner position.
2. Description of evidence found, note discrepancies in the record, state method of establishing lost or obliterated corners.
3. Description of monument and accessories set to perpetuate the corner position.
4. Sketch of corner, show all pertinent data which can best be shown in a sketch example, corner marking, topography ties, position of accessories, etc.
5. Certification must be signed and sealed by Land Surveyor licensed in the State of Montana.
6. Fill in Cross Index & Section Diagram at bottom of sheet.

PLSS CORNER RECORD

Corner C-N-S 1/64 of Section 7 T. 1 N., R. 7 E. P.M.M. Gallatin County

1. No previous record of monumentation.
2. Sept. 25, 2017: No evidence of monumentation found on the ground.
3. At mid-point, set 1 in. diam. by 24 ins. long aluminum rod, flush with the ground with a 3¼ ins. diam. aluminum cap marked as shown below.

Set red angle iron post with "Land Survey Marker" and "Property Boundary" decals alongside the monument.

Placed "Land Survey Monument" sign on nearby tree.

Corner is located on slight westerly facing slope in moderate pine and fir timber. An east-west line has been cleared and posted through this corner.

NAD83(2011) position determined with Survey Grade RTK GPS:
 Latitude: 45°50'00.251" N.
 Longitude: 110°54'06.548" W.

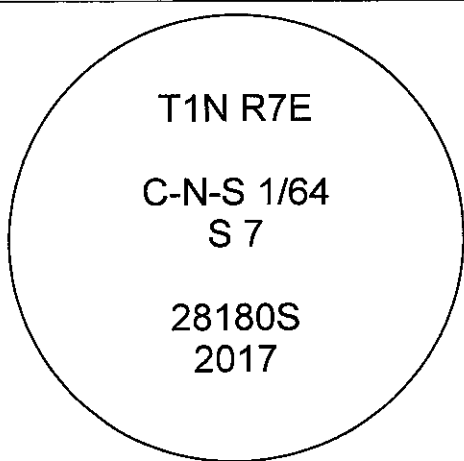
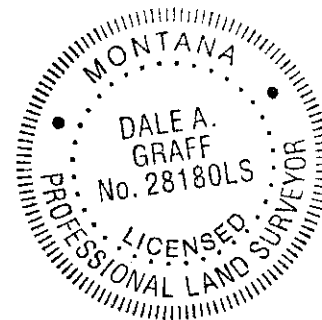

SKETCH OF CORNER

CERTIFICATION

I, _____
 certify the information shown herein is true and correct.

Signature of Ground Party Chief

I, **DALE A. GRAFF**

certify that this Corner Record correctly represents work performed by me or under my direction in compliance with the "Corner Recordation Act" (70-22-101, et seq., MCA)

Dale A. Graff
 Signature of Surveyor & Seal

Date: 01/18/18 Lic. No. 28180LS

Employer: U.S. Forest Service

2603844

Page: 1 of 2 B: 5 P: 123 01/17/2018 10:03:23 AM
 Charlotte Mills - Gallatin County, MT CORREC Fee: \$0.00



_____. This "corner"
 _____,
 _____, in Book No. _____

County Official

Sec. 7

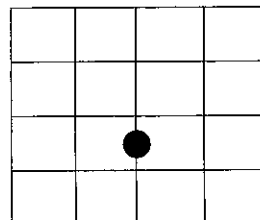

• — Corner this sheet

Cross Index No. G-H, 3 T. 1N R. 7E, PMM



INSTRUCTIONS

1. Original and/or subsequent record used to evaluate the corner position.
2. Description of evidence found, note discrepancies in the record, state method of establishing lost or obliterated corners.
3. Description of monument and accessories set to perpetuate the corner position.
4. Sketch of corner, show all pertinent data which can best be shown in a sketch example, corner marking, topography ties, position of accessories, etc.
5. Certification must be signed and sealed by Land Surveyor licensed in the State of Montana.
6. Fill in Cross Index & Section Diagram at bottom of sheet.

PLSS CORNER RECORD

Corner C-N-S 1/64 of Section 7 T. 1 N. , R. 7 E. P.M.M. Gallatin County

1. No previous record of monumentation.
2. Sept. 25, 2017: No evidence of monumentation found on the ground.
3. At mid-point, set 1 in. diam. by 24 ins. long aluminum rod, flush with the ground with a 3¼ ins. diam. aluminum cap marked as shown below.

Set red angle iron post with "Land Survey Marker" and "Property Boundary" decals alongside the monument.

Placed "Land Survey Monument" sign on nearby tree.

Corner is located on slight westerly facing slope in moderate pine and fir timber. An east-west line has been cleared and posted through this corner.

NAD83(2011) position determined with Survey Grade RTK GPS:
 Latitude: 45°50'00.251" N.
 Longitude: 110°54'06.548" W.

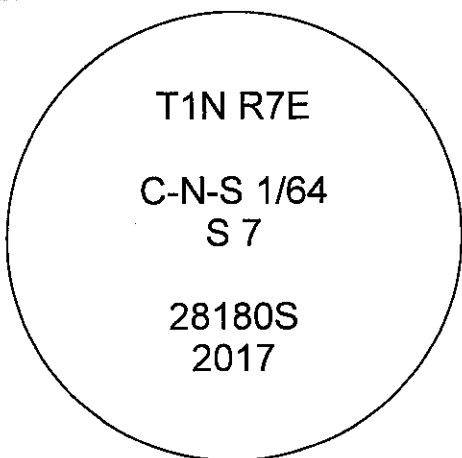
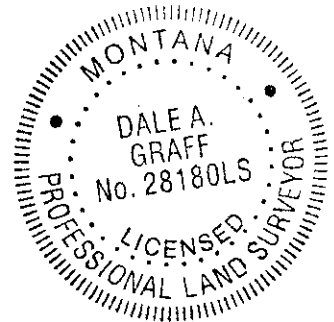

SKETCH OF CORNER

CERTIFICATION

I, _____, certify the information shown herein is true and correct.

Signature of Ground Party Chief

I, DALE A. GRAFF, certify that this Corner Record correctly represents work performed by me or under my direction in compliance with the "Corner Recordation Act" (70-22-101, et seq., MCA)

Dale A. Graff
 Signature of Surveyor & Seal

Date: 01/18/18 Lic. No. 28180LS

Employer: U.S. Forest Service

Sec. 7

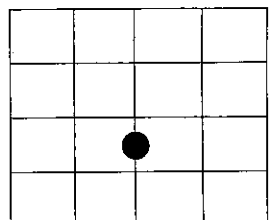

• — Corner this sheet

2603844

Page: 1 of 2 B: 5 P. 123 01/17/2018 10:03:23 AM
 Charlotte Mills - Gallatin County, MT CORREC Fee: \$0.00



_____. This "corner"
 _____,
 _____, in Book No. _____

 County Official

Cross Index No. G-H, 3 T. 1N R. 7E, PMM



INSTRUCTIONS

1. Original and/or subsequent record used to evaluate the corner position.
2. Description of evidence found, note discrepancies in the record, state method of establishing lost or obliterated corners.
3. Description of monument and accessories set to perpetuate the corner position.
4. Sketch of corner, show all pertinent data which can best be shown in a sketch example, corner marking, topography ties, position of accessories, etc.
5. Certification must be signed and sealed by Land Surveyor licensed in the State of Montana.
6. Fill in Cross Index & Section Diagram at bottom of sheet.

PLSS CORNER RECORD

Corner C 1/4 of Section 7 T. 1 N., R. 7 E. P.M.M. Gallatin County

1. No previous record of monumentation.
2. Oct. 18, 2017: No evidence of monumentation found on the ground.
3. Aug. 7, 2017: At intersection, point falls on the edge of a pine stump where it is impractical to establish a permanent monument.

Witness Corner bears S. 20°29'13" W., 5.56 ft. dist., set 2½ ins. diam. by 18 ins. long aluminum rod, 14 ins. in the ground in a collar of stones, 20 ins. diam., with a ¾ ins. diam. aluminum cap marked as shown below;

Set a red angle iron post with "Land Survey Marker" and "Property Boundary" decals on north side of the monument.

Placed "Land Survey Monument" sign on nearby tree.

Corner is located on near level ground among second growth pine.

NAD83(2011) position determined with Survey Grade RTK GPS:
Latitude: 45°50'00.251" N.
Longitude: 110°54'06.548" W.

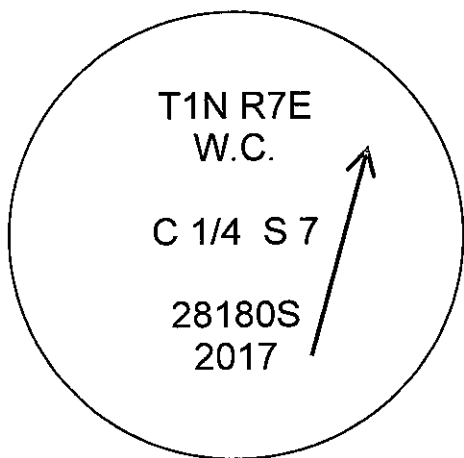
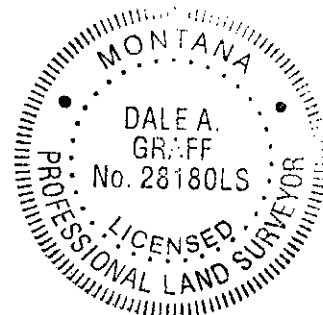

SKETCH OF CORNER

CERTIFICATION

I, _____ certify the information shown herein is true and correct.

Signature of Ground Party Chief

I, DALE A. GRAFF

certify that this Corner Record correctly represents work performed by me or under my direction in compliance with the "Corner Recordation Act" (70-22-101, et seq., MCA)

Dale A. Graff
Signature of Surveyor & Seal

Date: 01/18/18 Lic. No. 28180LS

Employer: U.S. Forest Service

2603845

Page: 1 of 2 B: 5 P: 124 01/17/2018 10:03:23 AM
Charlotte Mills - Gallatin County, MT CORREC Fee: \$0.00



_____ This "corner

_____, in Book No. _____

County Official

Sec. 7

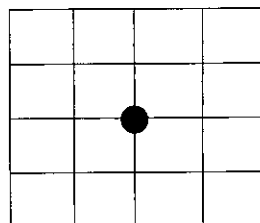

• — Corner this sheet

Cross Index No. G-3 T. 1N R. 7E, PMM



INSTRUCTIONS

1. Original and/or subsequent record used to evaluate the corner position.
2. Description of evidence found, note discrepancies in the record, state method of establishing lost or obliterated corners.
3. Description of monument and accessories set to perpetuate the corner position.
4. Sketch of corner, show all pertinent data which can best be shown in a sketch example, corner marking, topography ties, position of accessories, etc.
5. Certification must be signed and sealed by Land Surveyor licensed in the State of Montana.
6. Fill in Cross Index & Section Diagram at bottom of sheet.

PLSS CORNER RECORD

Corner C 1/4 of Section 7 T. 1 N. R. 7 E. P.M.M. Gallatin County

1. No previous record of monumentation.
2. Oct. 18, 2017: No evidence of monumentation found on the ground.
3. Aug. 7, 2017: At intersection, point falls on the edge of a pine stump where it is impractical to establish a permanent monument.

Witness Corner bears S. 20°29'13" W., 5.56 ft. dist., set 2½ ins. diam. by 18 ins. long aluminum rod, 14 ins. in the ground in a collar of stones, 20 ins. diam., with a ¾ ins. diam. aluminum cap marked as shown below;

Set a red angle iron post with "Land Survey Marker" and "Property Boundary" decals on north side of the monument.

Placed "Land Survey Monument" sign on nearby tree.

Corner is located on near level ground among second growth pine.

NAD83(2011) position determined with Survey Grade RTK GPS:
 Latitude: 45°50'00.251" N.
 Longitude: 110°54'06.548" W.

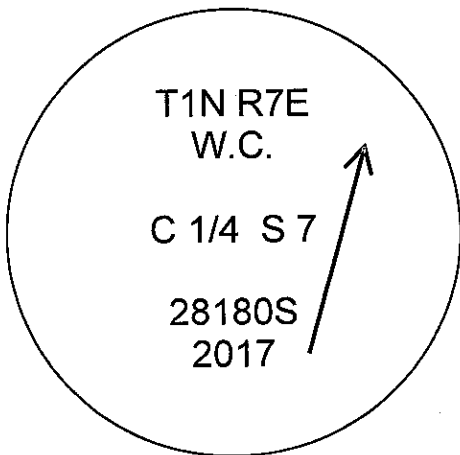
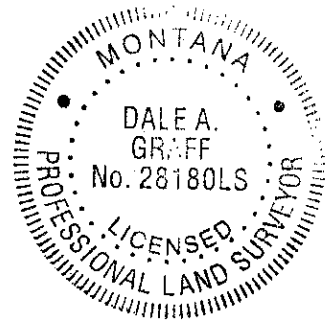

SKETCH OF CORNER

CERTIFICATION

I, _____
 certify the information shown herein is true and correct.

Signature of Ground Party Chief

I, DALE A. GRAFF
 certify that this Corner Record correctly represents work performed by me or under my direction in compliance with the "Corner Recordation Act" (70-22-101, et seq., MCA)

Dale A. Graff
 Signature of Surveyor & Seal

Date: 01/18/18 Lic. No. 28180LS

Employer: U.S. Forest Service

2603845

Page: 1 of 2 B: 5 P: 124 01/17/2018 10:03:23 AM
 Charlotte Mills - Gallatin County, MT CORREC Fee: \$0.00



_____. This "corner"

 _____, in Book No. _____

County Official

Sec. 7

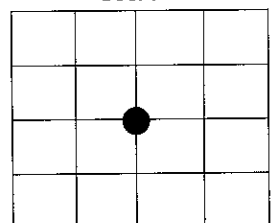

● — Corner this sheet

Cross Index No. G-3 T. 1N R. 7E, PMM



INSTRUCTIONS

1. Original and/or subsequent record used to evaluate the corner position.
2. Description of evidence found, note discrepancies in the record, state method of establishing lost or obliterated corners.
3. Description of monument and accessories set to perpetuate the corner position.
4. Sketch of corner, show all pertinent data which can best be shown in a sketch example, corner marking, topography ties, position of accessories, etc.
5. Certification must be signed and sealed by Land Surveyor licensed in the State of Montana.
6. Fill in Cross Index & Section Diagram at bottom of sheet.

PLSS CORNER RECORD

Corner C-N-SE 1/64 of Section 7 T. 1 N. , R. 7 E. P.M.M. Gallatin County

1. No previous record of monumentation.
2. Sept. 25, 2017: No evidence of monumentation found on the ground.
3. At mid-point, set 1 in. diam. by 24 ins. long aluminum rod, flush with the ground with a 3¼ ins. diam. aluminum cap marked as shown below;

Set red angle iron post with "Land Survey Marker" and "Property Boundary" decals alongside the monument.

Placed "Land Survey Monument" sign on nearby tree.

Corner is located on steep East facing slope in moderate pine, fir, and brush. An east-west line has been cleared and posted through this corner.

NAD83(2011) position determined with Survey Grade RTK GPS:
Latitude: 45°51'00.288" N.
Longitude: 110°53'50.053" W.

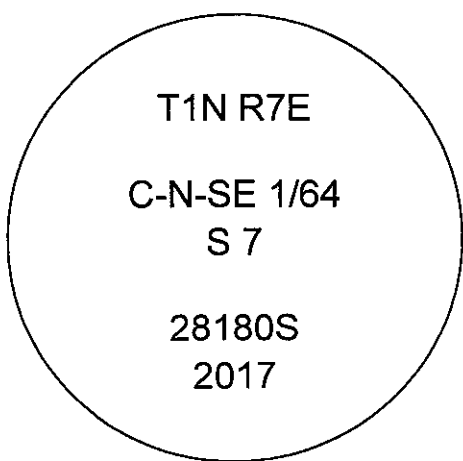
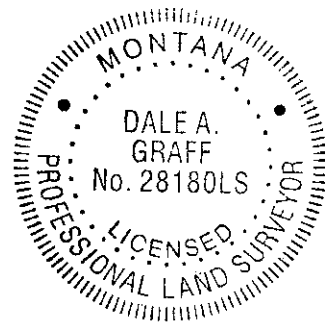

SKETCH OF CORNER

CERTIFICATION

I, _____, certify the information shown herein is true and correct.

Signature of Ground Party Chief

I, DALE A. GRAFF, certify that this Corner Record correctly represents work performed by me or under my direction in compliance with the "Corner Recordation Act" (70-22-101, et seq., MCA)

[Signature]
Signature of Surveyor & Seal

Date: 01/18/18 Lic. No. 28180LS

Employer: U.S. Forest Service

Sec. 7

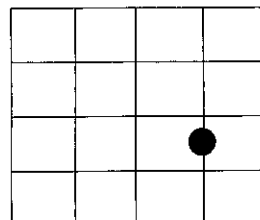

• -- Corner this sheet

2603846

Page: 1 of 2 B: 5 P: 125 01/17/2018 10:03:23 AM
Charlotte Mills - Gallatin County, MT CORREC Fee: \$0.00



_____. This "corner

_____, in Book No. _____

County Official

Cross Index No. G-H, 4 T. 1N R. 7E, PMM



INSTRUCTIONS

1. Original and/or subsequent record used to evaluate the corner position.
2. Description of evidence found, note discrepancies in the record, state method of establishing lost or obliterated corners.
3. Description of monument and accessories set to perpetuate the corner position.
4. Sketch of corner, show all pertinent data which can best be shown in a sketch example, corner marking, topography ties, position of accessories, etc.
5. Certification must be signed and sealed by Land Surveyor licensed in the State of Montana.
6. Fill in Cross Index & Section Diagram at bottom of sheet.

PLSS CORNER RECORD

Corner C-N-SE 1/64 of Section 7 T. 1 N. , R. 7 E. P.M.M. Gallatin County

1. No previous record of monumentation.
2. Sept. 25, 2017: No evidence of monumentation found on the ground.
3. At mid-point, set 1 in. diam. by 24 ins. long aluminum rod, flush with the ground with a 3¼ ins. diam. aluminum cap marked as shown below;

Set red angle iron post with "Land Survey Marker" and "Property Boundary" decals alongside the monument.

Placed "Land Survey Monument" sign on nearby tree.

Corner is located on steep East facing slope in moderate pine, fir, and brush. An east-west line has been cleared and posted through this corner.

NAD83(2011) position determined with Survey Grade RTK GPS:
Latitude: 45°51'00.288" N.
Longitude: 110°53'50.053" W.

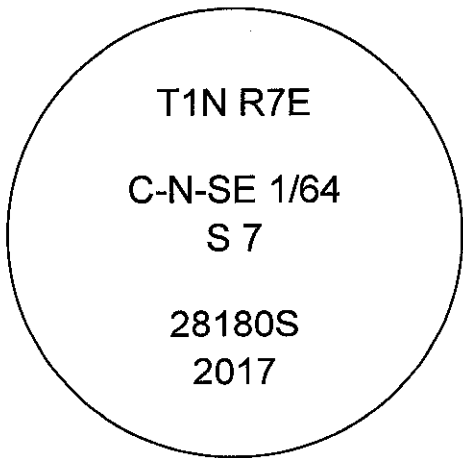
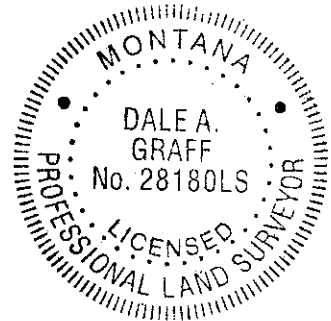

SKETCH OF CORNER

CERTIFICATION

I, _____, certify the information shown herein is true and correct.

Signature of Ground Party Chief

I, **DALE A. GRAFF**, certify that this Corner Record correctly represents work performed by me or under my direction in compliance with the "Corner Recordation Act" (70-22-101, et seq., MCA)

[Signature]
Signature of Surveyor & Seal

Date: 01/18/18 Lic. No. 28180LS

Employer: U.S. Forest Service

Sec. 7

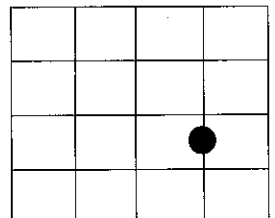

• — Corner this sheet

2603846

Page: 1 of 2 B: 5 P: 125 01/17/2018 10:03:23 AM
Charlotte Mills - Gallatin County, MT CORREC Fee: \$0.00



_____ This "corner

_____, in Book No. _____

County Official

Cross Index No. G-H, 4 T. 1N R. 7E, PMM

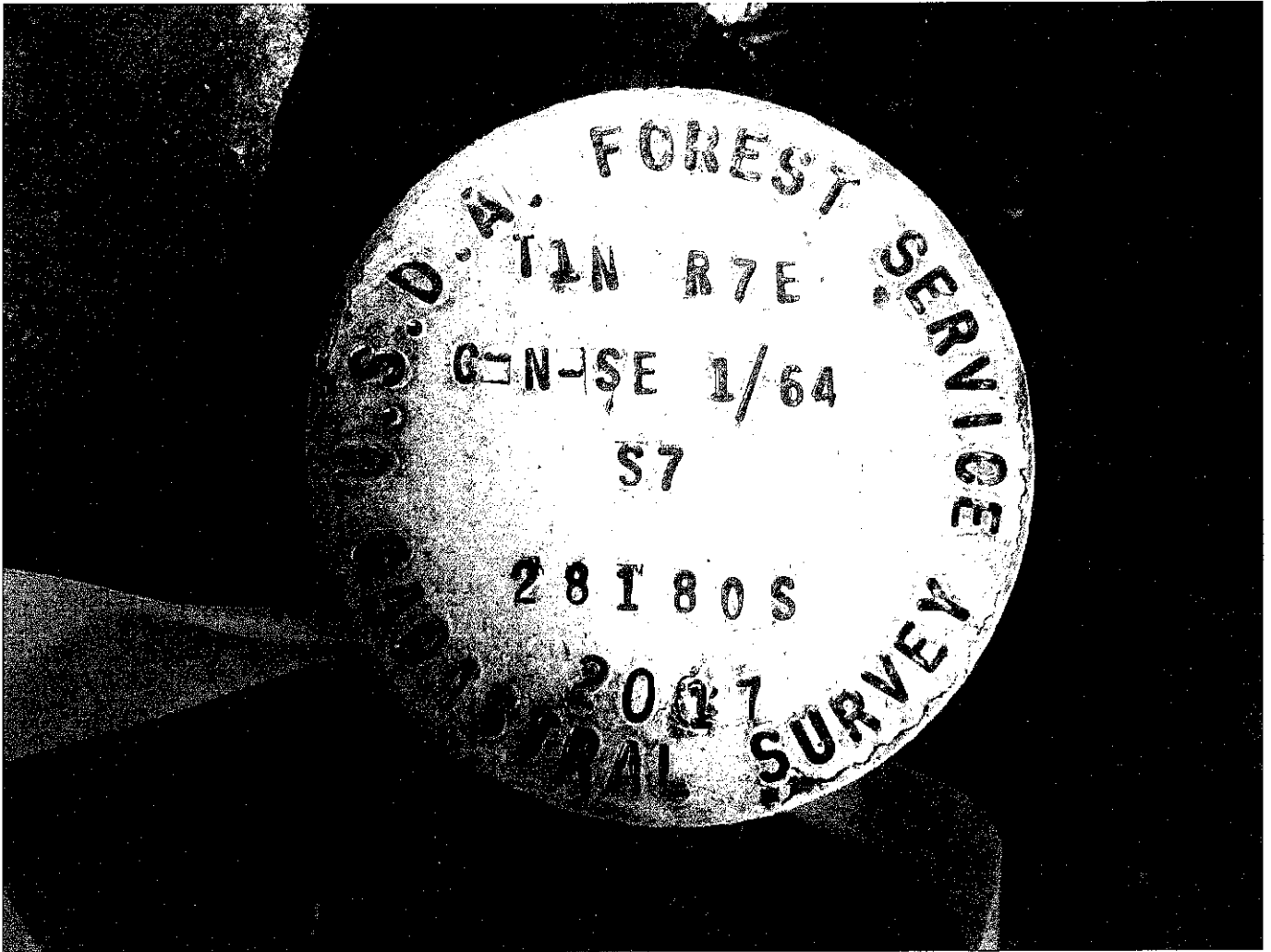

INSTRUCTIONS

1. Original and/or subsequent record used to evaluate the corner position.
2. Description of evidence found, note discrepancies in the record, state method of establishing lost or obliterated corners.
3. Description of monument and accessories set to perpetuate the corner position.
4. Sketch of corner, show all pertinent data which can best be shown in a sketch example, corner marking, topography ties, position of accessories, etc.
5. Certification must be signed and sealed by Land Surveyor licensed in the State of Montana.
6. Fill in Cross Index & Section Diagram at bottom of sheet.

PLSS CORNER RECORD

Corner C-N-SW 1/64 of Section 7 T. 1 N., R. 7 E. P.M.M. Gallatin County

1. No previous record of monumentation.
2. Aug. 23, 2017: No evidence of monumentation found on the ground.
3. At mid-point, set 1 in. diam. by 24 ins. long aluminum rod, 21 ins. in the ground, with a 3¼ ins. diam. aluminum cap marked as shown below;

Set red angle iron post with "Land Survey Marker" and "Property Boundary" 1 ft. east of corner monument.

Placed "Land Survey Monument" sign on nearby tree.

Corner is located on the East side of an old logging road and 10 ft. East of a N-S hiking trail in an open, flat area. An east-west line has been cleared and posted through this corner.

NAD83(2011) position determined with Survey Grade RTK GPS:
 Latitude: 45°51'00.256" N.
 Longitude: 110°54'26.958" W.

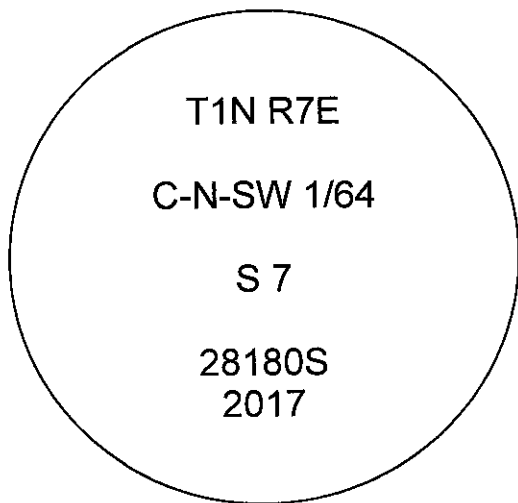
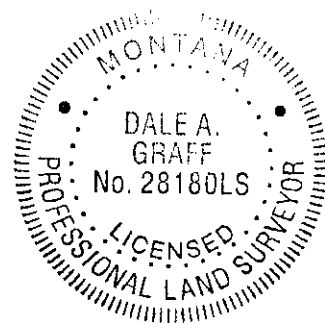

SKETCH OF CORNER

CERTIFICATION

certify the information shown herein is true and correct.

Signature of Ground Party Chief

DALE A. GRAFF

I, DALE A. GRAFF certify that this Corner Record correctly represents work performed by me or under my direction in compliance with the "Corner Recordation Act" (70-22-101, et seq., MCA)

[Signature]
 Signature of Surveyor & Seal

Date: 01/18/18 Lic. No. 28180LS

Employer: U.S. Forest Service

2603847

Page: 1 of 2 B: 5 P: 126 01/17/2018 10:03:23 AM
 Charlotte Mills - Gallatin County, MT CORREC Fee: \$0.00



_____ This "corner

_____ in Book No. _____

_____ County Official

Sec. 7

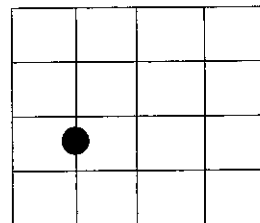

• — Corner this sheet

Cross Index No. G-H, 2 T. 1N R. 7E, PMM



INSTRUCTIONS

1. Original and/or subsequent record used to evaluate the corner position.
2. Description of evidence found, note discrepancies in the record, state method of establishing lost or obliterated corners.
3. Description of monument and accessories set to perpetuate the corner position.
4. Sketch of corner, show all pertinent data which can best be shown in a sketch example, corner marking, topography ties, position of accessories, etc.
5. Certification must be signed and sealed by Land Surveyor licensed in the State of Montana.
6. Fill in Cross Index & Section Diagram at bottom of sheet.

PLSS CORNER RECORD

Corner C-N-SW 1/64 of Section 7 T. 1 N. , R. 7 E. P.M.M. Gallatin County

1. No previous record of monumentation.
2. Aug. 23, 2017: No evidence of monumentation found on the ground.
3. At mid-point, set 1 in. diam. by 24 ins. long aluminum rod, 21 ins. in the ground, with a 3¼ ins. diam. aluminum cap marked as shown below;

Set red angle iron post with "Land Survey Marker" and "Property Boundary" 1 ft. east of corner monument.

Placed "Land Survey Monument" sign on nearby tree.

Corner is located on the East side of an old logging road and 10 ft. East of a N-S hiking trail in an open, flat area. An east-west line has been cleared and posted through this corner.

NAD83(2011) position determined with Survey Grade RTK GPS:
Latitude: 45°51'00.256" N.
Longitude: 110°54'26.958" W.

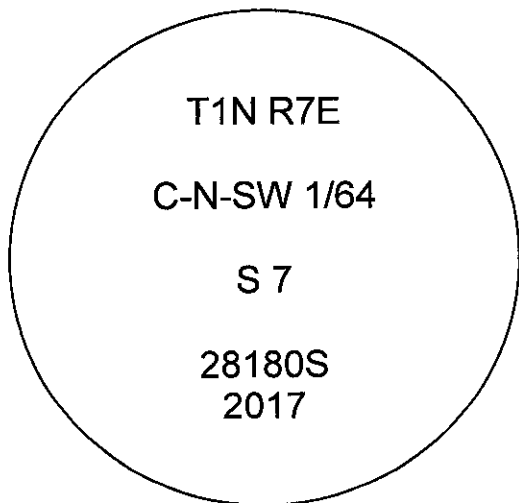
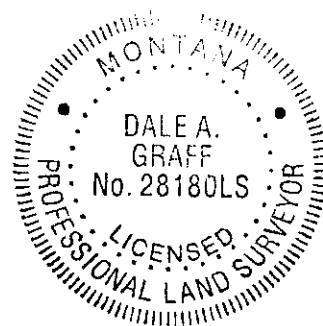

SKETCH OF CORNER

CERTIFICATION

certify the information shown herein is true and correct.

Signature of Ground Party Chief

DALE A. GRAFF

certify that this Corner Record correctly represents work performed by me or under my direction in compliance with the "Corner Recordation Act" (70-22-101, et seq., MCA)

[Handwritten Signature]

Signature of Surveyor & Seal

Date: 01/18/18

Lic. No. 28180LS

Employer: U.S. Forest Service

Sec. 7

	●	

● — Corner this sheet

2603847

Page: 1 of 2 B: 5 P: 126 01/17/2018 10:03:23 AM
Charlotte Mills - Gallatin County, MT CORREC Fee: \$0.00



County Official

Cross Index No. G-H, 2 T. 1N R. 7E, PMM



INSTRUCTIONS

1. Original and/or subsequent record used to evaluate the corner position.
2. Description of evidence found, note discrepancies in the record, state method of establishing lost or obliterated corners.
3. Description of monument and accessories set to perpetuate the corner position.
4. Sketch of corner, show all pertinent data which can best be shown in a sketch example, corner marking, topography ties, position of accessories, etc.
5. Certification must be signed and sealed by Land Surveyor licensed in the State of Montana.
6. Fill in Cross Index & Section Diagram at bottom of sheet.

PLSS CORNER RECORD

Corner N-S 1/64 of Section 7 Only T. 1 N., R. 7 E. P.M.M. Gallatin County

1. No previous record of monumentation.
2. Sept. 25, 2017: No evidence of monumentation found on the ground.
3. At true mid-point, set a 1 in. diam. by 18 ins. long aluminum rod, flush with ground, with a 3/4 ins. diam. aluminum cap marked as shown below;

Set red angle iron post with "Land Survey Marker" and "Property Boundary" decals, 1 ft. West of corner monument.

Placed "Land Survey Monument" sign on nearby tree.

Corner is located approximately 20 ft. East of old logging road, on slight easterly facing slope surrounded by deadfall. A line has been cleared and posted West from this corner.

NAD83(2011) position determined with Survey Grade RTK GPS:
 Latitude: 45°51'00.325" N.
 Longitude: 110°53'31.595" W.

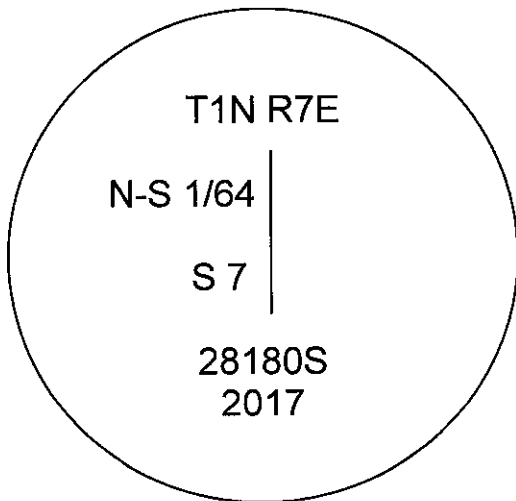
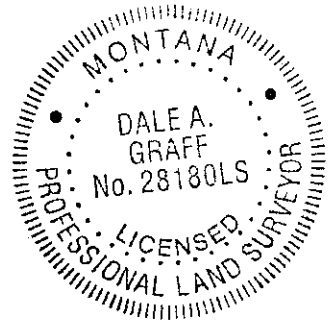

SKETCH OF CORNER

CERTIFICATION

I, _____, certify the information shown herein is true and correct.

Signature of Ground Party Chief

DALE A. GRAFF

I, _____, certify that this Corner Record correctly represents work performed by me or under my direction in compliance with the "Corner Recordation Act" (70-22-101, et seq., MCA)

Dale A. Graff
 Signature of Surveyor & Seal

Date: 01/18/18 Lic. No. 28180LS

Employer: U.S. Forest Service

2603848

Page: 1 of 2 B: 5 P: 127 01/17/2018 10:03:23 AM
 Charlotte Mills - Gallatin County, MT CORREC Fee: \$0.00



_____, This "corner

_____, in Book No. _____

 County Official

Sec. 7

● - Corner this sheet

Cross Index No. G-H, 5 T. 1N R. 7E, PMM

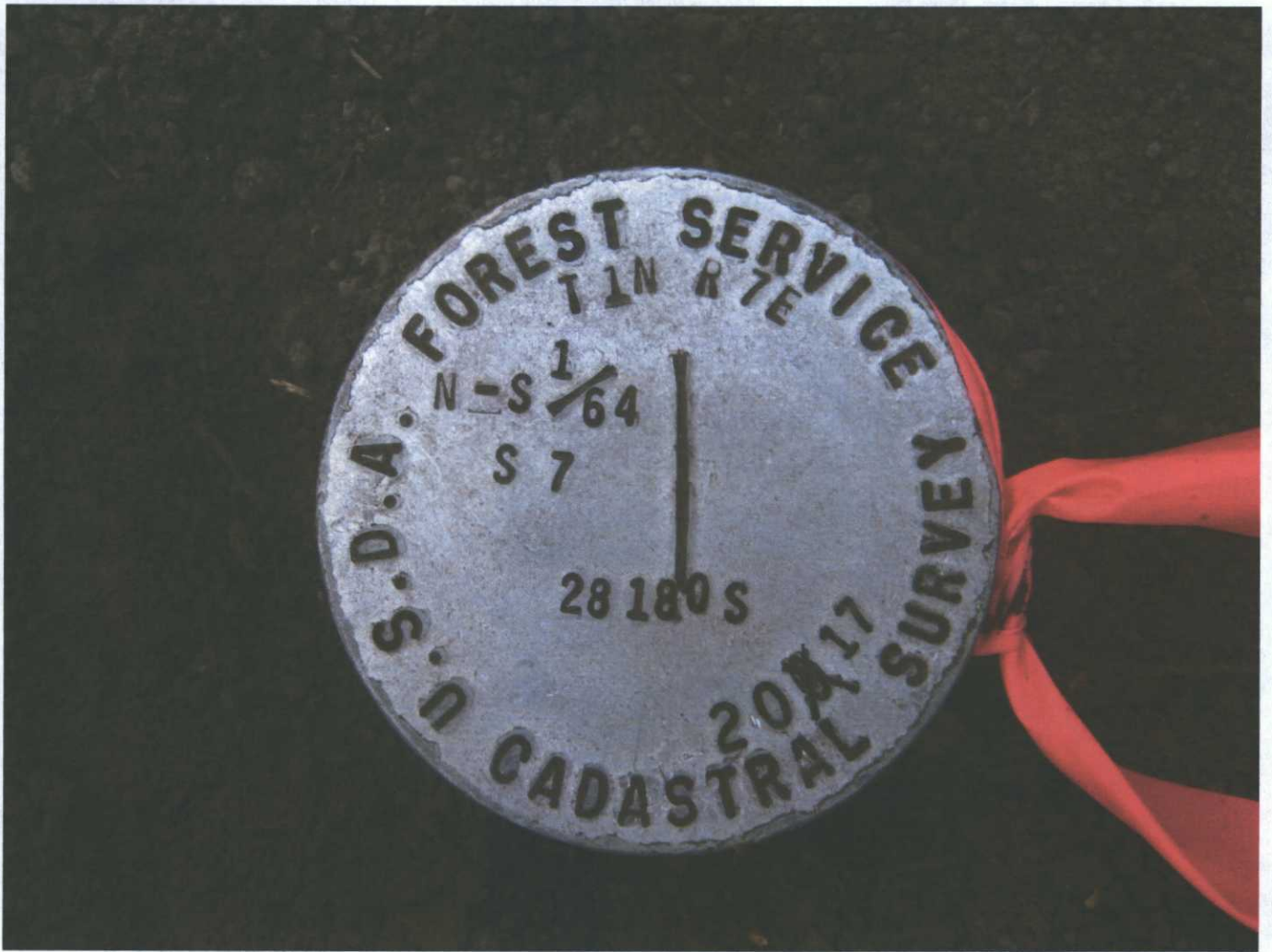

INSTRUCTIONS

1. Original and/or subsequent record used to evaluate the corner position.
2. Description of evidence found, note discrepancies in the record, state method of establishing lost or obliterated corners.
3. Description of monument and accessories set to perpetuate the corner position.
4. Sketch of corner, show all pertinent data which can best be shown in a sketch example, corner marking, topography ties, position of accessories, etc.
5. Certification must be signed and sealed by Land Surveyor licensed in the State of Montana.
6. Fill in Cross Index & Section Diagram at bottom of sheet.

PLSS CORNER RECORD

Corner N-S 1/64 of Section 7 Only T. 1 N., R. 7 E. P.M.M. Gallatin County

1. No previous record of monumentation.
2. Sept. 25, 2017: No evidence of monumentation found on the ground.
3. At true mid-point, set a 1 in. diam. by 18 ins. long aluminum rod, flush with ground, with a 3¼ ins. diam. aluminum cap marked as shown below;

Set red angle iron post with "Land Survey Marker" and "Property Boundary" decals, 1 ft. West of corner monument.

Placed "Land Survey Monument" sign on nearby tree.

Corner is located approximately 20 ft. East of old logging road, on slight easterly facing slope surrounded by deadfall. A line has been cleared and posted West from this corner.

NAD83(2011) position determined with Survey Grade RTK GPS:
 Latitude: 45°51'00.325" N.
 Longitude: 110°53'31.595" W.

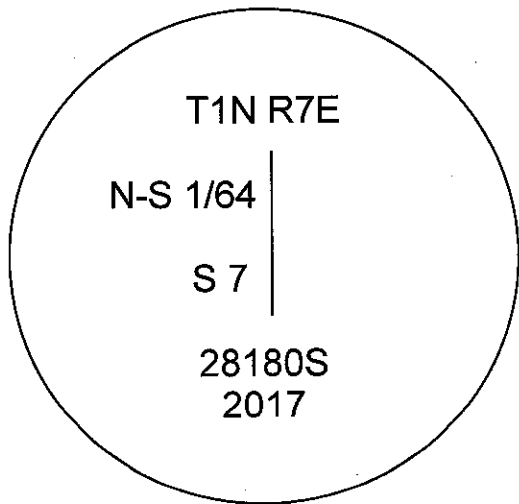
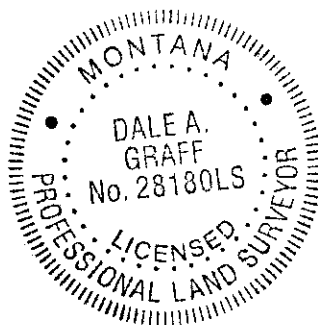

SKETCH OF CORNER

CERTIFICATION

I, _____, certify the information shown herein is true and correct.

Signature of Ground Party Chief

I, DALE A. GRAFF,

certify that this Corner Record correctly represents work performed by me or under my direction in compliance with the "Corner Recordation Act" (70-22-101, et seq., MCA)

Dale A. Graff
 Signature of Surveyor & Seal

Date: 01/18/18 Lic. No. 28180LS

Employer: U.S. Forest Service

2603848

Page: 1 of 2 B: 5 P: 127 01/17/2018 10:03:23 AM
 Charlotte Mills - Gallatin County, MT CORREC Fee: \$0.00



_____, This "corner"

_____, in Book No. _____

 County Official

Sec. 7

● — Corner this sheet

Cross Index No. G-H, 5 T. 1N R. 7E, PMM



INSTRUCTIONS

1. Original and/or subsequent record used to evaluate the corner position.
2. Description of evidence found, note discrepancies in the record, state method of establishing lost or obliterated corners.
3. Description of monument and accessories set to perpetuate the corner position.
4. Sketch of corner, show all pertinent data which can best be shown in a sketch example, corner marking, topography ties, position of accessories, etc.
5. Certification must be signed and sealed by Land Surveyor licensed in the State of Montana.
6. Fill in Cross Index & Section Diagram at bottom of sheet.

PLSS CORNER RECORD

Corner N-S 1/64 Common to Sections 7 & 12 T. 1 N., R. 7 E. P.M.M. Gallatin County

1. No previous record of monumentation.
2. Aug. 23, 2017: No evidence of monumentation found on the ground.
3. At mid-point, set a 1 in. diam. by 24 ins. long aluminum rod, 20 ins. in the ground in a collar of stones 2 ft. diam., with a 3¼ ins. diam. aluminum cap marked as shown below;

Set red angle iron post with "Land Survey Marker" and "Property Boundary" decals, 1 ft. East of corner monument.

Placed "Land Survey Monument" sign on nearby tree.

Corner is located on North facing slope in a small clearing filled with Huckleberries. A line has been cleared and posted East and North from this corner.

NAD83(2011) position determined with Survey Grade RTK GPS:
 Latitude: 45°51'00.261" N.
 Longitude: 110°54'45.367" W.

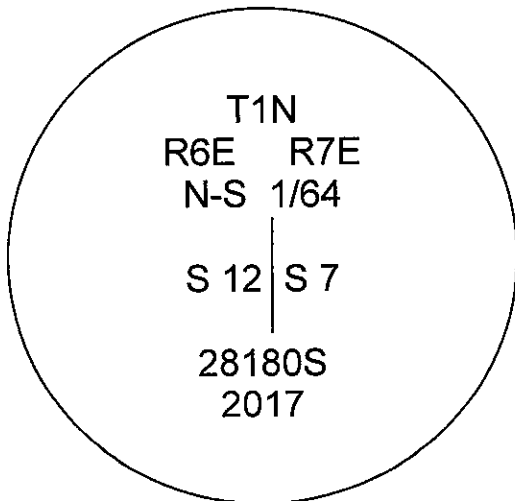
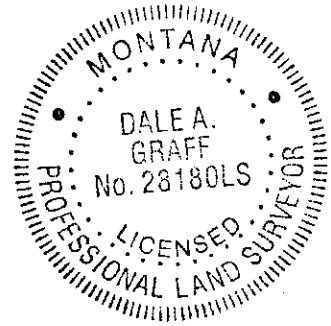

SKETCH OF CORNER

CERTIFICATION

I, _____, certify the information shown herein is true and correct.

Signature of Ground Party Chief

DALE A. GRAFF

I, _____, certify that this Corner Record correctly represents work performed by me or under my direction in compliance with the "Corner Recordation Act" (70-22-101, et seq., MCA)

DALE A. GRAFF
 Signature of Surveyor & Seal

Date: 01/18/18 Lic. No. 28180LS

Employer: U.S. Forest Service

2603849

Page: 1 of 2 B: 5 P: 128 01/17/2018 10:03:23 AM
 Charlotte Mills - Gallatin County, MT CORREC Fee: \$0.00



_____, This "corner

_____, in Book No. _____

 County Official

Sec. 7

● — Corner this sheet

Cross Index No. G-H, 1 T. 1N R. 7E, PMM



INSTRUCTIONS

1. Original and/or subsequent record used to evaluate the corner position.
2. Description of evidence found, note discrepancies in the record, state method of establishing lost or obliterated corners.
3. Description of monument and accessories set to perpetuate the corner position.
4. Sketch of corner, show all pertinent data which can best be shown in a sketch example, corner marking, topography ties, position of accessories, etc.
5. Certification must be signed and sealed by Land Surveyor licensed in the State of Montana.
6. Fill in Cross Index & Section Diagram at bottom of sheet.

PLSS CORNER RECORD

Corner N-S 1/64 Common to Sections 7 & 12 T. 1 N., R. 7 E. P.M.M. Gallatin County

1. No previous record of monumentation.
2. Aug. 23, 2017: No evidence of monumentation found on the ground.
3. At mid-point, set a 1 in. diam. by 24 ins. long aluminum rod, 20 ins. in the ground in a collar of stones 2 ft. diam., with a 3¼ ins. diam. aluminum cap marked as shown below;

Set red angle iron post with "Land Survey Marker" and "Property Boundary" decals, 1 ft. East of corner monument.

Placed "Land Survey Monument" sign on nearby tree.

Corner is located on North facing slope in a small clearing filled with Huckleberries. A line has been cleared and posted East and North from this corner.

NAD83(2011) position determined with Survey Grade RTK GPS:
 Latitude: 45°51'00.261" N.
 Longitude: 110°54'45.367" W.

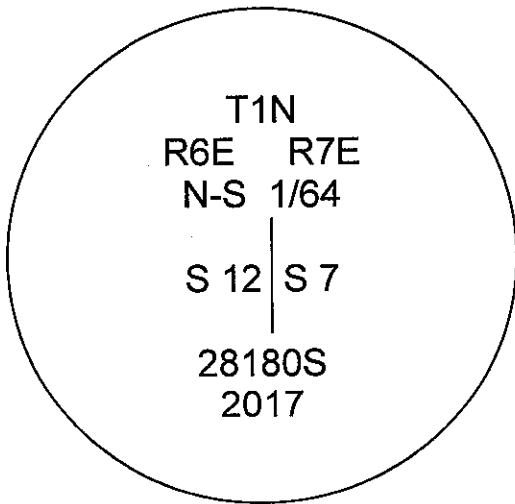
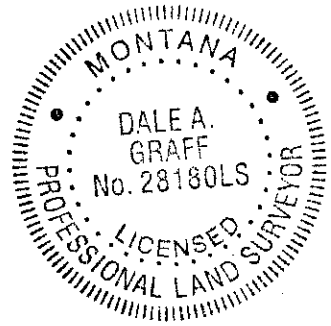

SKETCH OF CORNER

CERTIFICATION

I, _____
 certify the information shown herein is true and correct.

Signature of Ground Party Chief

DALE A. GRAFF

I, _____
 certify that this Corner Record correctly represents work performed by me or under my direction in compliance with the "Corner Recordation Act" (70-22-101, et seq., MCA)

[Signature]
 Signature of Surveyor & Seal

Date: 01/18/18 Lic. No. 28180LS

Employer: U.S. Forest Service

2603849

Page: 1 of 2 B: 5 P: 128 01/17/2018 10:03:23 AM
 Charlotte Mills - Gallatin County, MT CORREC Fee: \$0.00

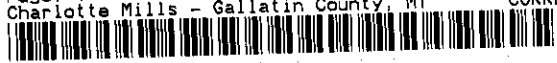

_____ This "corner"

 _____, in Book No. _____

County Official

Sec. 7

● — Corner this sheet

Cross Index No. G-H, 1 T. 1N R. 7E, PMM

