

1. Original and/or subsequent record used to evaluate the corner position.
2. Description of evidence found, note discrepancies in the record, state method of establishment, lost or obliterated corners.
3. Description of monument and accessories set to perpetuate the corner position.
4. Sketch of corner, show all pertinent data which can best be shown in a sketch example, corner marking, topography ties, position of accessories, etc.
5. Certification must be signed and sealed by Land Surveyor registered in the State of Montana.
6. Fill in Cross Index & Section Diagram at bottom of sheet.

## CERTIFIED CORNER RECORDATION

CORNER Southwest SEC. 26, T. 4 S., R. 51 E., P.M.M., Powder River COUNTY, MT

ORIGINAL RECORD: Surveyed by Geo. L. Elmer & Theodore O. Johnston Aug, 1907.

SUBSEQUENT RECORD: Dependent resurvey by Ranney Y. Lyman and Andrew Nelson in 1947.

The cor. of secs. 26, 27, 34 and 35, marked by the original monument, a sandstone, 24x12x4 ins. firmly set, properly marked and witnessed by a scattered mound of stone. At the corner point set a iron post, 3 ft. long, 2 ins. diam., 30 ins. in the ground, with brass cap marked

T4S R51E  
S27	S26
S34 | S35  
1946

Bury the old cor. stone, alongside of the iron post, and rebuild the mound of stone to 3 ft. base, 2 ft. high W. of cor. stands in fence, extending N. and S. and marking the W. boundary of cemetery.

EVIDENCE FOUND: Original BC not found, cemetery has expanded further west Found 1" iron pipe 2" below ground at the corner point.

SET: Nothing new set.

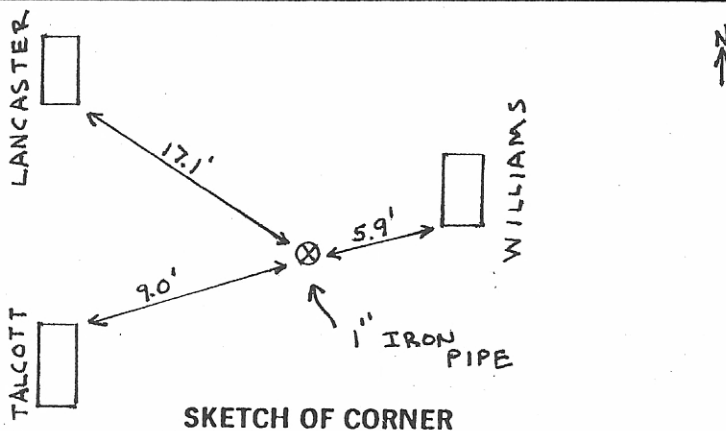

CERTIFICATION

I, Quinn W. Wright  
certify the information shown herein to be true and correct.

MONTANA  
Signature Ground Party Clerk  
JIMMIE L. BREWER

I, Jimmie L. Brewer  
certify that this Corner Record correctly represents work performed by me or under my direction in compliance with the "Corner Recordation Act" (70-22-101, et seq., M.C.A.)

MONTANA  
REGISTERED  
LAND SURVEYOR  
Signature of Land Surveyor Seal

Date: 6-9-93 Reg. No. 71582S  
Employer: HKM Associates

Office of Clerk and Recorder, County of Powder River. This "corner record" was filed for record on June 10, 1993 @ 10:08 AM was noted on the cross-index plat and is assigned page No. 118972, in book No. \_\_\_\_\_

Indexed	<input checked="" type="checkbox"/>
Compared	<input checked="" type="checkbox"/>

Cross Index No. V-17 T. 4S R. 51E P.M.M.

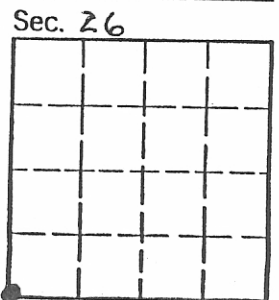

• - corner this sheet