

INSTRUCTIONS

1. Original and/or subsequent record used to evaluate the corner position.
2. Description of evidence found, note discrepancies in the record, state method of establishing lost or obliterated corners.
3. Description of monument and accessories set to perpetuate the corner position.
4. Sketch of corner, show all pertinent data which can best be shown in a sketch example, corner marking, topography ties, position of accessories, etc.
5. Certification must be signed and sealed by Land Surveyor registered in the State of Montana.
6. Fill in Cross Index & Section Diagram at bottom of sheet.

CERTIFIED CORNER RECORDATION

Corner Sections 36 & 31 T. 5 N. R. 11 & 10 W. P.M.M. Deer Lodge County

ORIGINAL RECORD: (1868 G.L.O.) Not recovered.

SUBSEQUENT RECORD: (1873 G.L.O.)

Begin at the Standard Cor to T. 5 N. R. 10 & 11 W: a Post in mound with chared stake and pits and new W. on the 1st Standard Parallel N along the South boundary of Sec 36.

SUBSEQUENT RECORD: None found.

EVIDENCE FOUND: Found 2½" Aluminum Cap, 0.0' above ground with small rock ring, from which:  
A fence post bears N0°W, 0.65 feet dist.

PERPETUATION: Left monument as found.

Date of Survey: October, 2009.



NAD 83 coordinates for this corner:  
Latitude = 46°08'10.25019"N Longitude = 112°54'44.35748"W  
NOTE: These coordinates are to be used as a search tool only.

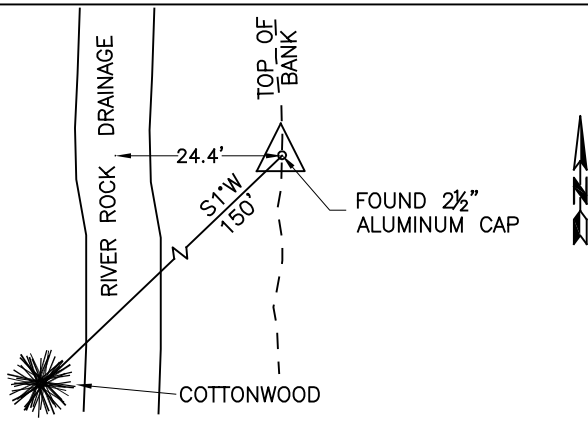

(Not to Scale)  
SKETCH OF CORNER

CERTIFICATION

I, Steve Cummings  
certify the information shown herein is true and correct.

\_\_\_\_\_  
Signature Ground Party Chief

I, Kurt A. Luebke  
certify that this Corner Record correctly represents work performed by me or under my direction in compliance with the "Corner Recordation Act" (70-22-101, et seq., M.C.A.)

\_\_\_\_\_  
Signature of Surveyor & Seal

Date: 10-27-2009 Reg. No. 13237 S

Employer: DJ&A P. C.

Sec. 36

● - corner this sheet

Cross Index No. Z-1 T. 5 N. R. 10 W. PMM  
Cross Index No. Z-25 T. 5 N. R. 11 W. PMM