

INSTRUCTIONS

1. Original and/or subsequent record used to evaluate the corner position.
2. Description of evidence found, note discrepancies in the record, state method of establishing lost or obliterated corners.
3. Description of monument and accessories set to perpetuate the corner position.
4. Sketch of corner, show all pertinent data which can best be shown in a sketch example, corner marking, topography ties, position of accessories, etc.
5. Certification must be signed and sealed by Land Surveyor registered in the State of Montana.
6. Fill in Cross Index & Section Diagram at bottom of sheet.

CERTIFIED CORNER RECORDATION

Corner W.C. 1/4 Cor. Secs. 2 & 3 T. 5S R. 51E P.M.M. Powder River County

1885 Record

We did not have a copy of the original 1885 G.L.O. survey notes of the subdivisions of T5S, R51E by George Scheetz.

1939 Record

1939 G.L.O. resurvey & remonumentation of T5S, R51E by Ranney Y. Lyman.

- 42.56 Set an iron post, 3 ft. long, 1 in. diam., 28 ins. in the ground, for witness cor. to the 1/4 sec. cor., with brass cap marked....
- ...and raise a mound of stone, 2 ft. base, 1 1/2 ft. high W. of cor.

1992 Found

Found iron post with brass cap as described in 1939 G.L.O. notes and marked as shown below. Post is now 33 ins. in the ground, and no evidence of a mound of stone. 1939 notes show unsafe to set actual 1/4 cor., as it would be along bank of the Powder River. Found steel fence post, 1.0 ft. N.W. of post, 3.0 ft., out of the ground, and put decal on it.

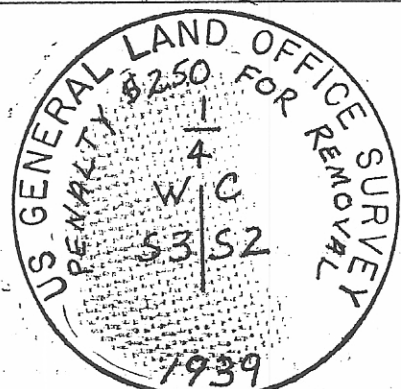
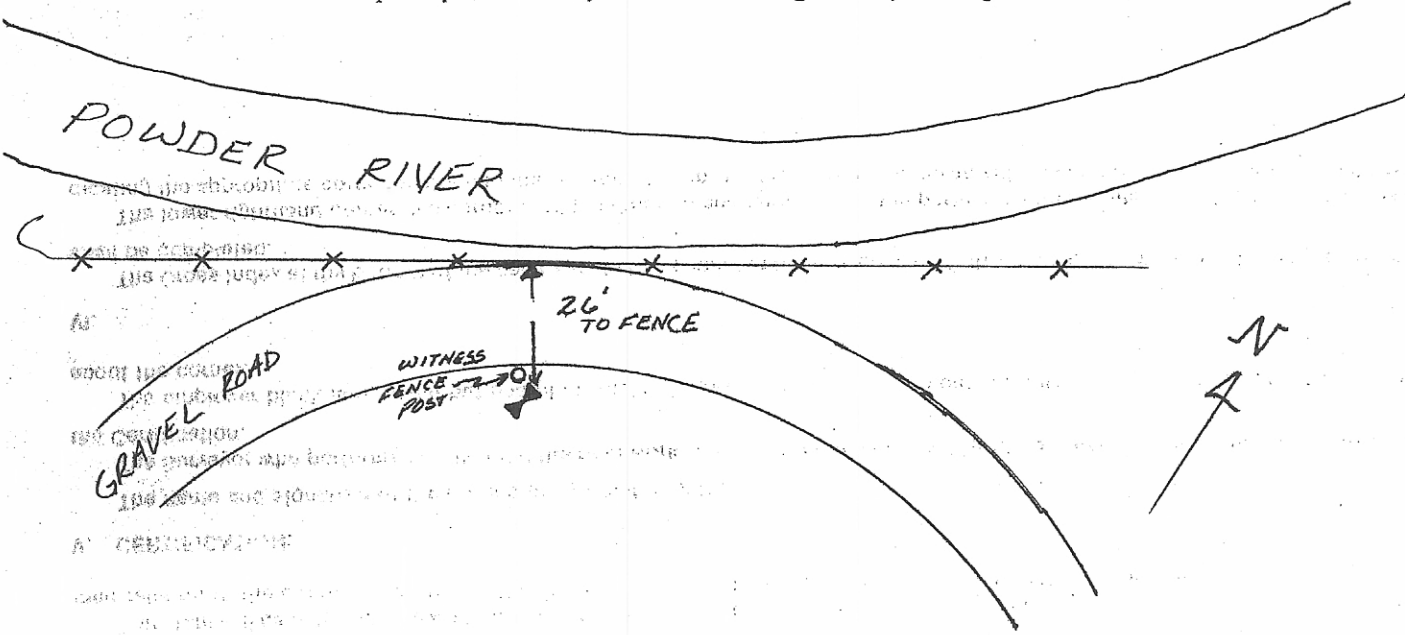

SKETCH OF CORNER

CERTIFICATION

I, Douglas J. Martin
 certify the information shown herein is true and correct.

Douglas J. Martin
 Signature of Ground Party Chief

I, David R. Davis
 certify that this Corner Record correctly represents work performed by me or under my direction in accordance with the "Corner Recordation Act" (79-22-101, et seq., M.C.A.)

David R. Davis
 Signature of Surveyor & Seal

Date: 10/92 Reg. No. 23702

Employer: MDP

Office of Clerk and Recorder, County of Powder River. This "corner record" was filed for record on November 2, 1992 @ 10:22 AM was noted on the cross-index plat and is assigned page No. 118587, in book No. _____

Carole R. Considine, Deputy
 County Official

Indexed	<input checked="" type="checkbox"/>
Compared	<input checked="" type="checkbox"/>

Cross Index No. W.C. - 017 T. 5S R. 51E P.M.M.

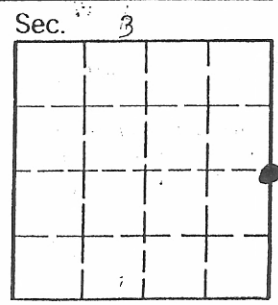

• - corner this sheet