

109204

CERTIFIED LAND CORNER RECORDATION

DESCRIPTION OF CORNER EVIDENCE FOUND, AND ORIGINAL RECORD (IF KNOWN)

Found: Brown set stone 10" x 7" x 7" out of ground, 4 marks on East face, 2 marks on West at the Southeast corner of Section 32, T6N, R9W, MPM. Old fence runs North, South, East, & West. New fence runs East and West.

Record: Post in mound of earth with pits and charred stake.

Found: Set stone 6 x 12 x 6 out of ground, 1/4 marked on West face, steel fence post on East at the East 1/4 corner of Section 32, T6N, R9W, MPM. Stone is 20 feet East of a South and West fence corner and approximately 50' West of gully on a steep side hill.

Record: Set limestone 12" x 10" x 6" with pits and marked stone.

DESCRIPTION OF MONUMENT AND ACCESSORIES ESTABLISHED TO PERPETUATE THE ORIGINAL LOCATION OF THIS CORNER:

Date of work: March, 1977

SKETCH, WITH COURSE AND DISTANCE TO ADJACENT CORNERS IF DETERMINED IN THIS SURVEY. (MAY SKETCH OR PASTE REPRODUCTION ON REVERSE SIDE.)

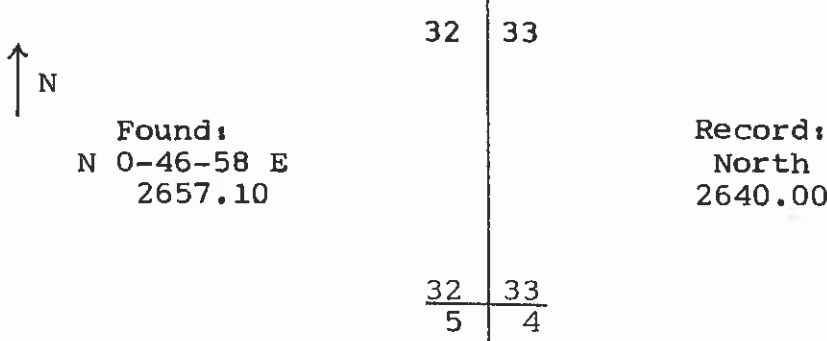

Surveyor's Seal

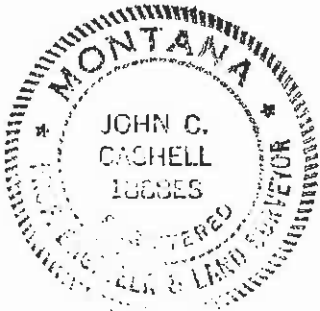

I, George W. Baxter certify that the information shown herein is true and correct.

Signature of Ground Party Chief

I, John C. Cashell certify that I have carefully performed or reviewed the work done on the diagrammed corner as reported on this recordation form and approve the same.

Signature of Surveyor

DIAGRAM OF CORNER:

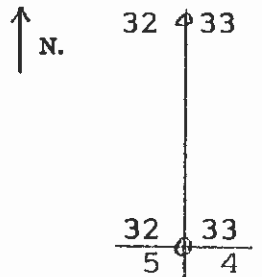

0 = Corner recorded on the sheet

1888 ES Registration Number

Office of Clerk and Recorder, County of Deer Lodge

This "corner record" was filed for record on the 13th day of June 1977, was noted on the cross-index plat and is assigned page No. 169, in book No. 1

Mary Char Roberts County Official