

CERTIFIED LAND CORNER RECORDATION

DESCRIPTION OF CORNER EVIDENCE FOUND, AND ORIGINAL RECORD (IF KNOWN)

1. Meander Corner on North side of Echo Lake on line between Sections 31 & 32
T6N R13W
 Record: A limestone 18x14x5 in. 10 in. in the ground - BTs -N46°E 34 lks.
 S 74°W 19 lks.
 Found: No evidence acceptable.
2. Meander Corner on South side of Echo Lake on line between Section 31 & 32
T6N R13W
 Record: Limestone 18x10x8 in. 12 in. in the ground BTs S28°E 112 lks.,
 S45°W 150 lks.
 Found: BTs as described in record and another BT marked and tagged in 1932.
3. Corner of Sections 31 & 32 T6N, and 5 & 6 T5N, R13W
 Record: Set 30 in. long 2½ in. diameter iron post with brass cap -1967 surve
 4 BTs
 Found: Corner as shown in record.

DESCRIPTION OF MONUMENT AND ACCESSORIES ESTABLISHED TO PERPETUATE THE ORIGINAL LOCATION OF THIS CORNER:

- 1 & 2 Date of work: Nov. 1979
 Set 30"x2" galvanized pipes with brass caps marked with corner information, date, & 1888ES. Set a red fiberglass post with attention sign alongside monuments.
1. BTs: 12" pine N32°E 19.5 ft.; 10" pine N75°30'E 9.9 ft.; 7" pine S27°30'W 18.0 ft.
 2. BTs: 18" pine (1932 location tag on it) S2°E 4.3 ft.; 13" pine (original) S31.5°W 73.9 ft.; 18" fir (original) S48°W 99 ft.
 3. BTs: 5" pine S56°15'W 7.9 ft.; 14" fir N34°15'W 9.2 ft.; 7" pine N38°E 16.5 ft.; S44°30'E 33 ft.

See Certificate of Survey #112

SKETCH, WITH COURSE AND DISTANCE TO ADJACENT CORNERS IF DETERMINED IN THIS SURVEY.
(MAY SKETCH OR PASTE REPRODUCTION ON REVERSE SIDE.)

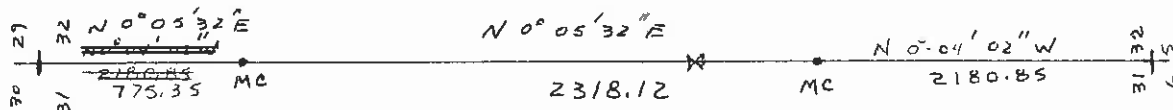

See Certificate of Survey #112

DIAGRAM OF CORNER:

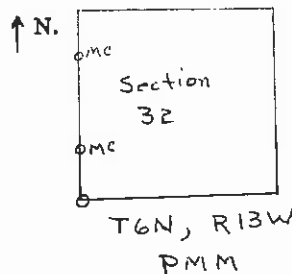

o = Corner recorded on the sheet

Surveyor's Seal

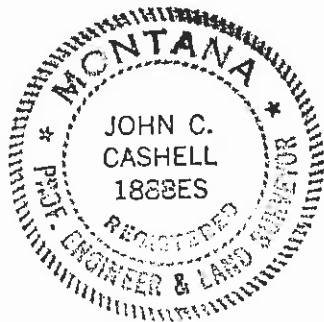

I, David M. Albert
 certify that the information shown herein is true and correct.

David M. Albert
 Signature of Ground Party Chief

I, John C. Cashell
 certify that I have carefully performed or reviewed the work done on the diagrammed corner as reported on this recordation form and approve the same.

John C. Cashell
 Signature of Surveyor

1888ES
 Registration Number

Office of Clerk and Recorder, County of Granite
 This "corner record" was filed for record on the 9th day of July, 1980, was noted on the cross-index plat and assigned page No., in book No.
W. J. Sauer, Deputy
 County Official

Cross Index No. 2-5 T. 6 R. 13 Me: