

- INSTRUCTIONS
1. Original and subsequent record used to evaluate the corner position.
 2. Description of monument found, note discrepancies in the record, state method of marking lost or obliterated corners.
 3. Description of monument and accessories set to perpetuate the corner position.
 4. Sketch of corner, show all pertinent data which can best be shown in a sketch example, corner marking, topography ties, position of accessories, etc.
 5. Certification must be signed and sealed by Land Surveyor registered in the State of Montana.
 6. Fill in Cross Index & Section Diagram at bottom of sheet.

70771

CERTIFIED CORNER RECORDATION

Corner 1/4 COR S.3 | S.2 T. 6N R. 19E P.M.M. GOLDEN VALLEY County

139-1990

RECORDATION 1/4 3/2 T. 6N R. 19E.

1877 Walter W. DeLoey & Germaine A. Kellogg, GLO Deputy Surveyors, "Deposited a sandstone 6" x 4" x 3" marked with a x, 12 in. in the ground for qtr. Sec. corner. Dug pits 18 in. sq. 12 in. deep N.S.E & W. of corner, sift distant & raised a mound of earth 2 ft. high 4 1/2 ft. base."

1972 Jack Hendrickson (RLS 2914-S) re-established corner from Montana Power Co. Drawing # 17443-C Sheet 3 of 4, dated 11-21-36, which made tie to corner when stone was in place. Re-monumented w/ 1" iron pipe. See 1972 Corner Recordation.

1990 mm/CSSA Found 1" iron pipe, as described per 1972 Corner Recordation. At corner point set 2 1/2" x 30" Alum post w/ 3" Alum cap. mtd as shown right, flush with ground, and bury 1" Iron Pipe alongside. Set MARKS Tag on Corner Fence post 6' North.

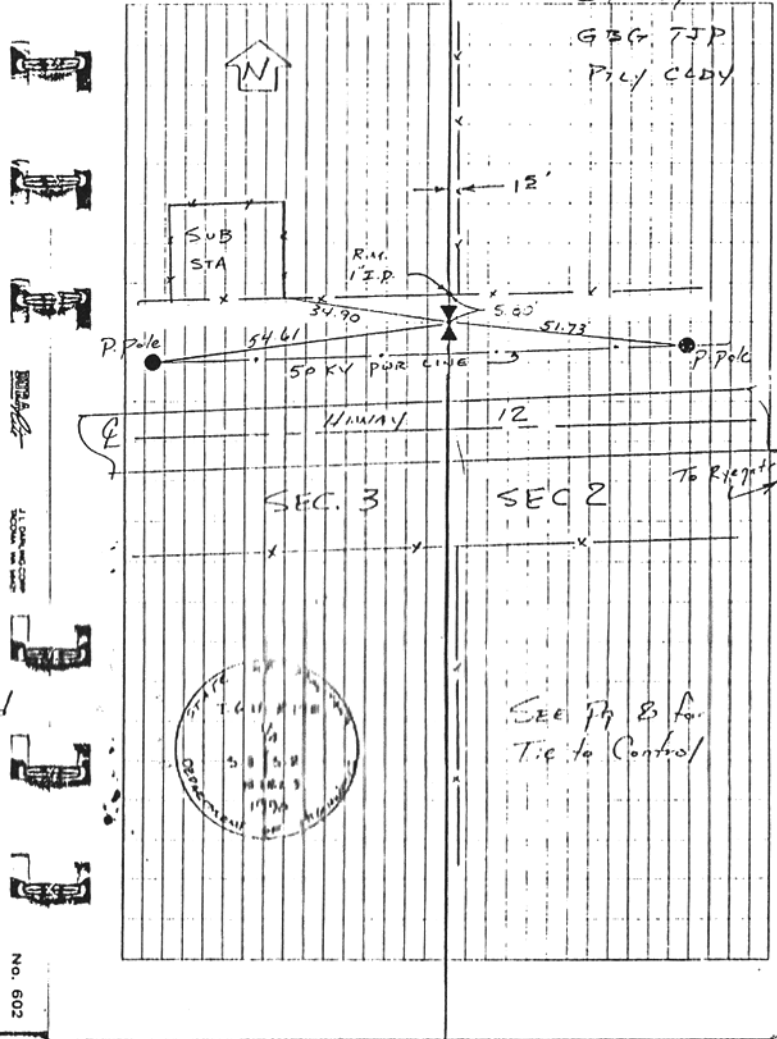

No. 602

MONTANA

I, Gunnar G. Palkick certify the information above is true and correct.

Gunnar G. Palkick
Signature of Land Party Owner

I, Gerald A. Pauluk certify that this Corner Record correctly represents work performed by me or under my direction in compliance with the "Corner Recordation Act" (70-22-101, et seq., M.C.A.)

Gerald A. Pauluk
Signature of Surveyor & Seal

Date: 6-27-90 Reg. No. 93382-S

Employer: MORRISON MAPLE/CSSA

SKETCH OF CORNER

Office of Clerk and Recorder, County of Golden Valley. This "corner record" was filed for record on July 2, 1990 was noted on the cross-index plat and is assigned page No. 139, in book No. 2

Cileen Mattheis by
Kathleen County Official Act. deputy

Cross Index No. C-17 T. 6N R. 19E P.M.M.

Fees: Gratis

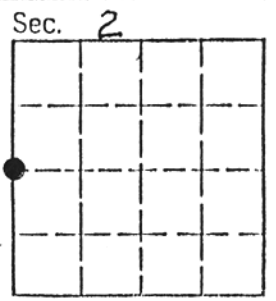

• - corner this sheet