

2. Description of monument found, note discrepancies in the record, state method of establishing lost or obliterated corners.
3. Description of monument and accessories set to perpetuate the corner position.
4. Sketch of corner, show all pertinent data which can best be shown in a sketch example, corner marking, topography, etc., position of accessories, etc.
5. Certification must be signed and sealed by Land Surveyor registered in the State of Montana.
6. Fill in Cross Index & Section Diagram at bottom of sheet.

70772

CERTIFIED CORNER RECORDATION

Corner 1/4 COR S. 6 | S. 5 T. 6N. R. 20E. P.M.M. GOLDEN VALLEY County

140-1990

RECORDATION 1/4 S 6 | S 5 T. 6N. R. 20E

1877 Walter W. DeLory and Germaine A. Kellogg, G.L.O. Deputy Surveyors, 'Set a sandstone 20x10x5 in. 15 in. the ground for Ctr. Sec. Corner, marked with 1/4 on West face. Dug pits 18 ins. sq. 12 in. deep N.S.E. & W. of Corner, 5 1/2 ft. distant.

1990 mm/CSSA re-establish corner from the 1911 First Addition to Ryegate Plots, which shows a tie from the NW corner of original Townsite to a found stone. AT record bearing & distance from found 2" Iron Pipe @ NW Townsite Corner: Set 5/8" x 30" Rebar with 2" MOON Alum cap marked as shown right, 3" below surface. Corner falls in swingset area of school playground.

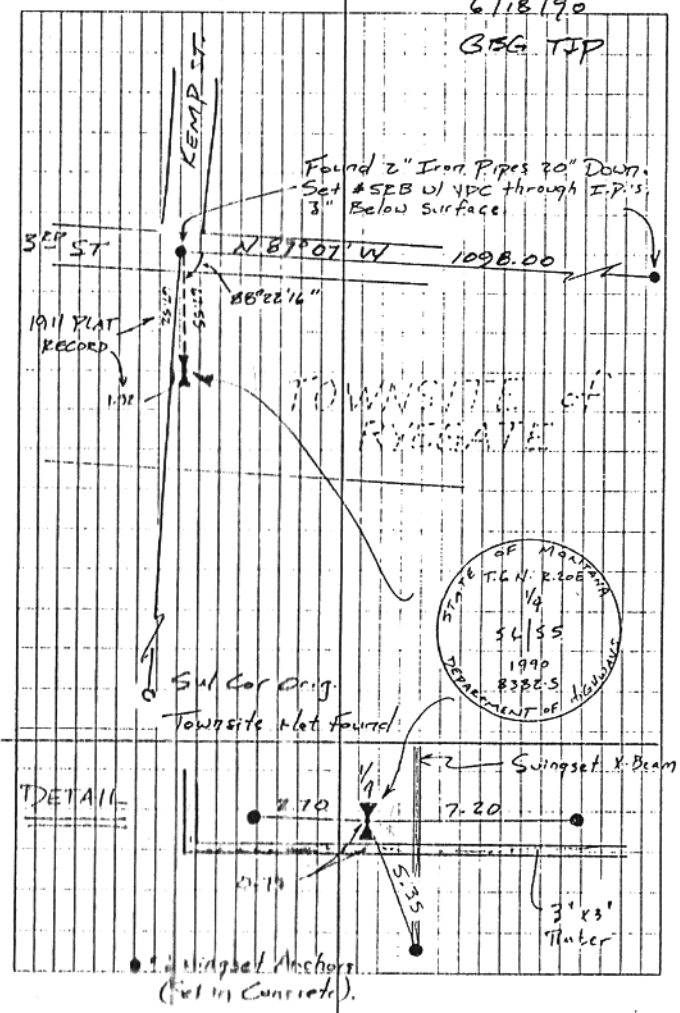

CERTIFICATION

I, Gunnar Gatch certify the information shown here is true and correct.

Gunnar Gatch
 Signature of Recorder
 8382 S

I, GERALD A. PAVLICK REGISTERED SURVEYOR certify that this Corner Record correctly and lawfully was performed by me or under my direction in compliance with the "Corner Recordation Act" (70-22-101, et seq., M.C.A.)

Gerald A. Pavlick
 Signature of Surveyor & Seal

Date: 6-27-90 Reg. No. 8382-S

Employer: MORRISON MAERLE/CSSA

SKETCH OF CORNER

Office of Clerk and Recorder, County of Golden Valley. This "corner record" was filed for record on July 2, 1990

was noted on the cross-index plat and is assigned page No. 140, in book No. 2 @ 11⁰⁵ AM.

70772

Lileen Mattheis
 County Official
Kathleen O.H. Deputy

Cross Index No. C-5 T. 6N. R. 20E. P.M.M.

Fees: Gratis

