

CERTIFIED LAND CORNER RECORDATION

DESCRIPTION OF CORNER EVIDENCE FOUND, AND ORIGINAL RECORD (IF KNOWN)

ORIGINAL- A SANDSTONE 16"x13"x9", 11" IN THE GROUND. 1/4 MARKED ON N. FACE
DUG PITS 18x18x12 INS E & W OF STONE 5 1/2' DIST. AND RAISED A MOUND
1 1/2' HIGH 3 1/2' BASE ALONGSIDE. NOT FOUND.

FOUND- 4" CONCRETE R/W MONUMENT SET BY HIGHWAY DEPT. FOR N 1/4 COR. SEC. 11.

DESCRIPTION OF MONUMENT AND ACCESSORIES ESTABLISHED TO PERPETUATE THE ORIGINAL LOCATION OF THIS CORNER:

Date of work: NOVEMBER, 1973

DES TO PERPETUATE LOCATION OF 4" CONG. R/W MONUMENT

- 1. A SQUARE HEAD STEEL BOLT FLUSH WITH THE GROUND BEARS WEST, 1.25'.
2. A STANDARD 4" CONG. R/W MON BEARS WEST 608.1'.

SKETCH, WITH COURSE AND DISTANCE TO ADJACENT CORNERS IF DETERMINED IN THIS SURVEY. (MAY SKETCH OR PASTE REPRODUCTION ON REVERSE SIDE.)

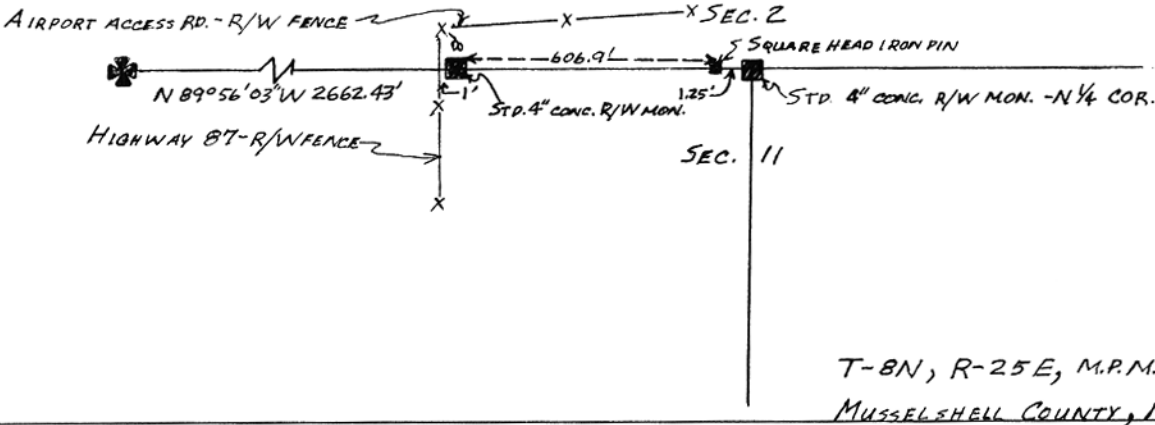

Surveyor's Seal

I, DAVID H. BICK certify that the information shown herein is true and correct. David H. Bick Signature of Ground Party Chief

DIAGRAM OF CORNER:

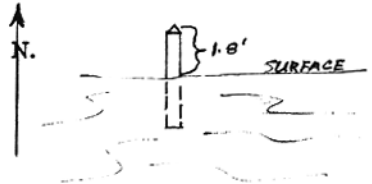

I, Elmer E. Truff certify that I have carefully performed or reviewed the work done on the diagrammed corner as reported on this recordation form and approve the same. Elmer E. Truff Signature of Surveyor

= Corner recorded on the sheet

25255 Registration Number

Office of Clerk and Recorder, County of Musselshell

This "corner record" was filed for record on the 26 day of March 1975, 9:18 am, was noted on the cross-index plat and is assigned page No. in book No. Frances L. Dawson County Official