

INSTRUCTIONS

1. Original and/or subsequent record used to evaluate the corner position.
2. Description of evidence found, note discrepancies in the record, state method of establishing lost or obliterated corners.
3. Description of monument and accessories set to perpetuate the corner position.
4. Sketch of corner, show all pertinent data which can best be shown in a sketch example, corner marking, topography ties, position of accessories, etc.
5. Certification must be signed and sealed by Land Surveyor registered in the State of Montana.
6. Fill in Cross Index & Section Diagram at bottom of sheet.

CERTIFIED CORNER RECORDATION

Corner Sections 25, 30, 31 & 36 T. 9N R. 9 & 10W P.M.M. Powell County

ORIGINAL RECORD: (1868 G.L.O.) Set cor to sec 25-36-30-31 with a post in mound of earth with pits charred stake as per instructions.

SUBSEQUENT RECORD: None

EVIDENCE FOUND: Searched and found nothing.

PERPETUATION: Set 2 1/2 ins. alum. cap on 3/4 x 30 in. rebar, marked as shown, at the single proportion position along the Range line; established the following:

- A 5" Douglas fir bears North, 7.5' with a BT tag.
- A 9" Douglas fir bears N72°E, 15.0', with a BT tag.

The corner falls on an east facing 40% slope approximately 35 feet above a draw.

Date of Survey: April, 2008.

Compass Declination Used: 15°

SEE REVERSE SIDE FOR SECTIONAL DATA

NAD 83 coordinates for this corner:
 Latitude = 46°29'53.14670"N Longitude = 112°47'13.84707"W
 NOTE: These coordinates are to be used as a search tool only.

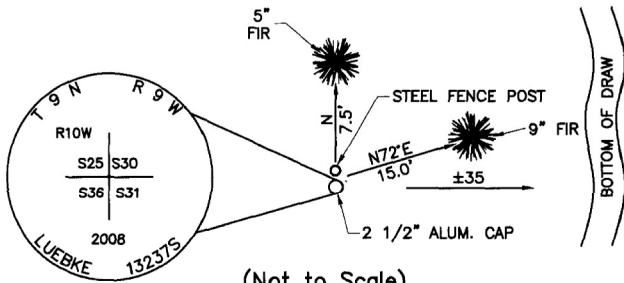
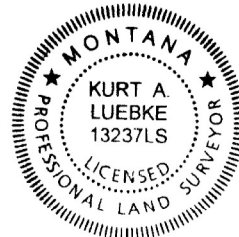

(Not to Scale)
 SKETCH OF CORNER

CERTIFICATION
 I, John Shirey
 certify the information shown herein is true and correct.

 Signature Ground Party Chief
 I, Kurt A. Luebke
 certify that this Corner Record correctly represents work performed
 by me or under my direction in compliance with the "Corner
 Recordation Act" (70-22-1(1), et seq., M.C.L.)

 Signature of Surveyor & Seal
 Date: 6-19-2008 Reg. No. 13237 S
 Employer: DJ&A P. C.

Office of Clerk and Recorder, County of Powell. This "corner

record" was filed for **162222 Fee: \$0.00 Bk Pg**
POWELL COUNTY Recorded 6/27/2008 At 11:30 AM
 was noted on the c: Diane S. Gray, Clk & Rcdr By *Diane S. Gray*, in
 Return To: **KURT LUEBKE**
 book No. _____

County Official
 Cross Index No. V-25 T. 9N R. 9W PMM
 Cross Index No. V-1 T. 9N R. 10W PMM

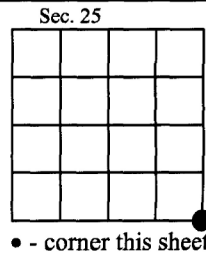

1/4 Corner Sec. 19 & 24
Found 1 1/2" Aluminum Cap
As per C.C.R. 169204
By Ray Masters in 1981

