

# Missoula County Control Point Datasheet

Monument Description: 2-1/2" Brass Cap 1956S

Project Name: ALL

Station Description: Section Corner

Date Visited: July 15, 2010

Monument Stability: C      GPS Visibility: A

Observer: SEN

Quad. Name: Northwest Missoula

T. 14 N.

R. 20 W. R. 19 W.

13	18
24	19

### NAD 83 (2007) Lat/Long Position

46°57'52.510"N

114°03'38.031"W

NAVD 88 Elevation: 3948.9 sft.

Notes:

Photo of Monument



Photo Looking East



Photo Looking South



**To Reach:** 400 foot walk from primitive road, accessed with permission from Mr. Dougherty.

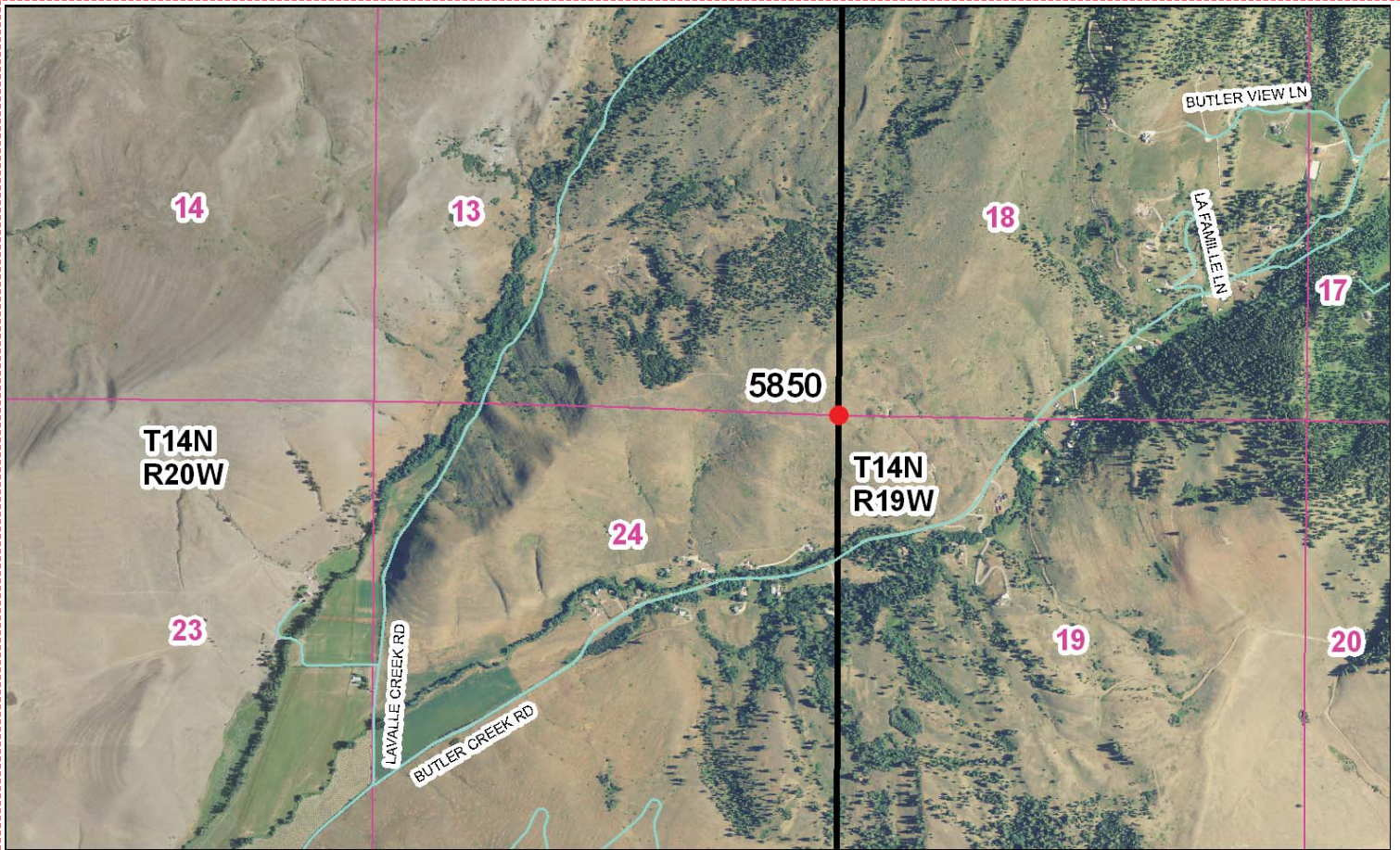

Map of Area

**Clarified Land Corner Recordation**

DESCRIPTION OF CORNER EVIDENCE FOUND, AND ORIGINAL RECORD (IF KNOWN)  
 glo Record: Set Cor. 18, 19, 13, & 24, A red sandstone 28x5x4 ins. with pits marked stone, etc., as per instructions:

FOUND: A 2 1/2" brass cap on 1" pipe in pile of rocks, 1 foot above ground, marked:



DESCRIPTION OF MONUMENT AND ACCESSORIES ESTABLISHED TO PERPETUATE THE ORIGINAL LOCATION OF THIS CORNER:  
 Date of work August 1978

SKETCH, WITH COURSE AND DISTANCE TO ADJACENT CORNERS IF DETERMINED IN THIS SURVEY. (MAY SKETCH OR PASTE REPRODUCTION ON REVERSE SIDE.)

See Certificate of Survey No. 212

DIAGRAM OF CORNER

I, Robert M. Zundel, certify that the information shown herein is true and correct.  
 Signature of Land Party Chief  
 Gordon E. Sorenson  
 certify that I have carefully performed or reviewed the work done on the diagrammed corner as reported on this recordation form and approve the same.  
 Signature of Surveyor  
 2345ES  
 Registration Number

Office of Clerk and Recorder, County of MISSOURI  
 This "corner record" was filed for record on the 20 day of Sept 1978, was noted on the cross-index plat and is assigned page No. 51904 in book No. 431745  
 County Official N-1  
 Cross Index No. N-25 T. 14 N. R. 20 W. Mer.  
 ROBERTA FRANK, County Clerk  
 By: Roberta Frank

**Corner Recordation Form or Other Supporting Document**

Point # 5850