

CERTIFIED CORNER RECORDATION

Corner 1/4 15 | 14 T. 15 N. R. 17 E. P.M.M. FERGUS County

Original Record: Set a Limestone 7x7x2 in. marked with a x, 12 in. in the ground for
 (W.W. deLacy) Qr. Sec. Corner. Raised mound of earth 2ft high 4 1/2 ft base on
 (D.E. Folsom) it & dug pits 18 in. sq. 12 in. deep N. S. E & W. 5 1/2 ft distant.
 1875

Evidence Found: Gravel road N-S. No X fences E-W. Dug up a couple tin cans but nothing else. Set this corner by using single proportion to establish the latitudinal position and from splitting R/W fences (60 ft apart) for the longitudinal position.

Perpetuation: In gravel road set MDT Alum. monument 15cm below surface. Set a No. 5 61cm long rebar inside pipe. Cap is stamped as shown.

NOTE: *Bearing and Dist. are based on State Plane Metric NAD 83-1992. To convert Dist. shown (grid) to ground divide by C.A.F. of 0.99919991

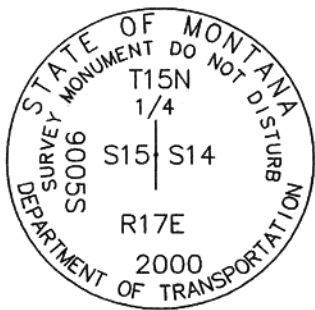
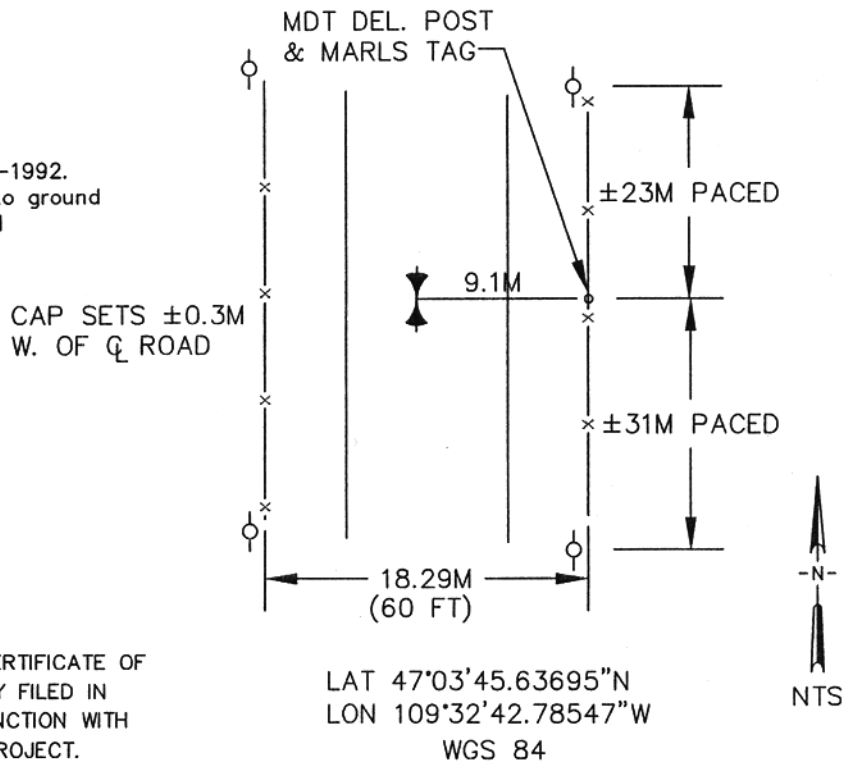

* SEE CERTIFICATE OF SURVEY FILED IN CONJUNCTION WITH THIS PROJECT.

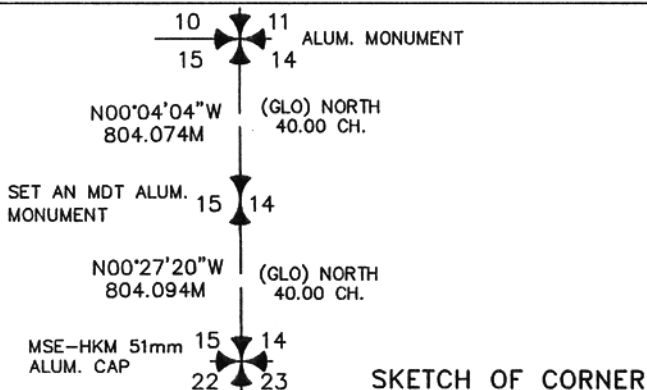

CERTIFICATION

I, _____ certify the information shown here is true and correct.

Signature Group Party Chief **SCOTT BLOOMENRADER**

I, **Scott Bloomenrader** certify that this Corner Record correctly represents work performed by me or under my direction in compliance with the "Corner Recordation Act" 70-2-101, et seq., M.C.A.

Signature of Surveyor & Seal **Scott Bloomenrader** REGISTERED SURVEYOR

Date: 9/24/2001 Reg. No. 9055

Employer: HKM Engineering Inc Billings, MT

Office of Clerk and Recorder, County of FERGUS. This "corner record" was filed for record on SEP 26 2001

was noted on the cross-index plat and is assigned page No. 24, in book No. 6 Lathy A. Folsom Susan M. Wierly - Dep County Official

Cross Index No. L-17 T. 15 N. R. 17 E. PMM

Adopted July 1, 1981, Montana Board of Professional Engineers & Land Surveyors

Sec. 15-T15N-R17E

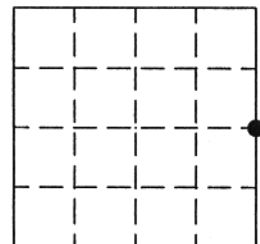

• - corner this sheet

61806