

CERTIFIED CORNER RECORDATION

Corner 12 | 7 / 13 | 18 T. 15 N. R. 17&18 E. P.M.M. FERGUS County

Original Record: Set a limestone 16x9x7 ins 11 ins in the ground for Corner to Sections 7, 12, 13 & 18, marked with 4 notches on S. and 2 notches on N. Dug pits 18 ins sq. 12 ins deep in each section. 5 1/2ft distant.
 (David E. Folsom)
 (Walter W. deLacy)
 1875

Subsequent Record: Corner record by Stewart Nash (5210LS) filed Feb 23, 1993 states he used occupation lines to reestablish the corner.

Evidence Found: Found an Alum. Cap 51mm in dia. and 2cm below unsurfaced section line road. Cap is stamped as shown.

Perpetuation: Corner is in good condition. Made references and ties to adjacent corners as shown.

NOTE: *Bearing and Dist. are based on State Plane Metric NAD 83-1992. To convert Dist. shown (grid) to ground divide by C.A.F. of 0.99919991

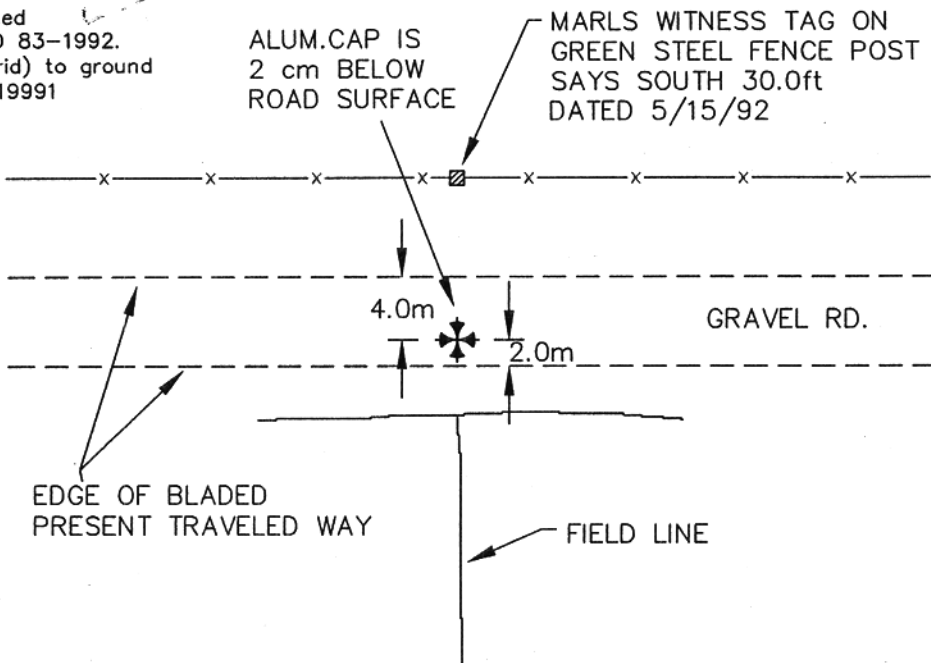
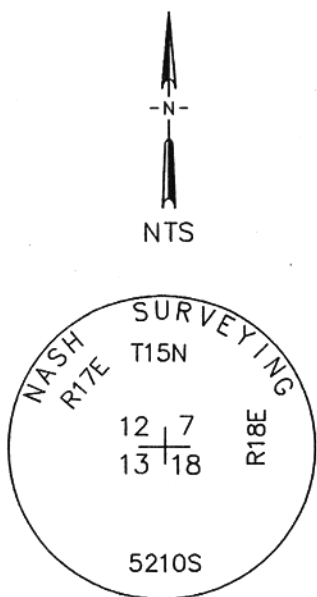

* SEE CERTIFICATE OF SURVEY FILED IN CONJUNCTION WITH THIS PROJECT.

LAT 47°04'11.80090"N
 LON 109°30'10.21618"W

WGS 84

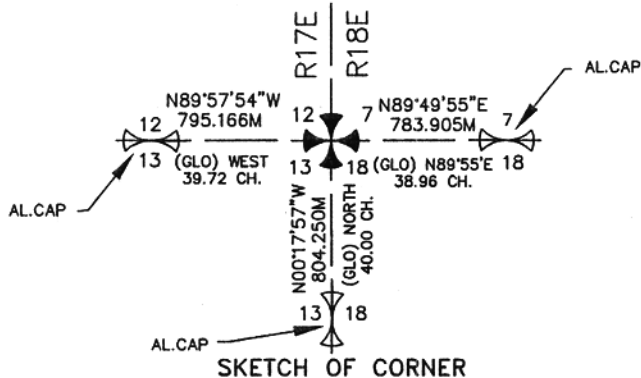

SKETCH OF CORNER

CERTIFICATION

MONTANA

I, _____ certify the information shown herein is true and correct.

Signature Group Party Chief SCOTT LS

I, Scott Bloomenrader certify that this Corner Record correctly represents work performed by me or under my direction in compliance with the "Corner Recordation Act" (70-22-101, et seq.) M.C.A.

Signature of Surveyor & Seal

Date: 9/24/2001 Reg. No. 9005 LS

Employer: HKM Engineering Inc Billings, MT

Office of Clerk and Recorder, County of FERGUS. This "corner record" was filed for record on 9-26-2001

was noted on the cross-index plat and is assigned page No. 23 in book No. 6
Larry A. Felsch
Susan M. Newby, Dep
 County Official

Cross Index No. J-25 T. 15 N. R. 17 E. P.M.M.

Adopted July 1, 1981, Montana Board of Professional Engineers & Land Surveyors

Sec. 13-T15N-R17E

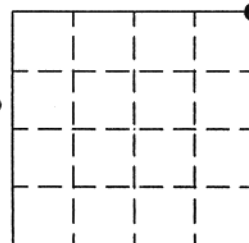

• - corner this sheet

61805