

INSTRUCTIONS

1. Original and/or subsequent record used to evaluate the corner position.
2. Description of evidence found, note discrepancies in the record, state method of establishing lost or obliterated corners.
3. Description of monument and accessories set to perpetuate the corner position.
4. Sketch of corner, show all pertinent data which can best be shown in a sketch example, corner marking, topography ties, position of accessories, etc.
5. Certification must be signed and sealed by Land Surveyor registered in the State of Montana.
6. Fill in Cross Index & Section Diagram at bottom of sheet.

CERTIFIED CORNER RECORDATION

Corner N.W. SEC. 18 T. 15 N R. 19 E P.M.M. FERGUS County

1. ORIGINAL RECORD: Set a sandstone 20 x 9 x 3 ins. , 15 ins. in the ground marked 2 on North and 4 on South edges. Pits and mound.
2. No evidence found of original stone. Found a 2" dia. iron pipe with a square metal tag attached, marked PIPE T15N
12/17
13/18 PIPE at fence intersection E-W and S.
3. See C/S No. 404 & 402 for ties to nearest corners.

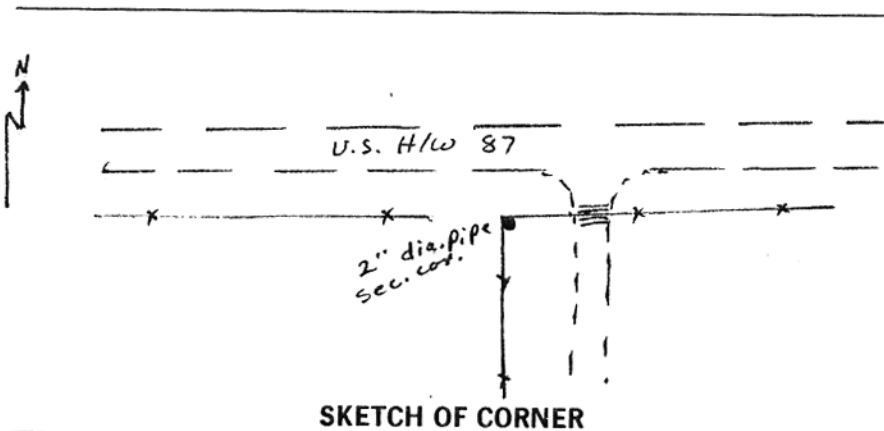

CERTIFICATION L.S. 52105

I, _____
certify the information shown herein is true and correct.

Signature Ground Party Chief

I, Stewart Nash
certify that this Corner Record correctly represents work performed by me or under my direction in compliance with the "Corner Recordation Act" (70-22-101, et seq., M.C.A.)

Stewart Nash
Signature of Surveyor & Seal

Date: 9-4-90 Reg. No. 52105
Employer: SELF

Office of Clerk and Recorder, County of FERGUS. This "corner record" was filed for record on APR 30 1991 APR 30 1991 was noted on the cross-index plat and is assigned page No. 210, in book No. 3

Debbie & Pallett
County Official

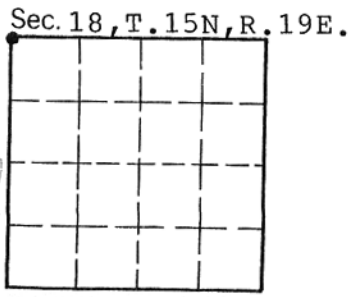

Cross Index No. J-1 T. 15N R. 19E P.M.M.

• - corner this sheet
15570