

# PLSS CORNER RECORD

Corner: W1/16 S30/S31 T. 16 N., R. 12 W. P.M.M. Powell County

1984 Remonumentation by Stanley Skousen as follows:

At the calculated position, set a standard USDA alum. drivable pipe with 3 1/4 in. alum. cap 6 ins. above ground marked as shown.

Established two bearing trees described as follows:

A lodgepole pine, 16 ins. diam., bears S. 54°30' W., 45.2 ft. dist., scribed (WC 1/16 S30 BT)

A lodgepole pine, 15 ins. diam., bears N. 11° W., 42.1 ft. dist., scribed (WC 1/16 S30 BT)

Description of Corner Evidence Found:

The alum. cap monument was recovered in good shape, the NW BT is dead standing and the SW BT is dead and down. During the course of my survey I discover a significant positional blunder error that I have fixed, the survey information will be filed on a Certificate of Survey.

Description Of Monument And Accessories Established:

The 1984 1/16 corner monument was moved to the correct position according to my survey, set 24 inches in the ground, with alum. Forest Service cap now marked as shown, and in a collar of stone 2 ft. diam., from which

A fir, 16 ins. diam., bears S. 80 1/2° E., 54.5 ft. dist., marked X BT

A fir, 23 ins. diam., bears S. 22 1/2° E., 67.5 ft. dist., marked W1/16S30BT

From this new corrected 1/16 cor. point, the old superseded corner point bears N. 15°15'27" E., 7.52 ft. dist.,

T16N R12W  
W 1/16 S30  
LS9955  
2013  
SJS 1984 2532S

The BT's were signed and the blazes were painted red, I measure the distances to a nail in the side at center. Corner is located on flat mostly open ground approx. 20 ft. W. of a dirt road.

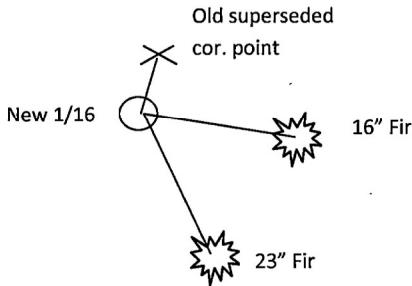

SKETCH OF CORNER

I, \_\_\_\_\_  
 certify the information shown herein is true and correct.  
 No. 9955  
 \_\_\_\_\_  
 State Engineer and Board Chief

I, \_\_\_\_\_  
 certify that this Corner Record correctly represents work performed by me or under my direction in compliance with the "Corner Recordation Act" (70-22-101, et seq., MCA)

*Michael W. Beale*  
 Signature of Surveyor & Seal

Date: 7/7/2014 Lic. No. 9955  
 Employer: U.S. Forest Service

Office of Clerk and Record: **171893 Fee: \$0.00 Bk Pg**  
 record" was filed for record **POWELL COUNTY Filed 10/20/2014 At 12:15 PM**  
 was noted on the cross-inc **Diane S. Grey, Clk & Rcdr By *Diane S. Grey***  
**Return To: FILING**

Sec. 30

County Official

● Corner this sheet

Geodetic control for this survey references the North American Datum of 1983 (NAD 83) and was established utilizing static GPS observations post-processed by the National Geodetic Survey's (NGS) Online Positioning User Service (OPUS). The geographic position of the W. 1/16 corner of sections 30 and 31, T. 16 N., R. 12 W., as determined by survey grade GPS-RTK methods and conventional traverse methods, is:

Latitude: 47° 06' 25.051" North  
Longitude: 113° 10' 15.438" West

**Photographs of the monument:**

