

INSTRUCTIONS

1. Original and/or subsequent record used to evaluate the corner position.
2. Description of evidence found, note discrepancies in the record, state method of establishing lost or obliterated corners.
3. Description of monument and accessories set to perpetuate the corner position.
4. Sketch of corner, show all pertinent data which can best be shown in a sketch example, corner marking, topography ties, position of accessories, etc.
5. Certification must be signed and sealed by Land Surveyor registered in the State of Montana.
6. Fill in Cross Index & Section Diagram at bottom of sheet.

CERTIFIED CORNER RECORDATION

Corner Sec. 20, 21, 28, & 29, T. 16N, R. 18E, P.M.M. Fergus County

No evidence of GLO corner stone found.

Set $\frac{5}{8}$ " ϕ x 24" rebar w/ cap at fence corner w/ fence running East & South and a line of old posts running North over the hill.

Accessories: Set $\frac{1}{2}$ " ϕ x 12" rebar 10.00 feet East, in fenceline.

Set " " " " 10.00 feet South, in fenceline.

Survey for missile site M4.

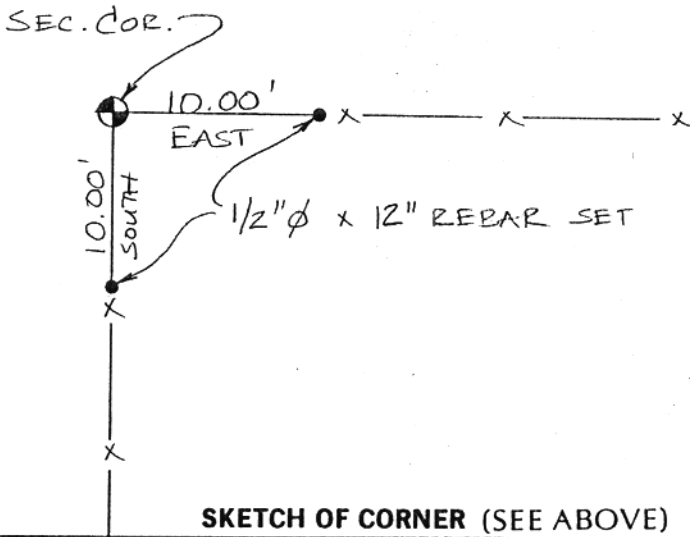
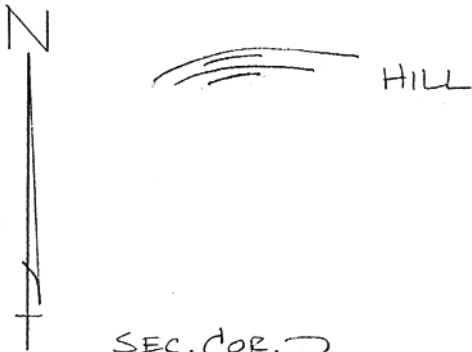
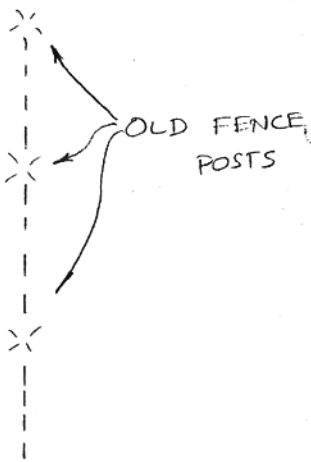

CERTIFICATION	
I, <u>Dennis D. Findorff</u>	X
certify the information shown herein is true and correct.	
<i>Dennis D. Findorff</i>	
Signature Ground Party Chief	
I, <u>Robert E. Findorff</u>	
certify that this Corner Record correctly represents work performed by me or under my direction in compliance with the "Corner Recordation Act" (9-3-10), et seq. M.C.A.)	
<i>Robert E. Findorff</i>	
Signature of Surveyor & Seal	
Date: <u>11/7/85</u>	Reg. No. <u>3976ES</u>
Employer: <u>Self</u>	

Office of Clerk and Recorder, County of FERGUS. This "corner record" was filed for record on NOV 12 1985 was noted on the cross-index plat and is assigned page No. 98, in book No. 2.
Robert E. Findorff
 County Official

Sec. 21, T16N, R18E.

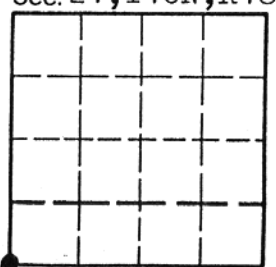

Cross Index No. R-9 T. 16 R. 18 P.M.M.
 Adopted July 1, 1981, Montana Board of Professional Engineers & Land Surveyors

18272

8525