

INSTRUCTIONS

1. Original and/or subsequent record used to evaluate the corner position.
2. Description of evidence found, note discrepancies in the record, state method of establishing in, bliterated
3. Description of monument and accessories set to perpetuate the corner position.
4. Sketch of corner, show all pertinent data which can best be shown in a sketch example, corner marking, topography ties, position of accessories, etc.
5. Certification must be signed and sealed by Land Surveyor registered in the State of Montana
6. Fill in Cross Index & Section Diagram at bottom of sheet.

61- 405937

CERTIFIED CORNER RECORDATION

Corner: 1/4 Section Corner 18 & 19 T. 16N R. 19W P.M.M. Lake & Missoula County

ORIGINAL RECORD: (1905G.L.O.) Set a granite stone, 24x18x3 ins., 18 ins. in the ground marked 1/4 on N face; raise a mound of stone, 2 ft. base 1 1/2 ft. high, N. of corner.

SUBSEQUENT RECORD: See corner recordation #211160 by Christopher Balstad Jr. in 1973, no evidence set by single proportion a 3/4" rebar with YPC in center of road with a 5/8" pipe as RM at 21.56' South.

SUBSEQUENT RECORD: This corner recordation revises c.r. #401820 filed in Aug. of 1999 by Glenn Howard.

EVIDENCE FOUND: Found a 3/4" rebar no cap 5" under the county road and found a 3/4" pipe under fence line at 21.56' South.

PERPETUATION: Set a 3/4" aluminum cap on the existing 3/4" rebar in the center of the county road; also replaced the 3/4" pipe at the fence with a 3/4" MDT aluminum cap on a 30" aluminum pipe as an RM to the corner position. The caps are marked as shown in the sketch. From which;
 A wood fence post bears N22°W, 24.6' distant; with a MARLS tag.
 A power pole bears S53°E, 34.2' distant; with a MARLS tag.

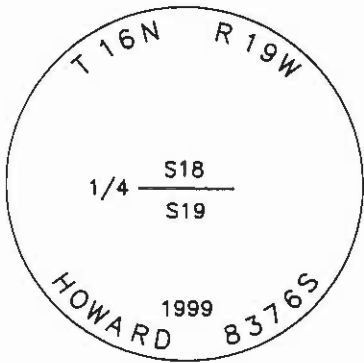
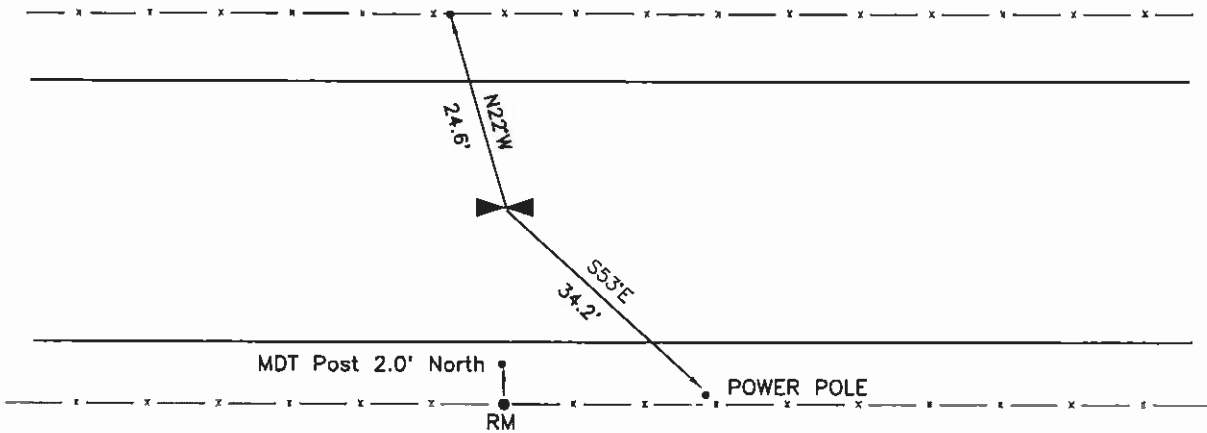

RM 21.56' SOUTH

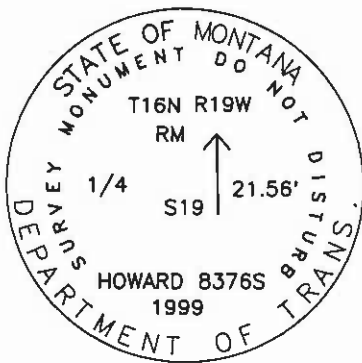

SKETCH OF CORNER

CERTIFICATION

I, Gerald McCarthy certify the information shown herein is true and correct.

Gerald McCarthy
Signature Ground Party Chief

I, Glenn R. Howard certify that this Corner Record correctly represents work performed by me or under my direction in compliance with the "Corner Recordation Act" (70-22-101, et seq., M.C.A.)

Glenn R. Howard
Signature of Surveyor & Seal

Date: 2-3-2000 Reg. No. 8376 S

Employer: DJ&A, P.C.

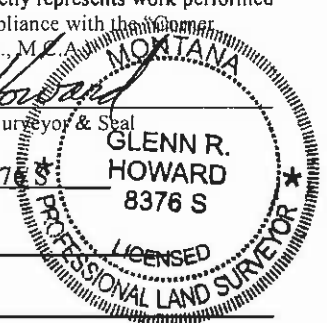

Office of Clerk and Recorder, County of Lake. This "corner

record" was filed for record on FEB 04 2000 at 10:50 A.M.

was noted on the cross index plat and is assigned page No. 405937, in

book No. NC RUTH E. HODGES by: *Judy M...*
County Official

Cross Index No. N-3 T. 16N R. 19W PMM

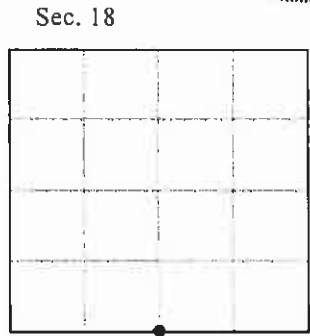

-- corner this sheet