

CERTIFIED LAND CORNER RECORDATION

197808

DESCRIPTION OF CORNER EVIDENCE FOUND, AND ORIGINAL RECORD (IF KNOWN)

At the One-Quarter Corner of Sections 15 & 22, T.16N., R.19W., Principal Meridian Montana, Lake County, Montana, and Missoula County, Montana.

REcord: Set a Granite Stone 18"x10"x10" with 2 bearing trees.

We find: We found the original stone.

DESCRIPTION OF MONUMENT AND ACCESSORIES ESTABLISHED TO PERPETUATE THE ORIGINAL LOCATION OF THIS CORNER:

Date of work: Feb. 1971

To perpetuate this corner we established the following reference monuments:

A Pine 24" in diam. bears S.10°00'W., a dist. of 83.6 feet.

A Pine 24" in diam. bears N.10°00'W., a dist. of 50.5 feet.

(Variance used 20°)

SKETCH, WITH COURSE AND DISTANCE TO ADJACENT CORNERS IF DETERMINED IN THIS SURVEY. (MAY SKETCH OR PASTE REPRODUCTION ON REVERSE SIDE.)

See Attached Plat

DIAGRAM OF CORNER:

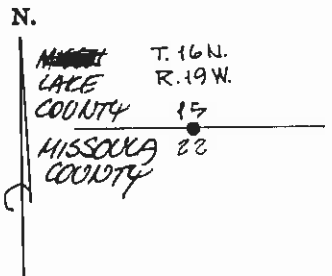

= Corner recorded on the sheet

Surveyor's Seal

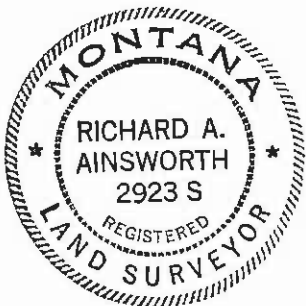

I, Elden Inabnit certify that the information shown herein is true and correct.

Signature of Elden Inabnit

Signature of Ground Party Chief

I, Richard A. Ainsworth certify that I have carefully performed or reviewed the work done on the diagrammed corner as reported on this recordation form and approve the same.

Signature of Richard A. Ainsworth

Signature of Surveyor

AINSWORTH & ASSOCIATES

2923S Registration Number

Office of Clerk and Recorder, County of Lake

This "corner record" was filed for record on the 1 day of April 1971, was not d on the cross-index plat and is assigned page No. 197808, in book No. C-144. ETHER M. HARDING, CLERK & RECORDER, Missoula County Official.

Cross Index No. N15 T.16N R.19W Mer