

INSTRUCTIONS

1. Original and/or subsequent used to evaluate the corner position
2. Description of evidence found, note discrepancies in the record, state method of establishing lost or obliterated corners
3. Description of monument and accessories set to perpetuate the corner position.
4. Sketch of corner, show all pertinent data which can best be shown in a sketch example, corner marking, topography ties, position of accessories, etc.
5. Certification must be signed and sealed by Land Surveyor registered in the State of Montana.
6. Fill in Cross Index & Section Diagram at bottom of sheet.

61-401816

CERTIFIED CORNER RECORDATION

Corner: Section Corner 1, 2, 11, 12 T. 16N R. 20W P.M.M. Lake County

ORIGINAL RECORD: (1905 G.L.O.) Set a granite stone, 15x10x8 ins., 10 ins. in the ground marked with 5 notches on S. and 1 notch on E. edge; and raise a mound of stone, 2 ft. base, 1.5 ft. high, W. of corner.

(1925 G.L.O.) Found a granite stone, 10x8x4 ins. above ground, marked as described in the original field notes. On the E. side of stone set an iron post with a brass cap marked "T16N R20W S1-S2-S11-S12 1925" from which:
The corner post of fences bearing N., S., E. and W., bears S82°E, 71 lks. dist..

SUBSEQUENT RECORD: See corner recordation #365518. Placed two BT tags.

EVIDENCE FOUND: Found 2" pipe with no cap and BT tags.

PERPETUATION: Set a 3 1/4" MDT aluminum cap on a 30" aluminum pipe in the position of the pipe. The cap is marked as shown in the sketch. From which;
A power pole bears N26°E, 28.2' distant; with a MARLS tag.
A power pole bears S18°W, 19.0' distant; with a MARLS tag.

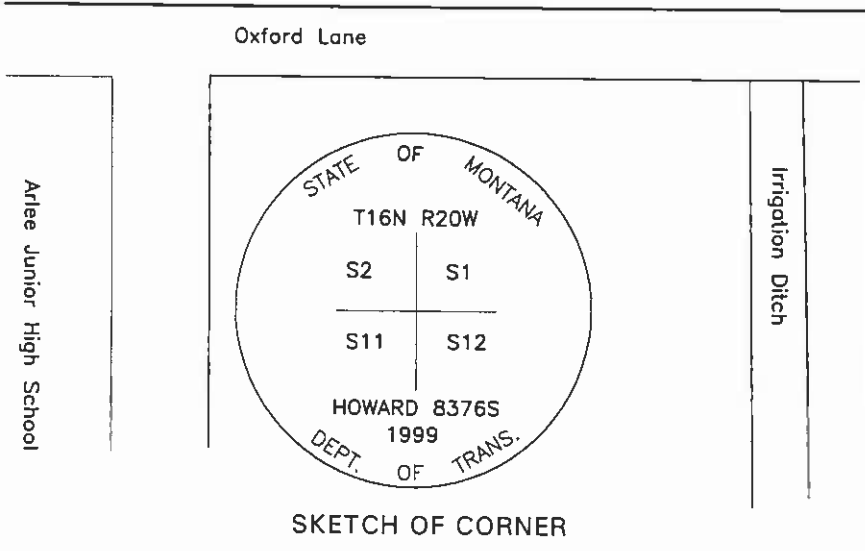

SKETCH OF CORNER

CERTIFICATION

I, Gerald McCarthy
certify the information shown herein is true and correct.

Gerald McCarthy
Signature Ground Party Chief

I, Glenn R. Howard
certify that this Corner Record correctly represents work performed by me or under my direction in compliance with the "Corner Recordation Act" (70-22-101, et seq., M.C.A.)

Glenn R. Howard
Signature of Surveyor & Seal

Date: 7-28-99 Reg. No. 8376 S

Employer: DJ&A, P.C.

Office of Clerk and Recorder, County of Lake. This "corner record" was filed for record on AUG 11 1999 10:42 AM as noted on the cross index plat and is assigned page No. 401816, in Book No. C-2242 RUTH E. HODGES County Official *Judy M... dep*

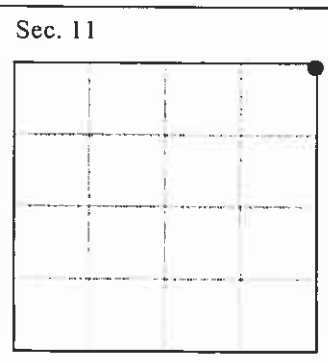

Cross Index No. E-21 T. 16N R. 20W PMM

Adopted July 1, 1981, Montana Board of Professional Engineers & Land Surveyors

•- corner this sheet

N/c