

CERTIFIED LAND CORNER RECORDATION

DESCRIPTION OF CORNER EVIDENCE FOUND, AND ORIGINAL RECORD (IF KNOWN)

40.00 Set a granite stone, 14x12x12ins., 9 ins.in the ground, for 1/4 sec. cor., marked 1/4 on W. face; raised a mound of stone 2 ft. base, 1 1/2 ft. high, W. of cor.

Found original stone in place and possible remains of mound

DESCRIPTION OF MONUMENT AND ACCESSORIES ESTABLISHED TO PERPETUATE THE ORIGINAL LOCATION OF THIS CORNER:

Date of work: June, 1972

Set 1 1/4x30 inch pipe with 3 inch aluminum cap, 25 inches in the ground. Mounded cap with stone. Buried original stone to east of pipe/ fence corner bears north 1 foot.

SKETCH, WITH COURSE AND DISTANCE TO ADJACENT CORNERS IF DETERMINED IN THIS SURVEY. (MAY SKETCH OR PASTE REPRODUCTION ON REVERSE SIDE.)

See attachment A-23

Surveyor's Seal

I, certify that the information shown herein is true and correct.

Signature of Ground Party Chief

I, R. David Schurian certify that I have carefully performed or reviewed the work done on the diagrammed corner as reported on this recordation form and approve the same.

R. David Schurian Signature of Surveyor

DIAGRAM OF CORNER:

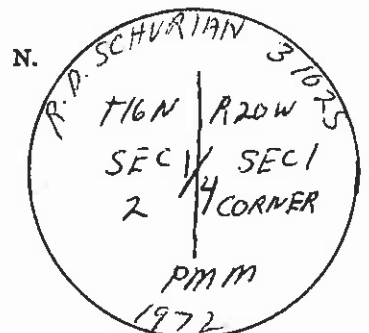

= Corner recorded on the sheet

3102S Registration Number

Office of Clerk and Recorder, County of Lehigh

This "corner record" was filed for record on the JUN 29 1972 day of 8:26 A.M. was noted on the cross-index plat and is

assigned page No. C-259 in book No.

BY: M. HARDING Joannal B... County Official

Cross Index No. C-21 T. 16 N. R. 20 W Mer.