

INSTRUCTIONS

1. Original and/or subsequent record to evaluate the corner position
2. Description of evidence for discrepancies in the record, state method of establishing corners
3. Description of monument and accessories set to perpetuate the corner position.
4. Sketch of corner, show all pertinent data which can best be shown in a sketch example, corner marking, topography ties, position of accessories, etc.
5. Certification must be signed and sealed by Land Surveyor registered in the State of Montana.
6. Fill in Cross Index & Section Diagram at bottom of sheet.

Numbered **61-401835**

**CERTIFIED CORNER RECORDATION**

Corner: Section Corner 15, 16, 21, & 22 T. 17N R. 20W P.M.M. Lake County

ORIGINAL RECORD: (1904 G.L.O.) Set a sandstone, 15x12x3 ins., 10 ins. in the ground marked with 3 notches on S. and E. edges; and raise a mound of stone, 2 ft. base, 1.5 ft. high, W. of corner.

SUBSEQUENT RECORD: See corner recordation #264080. Set a 5/8"x24" rebar with YPC marked "BIA Flathead".

EVIDENCE FOUND: Found 1 1/4" YPC marked "BIA Flathead".

PERPETUATION: Set a 3 1/4" MDT aluminum cap on a 30" aluminum pipe in the position of the rebar, with the rebar buried alongside. The cap is marked as shown in the sketch. From which;  
 A 52" cottonwood bears N71°W, 318.2' distant; with a MARLS tag and a 1/2"x24" rebar with a 1" RPC marked "DJA CP"1' in front of tree(N71°W & 315.3').  
 A 16" cottonwood bears N47°E, 113.4' distant; with a MARLS tag.

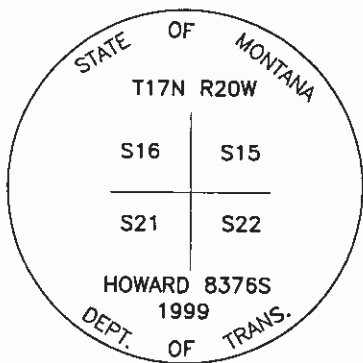

SKETCH OF CORNER

CERTIFICATION

I, Joseph Bauch  
 certify the information shown herein is true and correct.

*Joseph Bauch*  
 Signature Ground Party Chief

I, Glenn R. Howard  
 certify that this Corner Record correctly represents work performed by me or under my direction in compliance with the "Corner Recordation Act" (70-22-101, et seq., M.C.A.)

*Glenn R. Howard*  
 Signature of Surveyor & Seal

Date: 8-9-99 Reg. No. 8376 S

Employer: DJ&A, P.C.

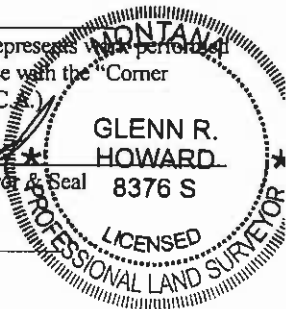

Office of Clerk and Recorder, County of Lake. This "corner

record" was filed for record on AUG 11 1999 11:07 AM

was noted on the cross index plat and is assigned page No. 401835, in

book No. C-2261 RUTH E. HODGES Judy Muniz dep  
 County Official

Cross Index No. N-13 T. 17N R. 20W PMM

Sec. 21



•- corner this sheet

NC