

090077

CERTIFIED CORNER RECORDATION

Corner Sec. Cor. Secs. 26,27,34&35 T. 17 N R. 26W P.M., MT Mineral County

- I. 1893 G.L.O. Record by Rodney W. Page and Arthur Page: Set a slate stone 12x10x4, 8 ins. in the ground for cor. to Secs. 26, 27, 34 and 35 marked with 1 notch on S. and 2 notches on E. edges; from which:
 - A fir 14 ins. diam., bears N.65°15'E., 70lks. (46.20 ft.) dist., marked "T17N R26W S26 BT".
 - A fir 30 ins. diam., bears S.34°E., 124 lks.(81.84 ft.) dist., marked "T17N R26W S35 BT".
 - A pine 20 ins. diam, bears S.32°W., 66 lks. (43.56 ft.) dist., marked " T17N R26W S 34 BT".
 - A pine 30 ins. diam. bears N.29°W., 120 lks. (79.20 ft.) dist., marked " T17N R26W S 27 BT".

1961 B.L.M. Record by Kenneth E. West, Supervisory Cadastral Surveyor: The cor. of secs. 26,27,34 and 35, monumented with an unmarked slate stone, 16x10x3 ins., firmly set in the ground and witnessed by the remains of three of the original bearing trees.

At the corner point

Set an iron post, 30 ins. long, 2 1/2 ins. diam., 20 ins. in the ground to bedrock, and in a mound of stone to top, with brass cap mkd. from which

The remains of the original bearing trees:

- A fir, 18 ins. diam., bears N.63°15'E., 70 lks.(46.20 ft.,) dist., mkd. with an overgrown blaze. (Record: N.65°15'E., 70 lks.dist.)
- A fir stump, 30 ins. diam., bears S.36°45'E., 124 lks.(81.84 ft.) dist., mkd. with an old blaze. (Record: S.34°E., 124 lks. dist.)
- A dead pine, 32 ins. diam., bears N.26°W., 120 lks.(79..20 ft.) dist., mkd. T17NR26WS27BT. (Record: N.29°W., 120 lks. dist.)

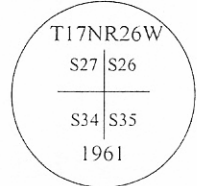

The new bearing trees:

- A fir, 16 ins., diam., bears S.27°45'E., 59 lks.(38.94 ft.) dist., mkd. T17NR26WS35BT.
- A pine, 16 ins. diam., bears S.37°45'W., 112 lks.(73.92 ft.) dist., mkd. T17NR26WS34BT.
- A pine, 8 ins. diam., bears N.73°W., 47 lks.(31.02 ft.) dist., mkd. T17NR26WS27BT.

Bury the original stone alongside the iron post.

- II. Found a 3/4 inch dia. B.L.M. brass cap 7 ins. above the ground marked as shown above.
 - 1893 BT's: A 27 inch dia. D.fir bears N.63°E., 46.20 ft. blaze overgrowth and bark burnt. No evidence of Sec. 27, 34 and 35 BT's.
 - 1961 BT's: Burnt out remains of root systems for Secs. 27, 34 and 35.

- III. The pipe and cap are in good condition.
 - Established three new bearing trees:
 - A p.pine 5 ins. diam., bears S.4°E., 40.6 ft. scribed "X BT".
 - A p.pine 14 ins. diam. bears S.39°W., 84.7 ft. scribed "T17NR26WS34BT".
 - A p.pine 6 ins. diam. bears N.80°W., 40.8 ft. scribed "X BT".

Painted bearing trees and attached Land Survey Monument and Bearing Tree signs.
Magnetic Declination: 17 1/2° East.

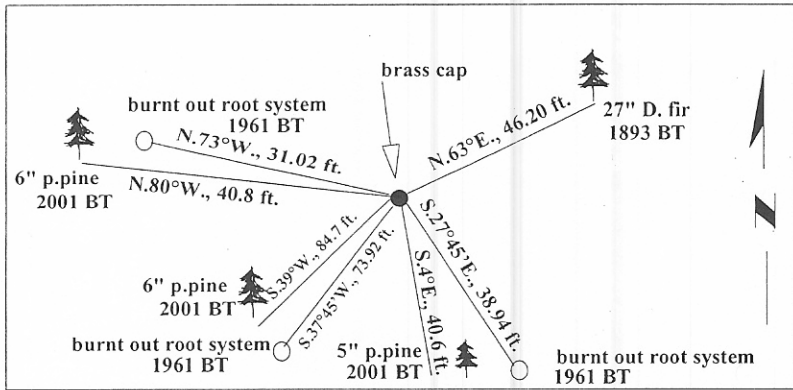

SKETCH OF CORNER

CERTIFICATION

I, **Ronald L. Benton** certify the information shown herein is true and correct.

Ronald L. Benton

I, **Ronald A. Pearson** certify that this Corner Record correctly represents work performed by me or under my direction in compliance with the "Corner Recordation Act" (70-22-101, et seq., M.C.A.)

Ronald A. Pearson

Signature of Surveyor & Seal

Date: 04/27/2001

Reg. No.: 9008LS

Employer: U.S. FOREST SERVICE

090077

Office of Clerk and Recorder, County of Mineral. This "corner record" was filed for record on 5-14-01 @ 4:48 pm and was noted on the cross-index plat and is assigned page No. _____, in book No. _____.

Katherine [Signature] by K. McNees
County Official

