

CERTIFIED LAND CORNER RECORDATION
(REFERENCE FSH 5681.65)

DESCRIPTION OF CORNER EVIDENCE FOUND, AND ORIGINAL RECORD (IF KNOWN)

At the 1/4 Corner of Sections 5 & 8, T. 17 N., R 27 W., MPM, I found a quartzite rock 14"x7"x6", well set in the ground, marked "1/4" on N. face and "1/4" on the top, (Record: Quartzite stone 14"x7"x6", 10" in the ground, for 1/4 Sec. Cor., mkd "1/4" on N. face.); from this I found a stump hole which bears N. 13 1/2° E., 37 links distant, (Record: A 14" pine, N. 13 1/2° E., 27 links, marked "1/4 S.B.T."); and I found a well decayed stump which bears S. 48 3/4° E., 46 links distant, (Record: 12" Fir, S. 48 3/4° E., 46 links, mkd "1/4 S.B.T.").

(*Note: I found a discrepancy of 10 links in distance from corner to B.T. stump for Section 5.)

DESCRIPTION OF MONUMENT AND ACCESSORIES ESTABLISHED TO PERPETUATE THE ORIGINAL LOCATION OF THIS CORNER:

At the corner I set a 2"x30" galvanized iron pipe 20" in the ground, with a brass cap marked:

Date of work: 13 August 1964

I marked ~~two (2)~~ new R.M.'s as follows:

- 14" D-Fir bears S. 70 1/2° E., 35 links distant, marked "1/4 S 8 R.M."
10" D-Fir bears S. 1° W., 34 links distant, marked "F.S.R.M."
8" D-Fir bears N. 59° W., 28 links distant, marked "1/4 S 5 R.M."

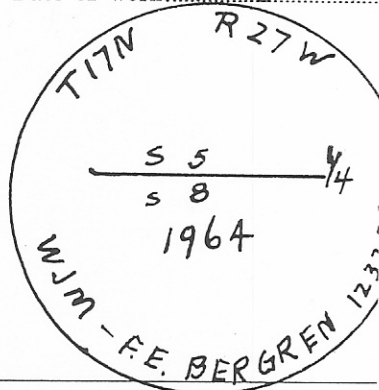

SKETCH, WITH COURSE AND DISTANCE TO ADJACENT CORNERS IF DETERMINED IN THIS SURVEY. (MAY SKETCH OR PASTE REPRODUCTION ON REVERSE SIDE.)

Surveyor's Seal

I, William J. Morrow certify that the information shown herein is true and correct.

Signature of William J. Morrow, Signature of Ground Party Chief

I, Frank E. Bergren certify that I have carefully performed or reviewed the work done on the diagrammed corner as reported on this recordation form and approve the same.

Signature of Frank E. Bergren, Signature of Surveyor

DIAGRAM OF CORNER:

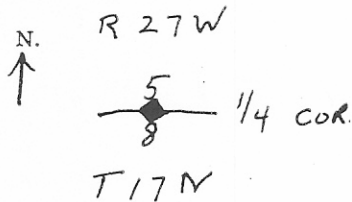

Corner symbol = Corner recorded on the sheet

1232 ES Registration Number

Office of Clerk and Recorder, County of Mineral

This "corner record" was filed for record on the 16th day of Sept 1964, was noted on the cross-index plat and is assigned page No. at 2:10 o'clock pm, in book No. Ruth C. Morris Deputy Clerk

Cross Index No. E. 7 T. 17 N. R. 27 W. P Mer.