

CERTIFIED LAND CORNER RECORDATION (REFERENCE FSM 7153.53)

DESCRIPTION OF CORNER EVIDENCE FOUND, AND ORIGINAL RECORD (IF KNOWN)

Found no evidence of original stone or bearing trees.

Record: Set a granite stone 24x6x5 inches 18 inches in the ground, from which a 10 inch pine bears N 61° E, 18 lks distance marked 1/4 S B.T. A 10 inch pine bears N 23° W, 41 lks distance marked 1/4 S B.T.

DESCRIPTION OF MONUMENT AND ACCESSORIES ESTABLISHED TO PERPETUATE THE ORIGINAL LOCATION OF THIS CORNER:

Set a 2" by 30" brass capped 28 inches deep in the ground stamped as shown. From which A 8inch L. P. Pine bears S 24 3/4° W and 45.5 ft. A 12inch L. P. Pine bears S 74° W and 74.3 ft.

Date of work:.....

Both trees blazed and scribed R.M. Painted blazes red posted B.T. and attention signs.



SKETCH, WITH COURSE AND DISTANCE TO ADJACENT CORNERS IF DETERMINED IN THIS SURVEY. (MAY SKETCH OR PASTE REPRODUCTION ON REVERSE SIDE.)

Surveyor's Seal

I, William W. Markham certify that the information shown herein is true and correct. Signature of Ground Party Chief

I, Stanley J. Skousen certify that I have carefully performed or reviewed the work done on the diagrammed corner as reported on this recordation form and approve the same. Signature of Surveyor

DIAGRAM OF CORNER:

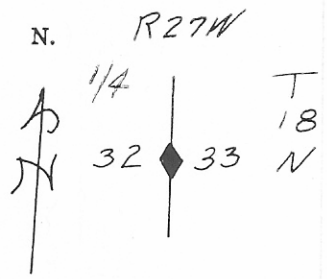

◆ = Corner recorded on the sheet

2532 S Registration Number

Office of Clerk and Recorder, County of Merced

This "corner record" was filed for record on the 16th day of January, 1974, was noted on the cross-index plat and is assigned page No. ...., in book No. ....

Cross Index No. X-9 T. 18N R. 27W Mer.