

CERTIFIED LAND CORNER RECORDATION

DESCRIPTION OF CORNER EVIDENCE FOUND, AND ORIGINAL RECORD (IF KNOWN)

No EVIDENCE OF ORIGINAL - CORNER DESTROYED BY CONSTRUCTION OF COUNTY ROAD

DESCRIPTION OF MONUMENT AND ACCESSORIES ESTABLISHED TO PERPETUATE THE ORIGINAL LOCATION OF THIS CORNER:

Date of work: April 17, 1974

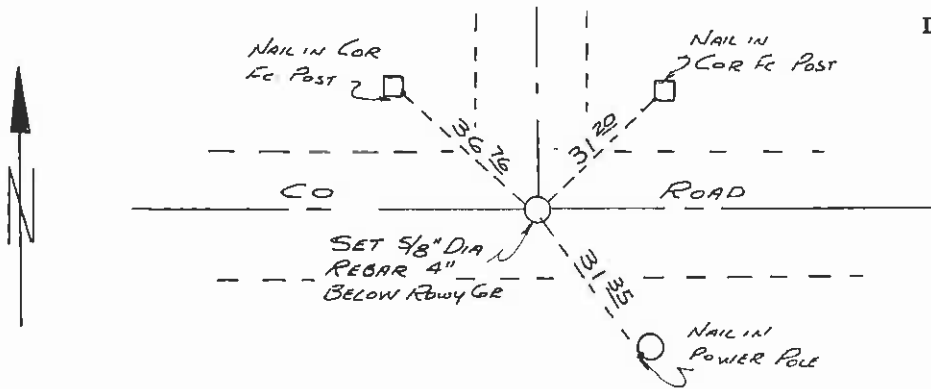

SKETCH, WITH COURSE AND DISTANCE TO ADJACENT CORNERS IF DETERMINED IN THIS SURVEY. (MAY SKETCH OR PASTE REPRODUCTION ON REVERSE SIDE.)

SEE - REVERSE

Surveyor's Seal

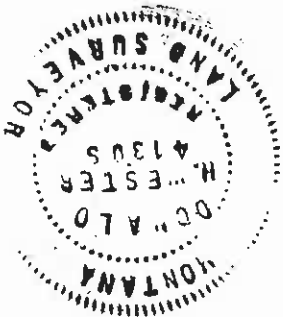

I, _____ certify that the information shown herein is true and correct.

Signature of Ground Party Chief

I, DONALD H. WESTER certify that I have carefully performed or reviewed the work done on the diagrammed corner as reported on this recordation form and approve the same.

Signature of Surveyor

4130 S. Registration Number

DIAGRAM OF CORNER:

N. T. 19. N. R. 20 W.

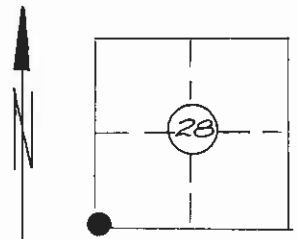

● = Corner recorded on the sheet

Office of Clerk and Recorder, County of Lake micro 217924

This "corner record" was filed for record on the 22 day of July 1974, was noted on the cross-index plat and is

signed page No. C, in book No. C-501 3:57 P.M. ETHEL M. HARDING County Official Margaret Bruggeman

Form 125 - 43227 Cross Index No. V-9 T. 19 N. R. 20 W. Mer.