

CERTIFIED LAND CORNER RECORDATION

222725

DESCRIPTION OF CORNER EVIDENCE FOUND, AND ORIGINAL RECORD (IF KNOWN)

Original record:

Set a sandstone, 16x7x5 ins. in the ground, for 1/4 corner, marked 1/4 on West face; and raise a mound of stone, 2 ft. base 1 1/2 ft. high west of corner. Pits impracticable. 51.50 chains road, bears E. and W.

Found: No evidence of above. Road construction has destroyed all evidence. Searched for road as per notes - no evidence found.

This 1/4 corner set on a straight line between the two corner stones and single proportionate distance.

DESCRIPTION OF MONUMENT AND ACCESSORIES ESTABLISHED TO PERPETUATE THE ORIGINAL LOCATION OF THIS CORNER:

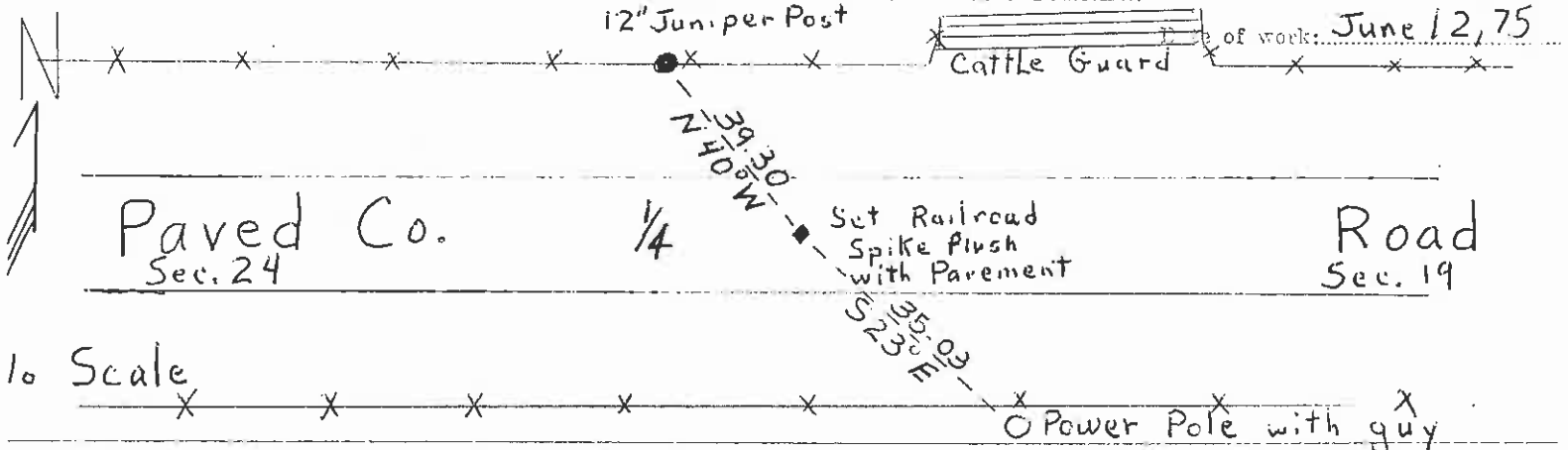

SKETCH, WITH COURSE AND DISTANCE TO ADJACENT CORNERS IF DETERMINED IN THIS SURVEY. (MAY SKETCH OR PASTE REPRODUCTION ON REVERSE SIDE.)

OVER

Surveyor's Seal

I, _____ certify that the information shown herein is true and correct.

Signature of Ground Party Chief

I, Christopher Balstad Jr. certify that I have carefully performed or reviewed the work done on the diagrammed corner as reported on this recordation form and approve the same.

Christopher Balstad Jr.
Signature of Surveyor

DIAGRAM OF CORNER:
T 20 N R 19 W

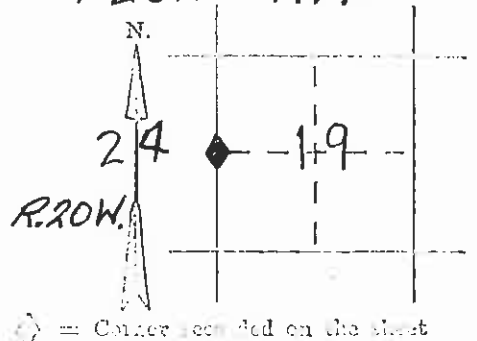

33229
Registration Number

Clerk and Recorder, County of Lake, State of Montana

Record was filed for record on the 11th day of July, 1975, at 4:38 o'clock P. M.

Ethel M. Harding, Clerk & Recorder

County Officer By: Anna A. Wilson, Dep.

City and State No. P-1 T. 20 R. 19