

CERTIFIED LAND CORNER RECORDATION

197737

DESCRIPTION OF CORNER EVIDENCE FOUND, AND ORIGINAL RECORD (IF KNOWN)

No evidence of original.

DESCRIPTION OF MONUMENT AND ACCESSORIES ESTABLISHED TO PERPETUATE THE ORIGINAL LOCATION OF THIS CORNER:

Date of work: MARCH 13-77

Set 1/2" steel pipe for 1/4 corner Sec. 7 & 6 T. 21 N. R. 19 W. P.M.M.

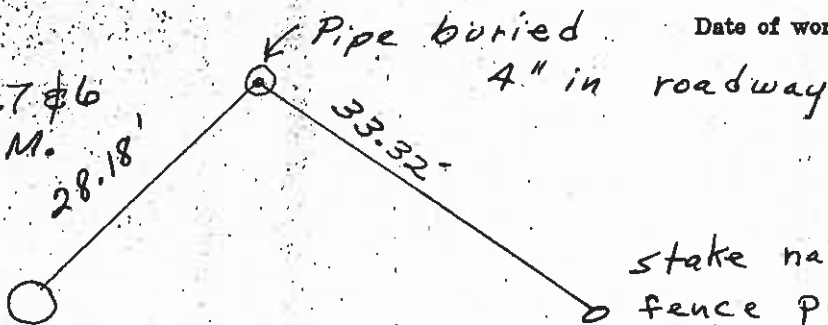

SKETCH WITH COURSE AND DISTANCE TO ADJACENT CORNERS IF DETERMINED IN THIS SURVEY. (MAY SKETCH OR PASTE REPRODUCTION ON REVERSE SIDE.)

Set 1/16 Cor

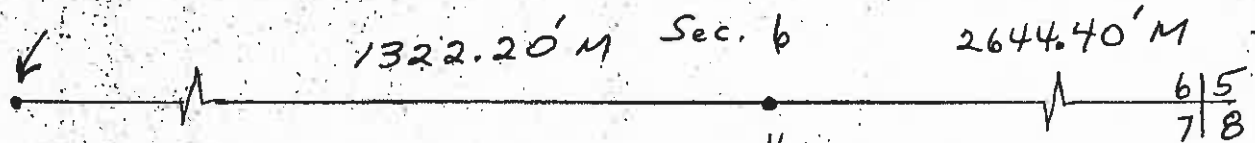

1/2" steel pipe Buried 4" in County Road

Surveyor's Seal

I, _____ certify that the information shown herein is true and correct.

Signature of Ground Party Chief

I, Christopher Balstad Jr. certify that I have carefully performed or reviewed the work done on the diagrammed corner as reported on this recordation form and approve the same.

DIAGRAM OF CORNER:

21-19

