

CERTIFIED LAND CORNER RECORDATION

DESCRIPTION OF CORNER EVIDENCE FOUND, AND ORIGINAL RECORD (IF KNOWN)

RECORD: (1905 GLO) Set a slate stone 16 X 14 X 10 ins., 11 ins. in the ground for 1/4 sec. cor. marked 1/4 on W. face; Dig pits 18 X 18 X 12 ins. N. and South of stone, 3 ft. dist.; and raise a mound of earth 3 1/2 ft. base, 1 1/2 ft. high W. of stone.

FIND: No original evidence found.

DESCRIPTION OF MONUMENT AND ACCESSORIES ESTABLISHED TO PERPETUATE THE ORIGINAL LOCATION OF THIS CORNER:

NOTE: From land use lines, set a 2" x 24" iron pipe with a 2 1/2 alum cap, marked as shown; located as shown.

Date of work: 2/80

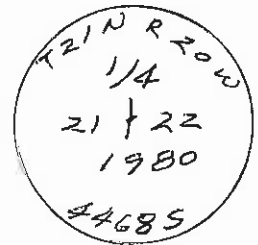
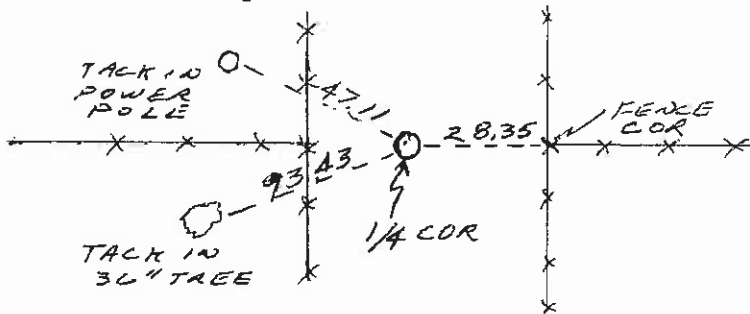

SKETCH, WITH COURSE AND DISTANCE TO ADJACENT CORNERS IF DETERMINED IN THIS SURVEY. (MAY SKETCH OR PASTE REPRODUCTION ON REVERSE SIDE.)

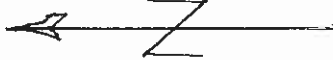

Surveyor's Seal

I, Edward Fleming, certify that the information shown herein is true and correct.

Signature of Ground Party Chief: Edward Fleming

I, Thomas P. McCarthy, certify that I have carefully performed or reviewed the work done on the diagrammed corner as reported on this recordation form and approve the same.

Signature of Surveyor: Thomas P. McCarthy

4468 S Registration Number

DIAGRAM OF CORNER:

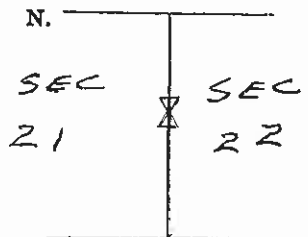

T. 21 N., R. 20 W.

Corner symbol = Corner recorded on the sheet

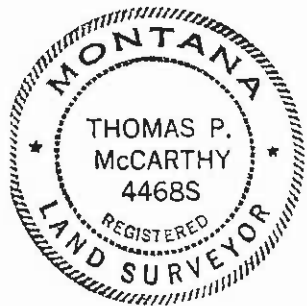

County Clerk and Recorder, County of Lake, State of Montana

"corner record" was filed for record on the 9th day of JULY 1980 at 4:14 P. M.

File No. 255770 in book No. C-1052

Ethel M. Harding, Lake County Clerk & Recorder By: [Signature] Deputy County Official