

CERTIFIED LAND CORNER RECORDATION

208570

DESCRIPTION OF CORNER EVIDENCE FOUND, AND ORIGINAL RECORD (IF KNOWN)

At the 1/4 corner between Sections 6 and 7, T.23N., R.19W., P.M.M., Lake County, Montana, We found a stone in place mounded with rocks on a fence line. We have no record on this corner.

DESCRIPTION OF MONUMENT AND ACCESSORIES ESTABLISHED TO PERPETUATE THE ORIGINAL LOCATION OF THIS CORNER:

Date of work: May, 1970

To perpetuate this corner we established the following RM's.

A fir-12" in diameter-S.17°W., 27.3' distant

A pine-14" in diameter-N.18°E., 56.6' distant

(Variance used- 20° West)

SKETCH, WITH COURSE AND DISTANCE TO ADJACENT CORNERS IF DETERMINED IN THIS SURVEY. (MAY SKETCH OR PASTE REPRODUCTION ON REVERSE SIDE.)

"SEE OFFICIAL PLATS OF MELIETT POINT AND MELIETT POINT NO.2 ON FILE IN THE LAKE COUNTY, MONTANA COURTHOUSE FOR ADDITIONAL INFORMATION REGARDING THIS CORNER"

Surveyor's Seal

Elden Inabnit

I, Elden Inabnit certify that the information shown herein is true and correct.

Signature of Ground Party Chief

Richard A. Ainsworth

I, Richard A. Ainsworth certify that I have carefully performed or reviewed the work done on the diagrammed corner as reported on this recordation form and approve the same.

Signature of Surveyor

2923S

Registration Number

DIAGRAM OF CORNER:

N.

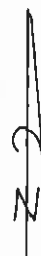

T23N

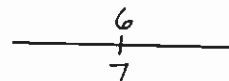

R19W

= Corner recorded on the sheet

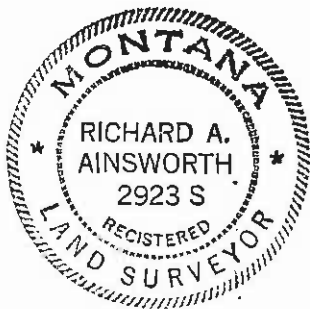

MAR 5 1973

Office of Clerk and Recorder, County of Lake

This "corner record" was filed for record on the MAR 21 1973 day of 11:50 a.m. 1973 was noted on the cross-index plat and is

assigned page No. C-346, in book No.

ETHEL M. HARDING

County Official

Cross Index No. E-3 T. 23N R. 19W Mer.