

CERTIFIED LAND CORNER RECORDATION

DESCRIPTION OF CORNER EVIDENCE FOUND, AND ORIGINAL RECORD (IF KNOWN)

Record - June 12, 1905 from Book 4598, GLO records.

A bearing trees recorded, 3 of which there is no evidence.

Found: a very decayed 10" stump with decayed bark & wood surrounding it, with a sliver of charred wood showing 58 BT

Record: A Fir, 7 ins. dia., bears N. 15° E., 54 Lks. dist., marked T 23 N R 19 W 58 BT.

DESCRIPTION OF MONUMENT AND ACCESSORIES ESTABLISHED TO PERPETUATE THE ORIGINAL LOCATION OF THIS CORNER:

Set 1/2" rebar at 36 feet S 15° W from the above record stump. Date of work: July 5, 1978.

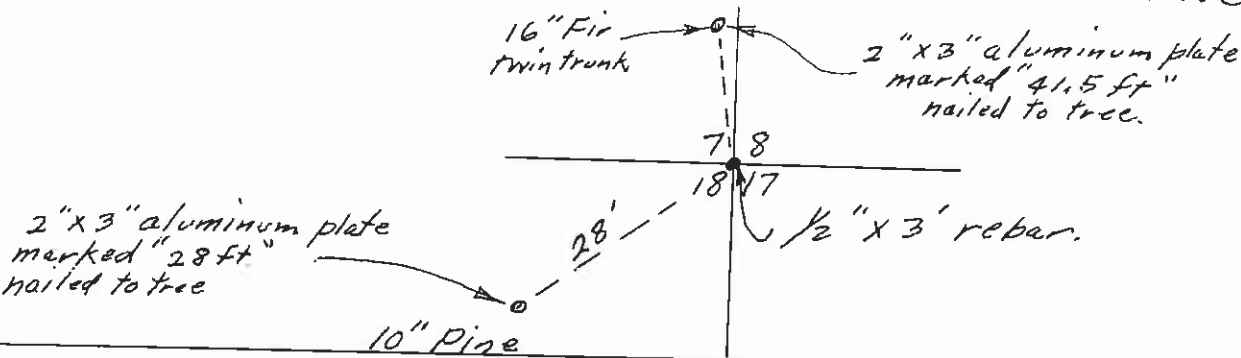

SKETCH, WITH COURSE AND DISTANCE TO ADJACENT CORNERS IF DETERMINED IN THIS SURVEY. (MAY SKETCH OR PASTE REPRODUCTION ON REVERSE SIDE.)

Surveyor's Seal

I, _____ certify that the information shown herein is true and correct.

Signature of Ground Party Chief

I, John E. Owens certify that I have carefully performed or reviewed the work done on the diagrammed corner as reported on this recordation form and approve the same.

J. Owens
Signature of Surveyor

DIAGRAM OF CORNER:

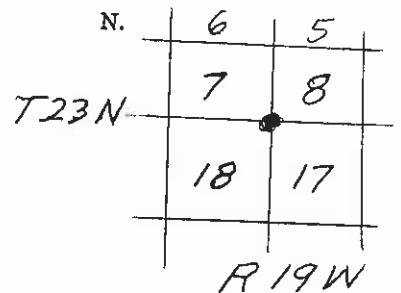

= Corner recorded on the sheet

25625
Registration Number

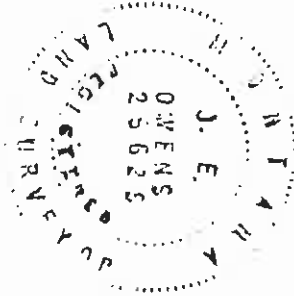

ice of Clerk and Recorder, County of Lake, State of Montana

3 "corner record" was filed for record on the 10th day of July, 1978, at 4:15 P.M., was noted on the cross-index plat and is

signed page No. 24242A in book No. C-807

ETHEL M. HARDING, CLERK & RECORDER
County Official
By: Rosanne Hartsock, Deputy
Mer.

Cross Index No. J-5 T. _____ R. _____ Mer. _____