

CERTIFIED LAND CORNER RECORDATION

DESCRIPTION OF CORNER EVIDENCE FOUND, AND ORIGINAL RECORD (IF KNOWN)

RECORD: Set a trap rock, 18x6x5 inches, 12 inches in the ground, for the corner of sections 13,18,19, and 24, marked with 3 notches on N. and S. edges; and raised a mound of stone, 2 feet base, 1 1/2 feet high, W. of corner. Pits impracticable.

FOUND: We searched area and could not find evidence of original stone or pits. The corner falls in the R/W of county road and was torn out when road was built. We position the corner by single proportion on the range line.

DESCRIPTION OF MONUMENT AND ACCESSORIES ESTABLISHED TO PERPETUATE THE ORIGINAL LOCATION OF THIS CORNER:

Date of work: 4-18-79

TO PERPETUATE THIS CORNER WE: Set a 2"x30" iron pipe with a 2 1/2" brass cap, from which:

- A power pole PPL 2320 PPL bears N.84°00'E., 209.05'
- A power pole PPL 180936 PPL bears N.80°00'W., 72.64'
- A 6"x6" post at fence corner bears S.01°00'W., 68.15'

SKETCH, WITH COURSE AND DISTANCE TO ADJACENT CORNERS IF DETERMINED IN THIS SURVEY. (MAY SKETCH OR PASTE REPRODUCTION ON REVERSE SIDE.)

PAT OF JETTE MEADOWS PHASE I.
See Certificate of Survey No. _____

DIAGRAM OF CORNER:

Surveyor's Seal

I, Gerald McCarthy certify that the information shown herein is true and correct.

Gerald M^cCarthy
Signature of Ground Party Chief

I, Thomas M. Hanson certify that I have carefully performed or reviewed the work done on the diagrammed corner as reported on this recordation form and approve the same.

Thomas M. Hanson
Signature of Surveyor

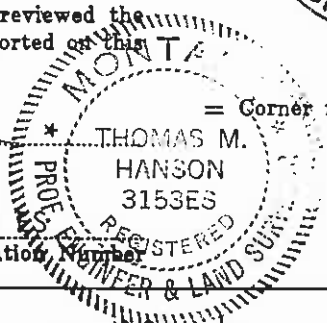
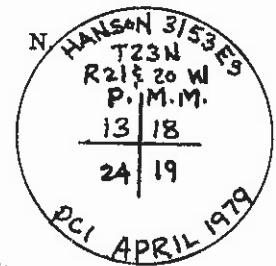

= Corner recorded on the sheet

Office of Clerk and Recorder, County of Lake State of Montana
his "corner record" was filed for record on the 24th day of July 1979, at 10:36 o'clock AM.
Assigned page No. 249542, in book No. C-901
By: ETHEL M. HARDING, CLERK & RECORDER
By: Roxanne Hartsoch, Deputy County Official

Cross Index No. N-1 T. 23N R. 20W Mer. 21W