

CERTIFIED CORNER RECORDATION

Corner North Quarter Corner, Section 16 T. 24 N. R. 19 W. P.M.M. Lake County

1905 Original General Land Office record by Willard M. Trippet, Book 4600 Page 23:

"Set a slate stone, 14x10x10 ins., 10 ins. in the ground, for 1/4 sec. cor., marked 1/4 on N. face; from which

A fir, 9 ins. dia., bears N.40°W., 50 lks. dist., marked 1/4 S 9 B T.

A pine, 30 ins. dia., bears S.33°W., 57 lks. dist., marked 1/4 S 16 B T."

2003 remonumentation by Jane L. Eby 8694ES:

Found a 1 1/4" outside diameter steel pipe, set firmly in the ground, with the fractured remains of the original General Land Office stone lying alongside. From which:

A Douglas fir snag, 15 inches diameter, bears N. 40° W. 33.1 feet distant, with visible scribing on face.

In the center of the steel pipe, I set a 5/8" diameter rebar, 24 inches long, 24 inches in the ground, with a 3 1/4 inch diameter aluminum cap, marked as shown, set in a 1.5 foot diameter stone collar.

From which I establish 2 new bearing trees:

A Douglas fir, 6 inches diameter, bears N. 45° E., 12.5 feet distant, scribed "1/4 S9 BT"

A Douglas fir, 17 inches diameter, bears S. 62° E., 30.7 feet distant, scribed "1/4 S16 BT".

I placed the remains of the fractured original stone in the stone collar, north of the new monument.

I paint the blazes and faces red on the new bearing trees and attach Land Survey Monument signs to both new bearing trees.

All distances measured with steel tape. All bearings measured with Silva hand compass, 18' east magnetic declination.

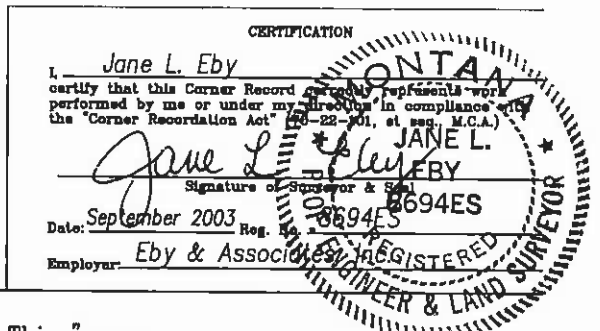
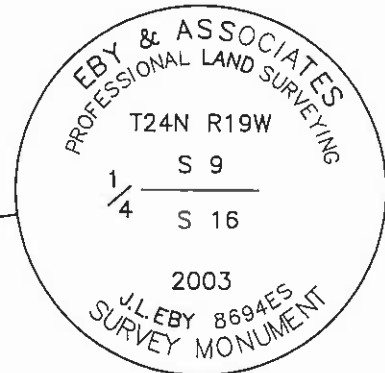
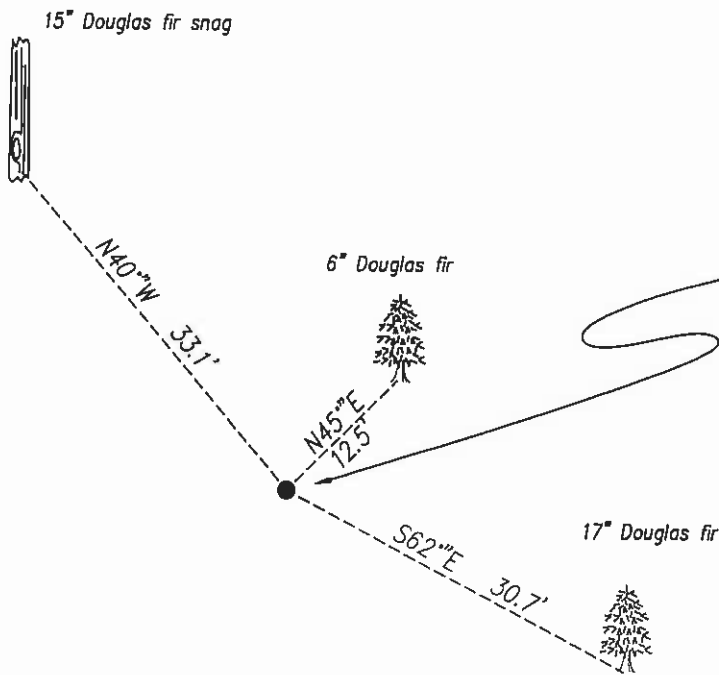

Office of Clerk and Recorder, County of Lake. This "corner record" was filed for record on FEB 10 2004 1:07 pm 444983

was noted on the cross-index plat and is assigned page No. _____, in

book No. _____ RUTH E. HODGES by Judy Muniz County Official

02544

Cross Index No. J-11 T. 24 N R. 19 W PMM

Sec. 16

Adopted July 1, 1981, Montana Board of Professional Engineers & Land Surveyors

• corner this sheet