

INSTRUCTIONS

1. Original and/or subsequent record used to evaluate the corner position.
2. Description of evidence found, note discrepancies in the record, state method of establishing lost or obliterated corners.
3. Description of monument and accessories set to perpetuate the corner position.
4. Sketch of corner, show all pertinent data which can best be shown in a sketch example, corner marking, topography ties, position of accessories, etc.
5. Certification must be signed and sealed by Land Surveyor registered in the State of Montana.
6. Fill in Cross Index & Section Diagram at bottom of sheet.

CERTIFIED CORNER RECORDATION

Corner NE COR SECTION 28 T. 25 N R. 20 W P.M.M. LAKE County

RECORD: SET A LIMESTONE 15 x 10 x 6 ins., 10 ins. IN THE GROUND, FOR COR. TO SECS. 21, 22, 27 & 28, MARKED WITH 2 NOTCHES ON THE SOUTH AND 3 NOTCHES ON THE EAST EDGES FROM WHICH:

- A PINE, 8 ins. DIA., BEARS N 79° E 54 IKS.
- A PINE, 26 ins. DIA., BEARS S 26° E 104 IKS.
- A PINE, 40 ins. DIA., BEARS S 70° W 21 IKS.
- A PINE, 7 ins DIA., BEARS N 17° W 48 IKS.

FOUND: - ORIGINAL STONE WITH A CROSS IN TOP CENTER.
 - THE ^{ORIGINAL} NW B.T. LAYING OVER, "BT" SCRIBING PLAINLY VISIBLE.
 - AN AXEL HUB, THE CENTER OF WHICH IS 0.45' NORTH OF CROSS IN THE FOUND STONE.
 - FOUND ^{RECENT} B.T.'S SCRIBED "RM" WITH B.T. TAGS ON THE TREES BUT NO INFORMATION ON THE B.T. TAGS. THE TREES HAVE BEEN SCRIBED A NUMBER OF YEARS AGO, BEING THEY ARE STARTING TO OVERGROW THE SCRIBING.

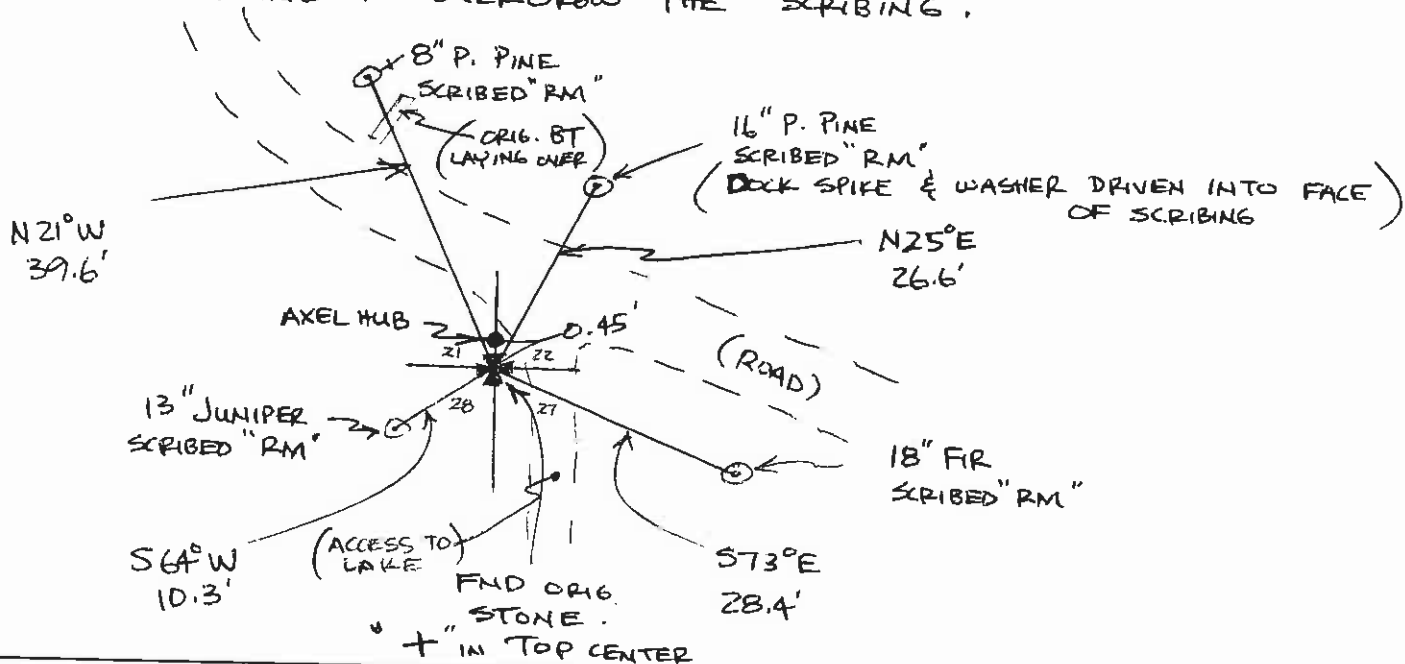

SKETCH OF CORNER

CERTIFICATION
 I, DANIEL P. BRIEN
 certify the information shown herein is true and correct.
Daniel P. Brien
 Signature Ground Party Chief
 I, DANIEL P. BRIEN
 certify that this Corner Record correctly represents work performed by me or under my direction in compliance with the "Corner Recordation Act" (70-22-101, et seq., M.C.A.)
Daniel P. Brien
 Signature of Surveyor & Seal
 Date: 3/8/85 Reg. No. 76815
 Employer: HERSMAN LAND SURVEY

Office of Clerk and Recorder, County of Lake, State of Montana. This "corner record" was filed for record on April 20, 1987 at 2:56 P.M.

was noted on the cross-index plat and is assigned Microfile No. 304918, in

File No. C-1534

n/c

LORIN JACOBSON

By Baranne Cooper, Deputy
 County Official
 R 13 T. 25 N R. 20 W P.M.M.

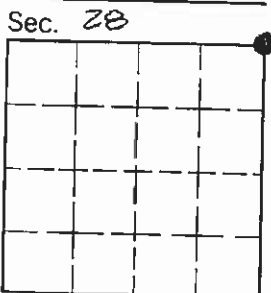

• - corner this sheet