

CERTIFIED LAND CORNER RECORDATION

218336

DESCRIPTION OF CORNER EVIDENCE FOUND, AND ORIGINAL RECORD (IF KNOWN)

Original record: Set a trap stone, 20x16x8 inches, 15 inches in the ground, for $\frac{1}{4}$ sec. Cor. marked $\frac{1}{4}$ on N face, from which a Pine 14 inches in dia. bears S37 $\frac{1}{2}$ °E 17 lks. marked $\frac{1}{4}$ SBT. A pine 10 inches dia m. bears N57°W 47 lks. dist. marked $\frac{1}{4}$ SBT. I found the bearing trees as above, The northwest is alive the southeast a cut stump. I couldnot find the original stone. I reset the corner by using both of the found bearing trees. I scribed two new bearing trees as shown below.

DESCRIPTION OF MONUMENT AND ACCESSORIES ESTABLISHED TO PERPETUATE THE ORIGINAL LOCATION OF THIS CORNER:

Date of work: 6/29/74

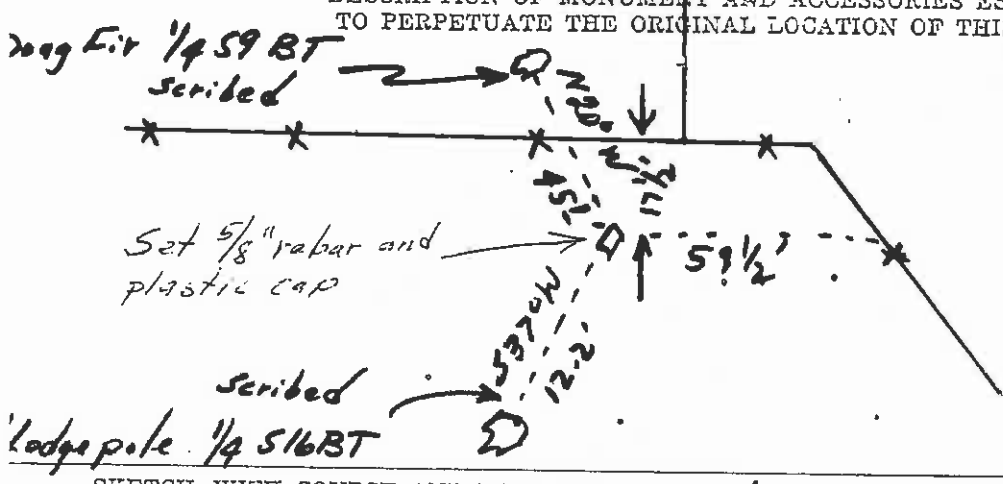

SKETCH, WITH COURSE AND DISTANCE TO ADJACENT CORNERS IF DETERMINED IN THIS SURVEY. (MAY SKETCH OR PASTE REPRODUCTION ON REVERSE SIDE.)

Sec Certificate of survey #2293

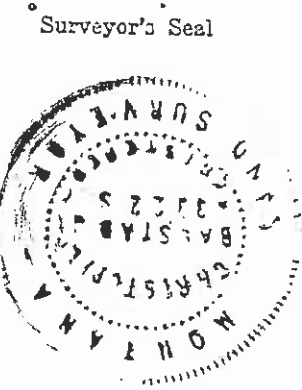

I, _____
 certify that the information shown herein is true and correct.

Signature of Ground Party Chief

I, Christopher Balstad Jr.
 certify that I have carefully performed or reviewed the work done on the diagrammed corner as reported on this recordation form and approve the same.

Christopher Balstad Jr.
 Signature of Surveyor

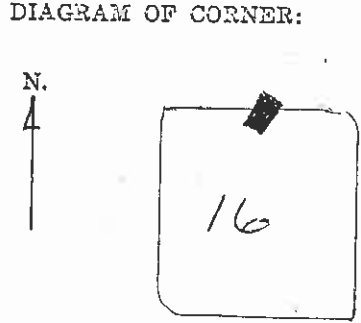

◆ Corner recorded on the sheet

33225
 Registration Number

of Clerk and Recorder, County of Lake

corner record" was filed for record on the AUG 19 1974 day of 3:40 P.M. 1974, was noted on the cross-index plate and is on page No. _____, in book No. C-517

ETHEL M. HARDING
 County Official

Cross Index No. J-11 T. 25 N. 22 W.