

INSTRUCTIONS

1. Original and/or subsequent record used to evaluate the corner position.
2. Description of evidence found, note discrepancies in the record, state method of establishing lost or obliterated corners
3. Description of monument and accessories set to perpetuate the corner position.
4. Sketch of corner, show all pertinent data which can best be shown in a sketch example, corner marking, topography ties, position of accessories, etc.
5. Certification must be signed and sealed by Land Surveyor registered in the State of Montana.
6. Fill in Cross Index & Section Diagram at bottom of sheet.

CERTIFIED CORNER RECORDATION

Corner 1/4 Sec. 11/Sec. 12 T. 25 N. R. 22 W. P.M.M. Lake County

RECORD: from G.L.O. Field Book 3208, page 17, surveyed by C. Smith in 1897

Set a trap stone, 20"x 8"x 7", 15" in the ground, marked 1/4 on west face, from which:

- a 15" pine bears S77°E 45 lks. (29.7')
- a 20" fir bears S39°45'W 24 lks. (15.8')

FOUND:

Stone 6" x 10" x 8" out of ground with 1/4 on west face

- a 4" I.D. pipe bears SE 0.5'
- both orig. BT's destroyed

SET: Held position of "+" in top of found stone, painted the stone orange, from which:

- a 14" fir bears N87°W 10.2' scribed "RM" and painted orange, set yellow plastic MARLS tag on tree
- a 12" fir bears S2°E 11.1' scribed "RM" and painted orange, set yellow plastic MARLS tag on tree

Used a SILVA hand compass (declination 18° E)

See C.O.S. 5337

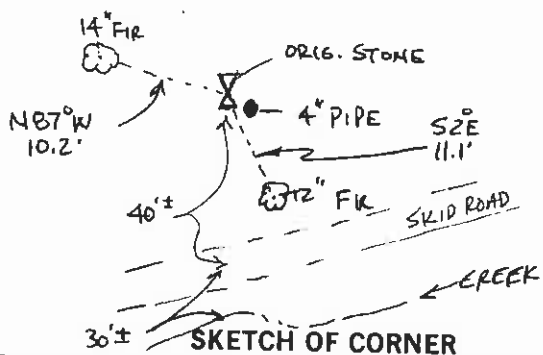

CERTIFICATION MONTANA

I, DANIEL P. BRIEN
 certify the information shown herein is true and correct.

Signature Ground Party Chief
DANIEL P. BRIEN

I, DANIEL P. BRIEN
 certify that this Corner Record correctly represents work performed by me or under my direction in compliance with the "Corner Recordation Act" (70-2-101, et seq. M.C.A.)

Signature of Surveyor & Seal
[Signature]

Date: 6/10/97 Reg. No. 76815
 Employer: Hersman Land Survey

Office of Clerk and Recorder, County of LAKE. This "corner record" was filed for record on JUL 17 1997 3:40 pm
 was noted on the cross-index plat and is assigned

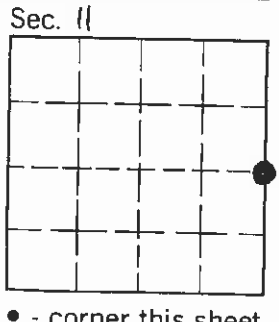

383269
-2134 Jeg/c
RUTHE HODGES
 County Official
 Cross Index No. G-21 T. 25 N. R. 22 W. P.M.M.