

INSTRUCTIONS

1. Original and/or subsequent record used to evaluate the corner position.
2. Description of evidence found, note discrepancies in the record, state method of establishing lost or obliterated corners.
3. Description of monument and accessories set to perpetuate the corner position.
4. Sketch of corner, show all pertinent data which can best be shown in a sketch example, corner marking, topography (les, position of accessories, etc.
5. Certification must be signed and sealed by Land Surveyor registered in the State of Montana.
6. Fill in Cross Index & Section Diagram at bottom of sheet.

CERTIFIED CORNER RECORDATION

S 9	S10
S16	S15

Corner _____ T. 26 N., R. 19 W., P.M.M. LAKE _____ County

RECORD 1 General Land Office original survey by G. Reeder and C. Helmick, 1892. Set a stone and marked 4 bearing trees.

RECORD 2 General Land Office retracement by P. Sweeney and R. Lyman, 1912. Found stone marked and and witnessed as described by the surveyor general.

RECORD 3 Certified Land Corner Recordation by Stanley J. Skousen, 2532S, 1973: "DESCRIPTION OF CORNER EVIDENCE FOUND, AND ORIGINAL RECORD (IF KNOWN): None found-- destroyed by Crane Mountain road. Set corner by single proportion based on a subtense traverse between 1/4, 9/16, and 1/4 ¹⁰/₁₅ both of which are originals in place with accessories.
Corner falls on blazed east-west line.

DESCRIPTION OF MONUMENT AND ACCESSORIES ESTABLISHED TO PERPETUATE THE ORIGINAL LOCATION OF THIS CORNER: Drove a 1/2-inch rebar flush with ground near east edge of road.
A 5/8-inch rebar already in existence bears S. 89° 06' E. and 91.04 feet.
A 5/8-inch rebar already in existence bears S. 85° 50' W. and 19.70 feet."

RECORD 4 Certificate of Survey No. 2744 by C.W. Doyle, 2516S: "FND 1/2" I.P."

RECORD 5 Certificate of Survey No. 3028 by C.W. Doyle, 2516S: " FND 1/2" REBAR"

RECORD 6 Certificate of Survey Nos. 4292 and 4327 by Daniel Brien, 7681S: "Fnd. 3/8" Rebar per Skousen Record"

RECORD 7 Certified Corner Recordation by D. Brien, 7681S, 1990:

"RECORD: See Corner Record filed by Skousen 2532 S, date of work 5/19/71
FOUND: 3/8" rebr down 0.4' on west edge of Cran Mt. Road, see diagram below.
SET: Nothing further set

REFERENCE: C.O.S. # 4292..." Includes sketch of references

FOUND
A 1/2 inch rebar, slightly bent over and 6" below the ground level, in the west edge of the Crane Mountain Road. From which:
A 5/8 inch diam. rebar brs. S 89° E. a distance of 91.0 ft. (origin unknown)
A 5/8 inch diam. rebar with a yellow plastic stamped DOYLE 2516S, brs. S 89° W., a distance of 19.7 ft. (set on C.O.S. No. 3028)

A 4 inch by 4 inch concrete post brs. West 29.8 ft.
A 4 inch by 4 inch concrete post brs. East 60.2 ft.
SET
We replace the found rebar with an aluminum pipe, 2 1/2 inches in diameter, 30 inches long, 6 inches below the road surface, with a 3 1/4 in. diameter aluminum cap marked as shown. The found rebar is placed inside the aluminum pipe. From which the following new bearing trees are established:

- A larch, 16 inches dbh, bears N. 29° E., 68.3 feet distant, blazed and scribed "T26NR19WS10BT"
- A lodgepole pine, 5 inches dbh, bears S. 60° E., 102.5 feet distant, blazed and scribed "X BT"
- A lodgepole pine, 9 inches dbh, bears S. 39° W., 17.7 feet distant, blazed and scribed "T26NR19WS6BT"

A cedar, 14 inches dbh, bears N. 87° W., 32.3 feet distant, blazed and scribed "T26NR19WS9BT"
Measurements were made with a Silva Ranger hand compass (declination 18° E.) and a steel tape to the center of the root crowns of all trees. Distances are horizontal.
We attached "BT" and "LAND SURVEY MONUMENT" signs to the BT's.

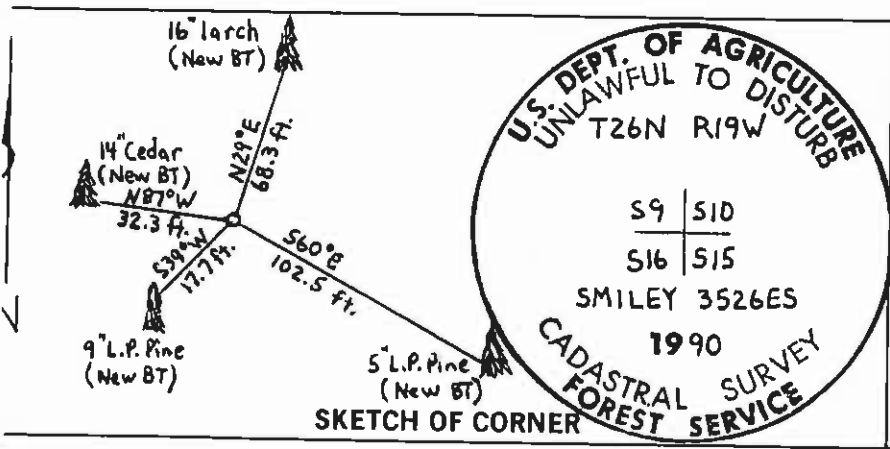

CERTIFICATION

I, Brian Thompson
certify the information shown herein is true and correct.

Signature Ground Party Chief _____

I, Daniel C. Smiley
certify that this Corner Record correctly represents work performed by me or under my direction in compliance with the "Corner Recordation Act" (70-22-101, et seq., M.C.A.)

Signature of Surveyor & Seal _____

Date 4/25/91 Reg. No. 3526ES
Employer: Flathead Nat'l Forest

Office of Clerk and Recorder, County of Lake. This "corner record" was filed for record on APR 29 '91 at 1:52 pm was noted on the cross-index plat and is assigned 330117, in Q-1832 RUTH E. HODGES County Official

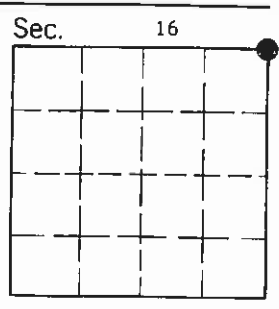

By: Geedy Ann Allen
N/C
Adopted July 1, 1981, Montana Board of Professional Engineers & Land Surveyors

Cross Index No. J-13 T. 26 N. R. 19 W. P.M.M.

• - corner this sheet