

INSTRUCTIONS

1. Original and/or subsequent record used to evaluate the corner position.
2. Description of evidence found, note discrepancies in the record, state method of establishing lost or obliterated corners.
3. Description of monument and accessories set to perpetuate the corner position.
4. Sketch of corner, show all pertinent data which can best be shown in a sketch example, corner marking, topography ties, position of accessories, etc.
5. Certification must be signed and sealed by Land Surveyor registered in the State of Montana.
6. Fill in Cross Index & Section Diagram at bottom of sheet.

**CERTIFIED CORNER RECORDATION**

Corner  $\frac{1}{4}$   $\frac{6}{7}$  T. 28N R. S6E P.M.M. ROOSEVELT County

ORIGINAL RECORD: SET A GRANITE STONE 15X10X6 INS. 10 INS. IN  
 (WILFRED B. HELM) THE GROUND - MARKED  $\frac{1}{4}$  ON N. FACE AND RAISE  
 1907 A MOUND OF STONE 2 FT BASE  $1\frac{1}{2}$  FT HIGH N. OF  
 CORNER. TOP OF SPUR BEARS N+S DESCEND 75 FT

SUBSEQUENT RECORD: NONE FOUND

EVIDENCE FOUND : ON TOP OF SPUR, FIND  $1\frac{1}{2}$  OD PIPE. PROJECTS  
 0.5 FOOT ABOVE GROUND. NO RECORD OF PIPES  
 ORIGIN WAS FOUND, BUT IT FITS TO ADJACENT  
 CORNERS. NO EVIDENCE OF ORIGINAL STONE.

PERPETUATION : PIPE IS IN GOOD CONDITION. LEFT IN PLACE  
 AND MADE REFERENCES AS SHOWN.

FEE: \* \$0.00

BEARING AND DIST SHOWN  
 ARE BASED ON MT STATE  
 PLANE. TO CONVERT  
 DIST. SHOWN TO GROUND  
 DIVIDE BY A CAF OF 0.999499  
 TIED TO HARN STATION Mc CABE  
 NAD 83 (1999)

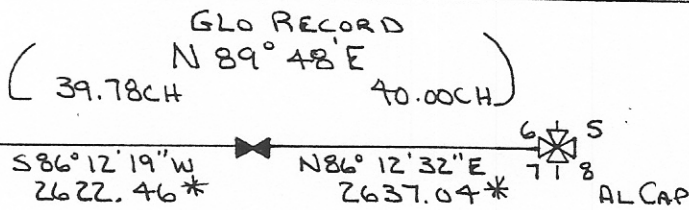
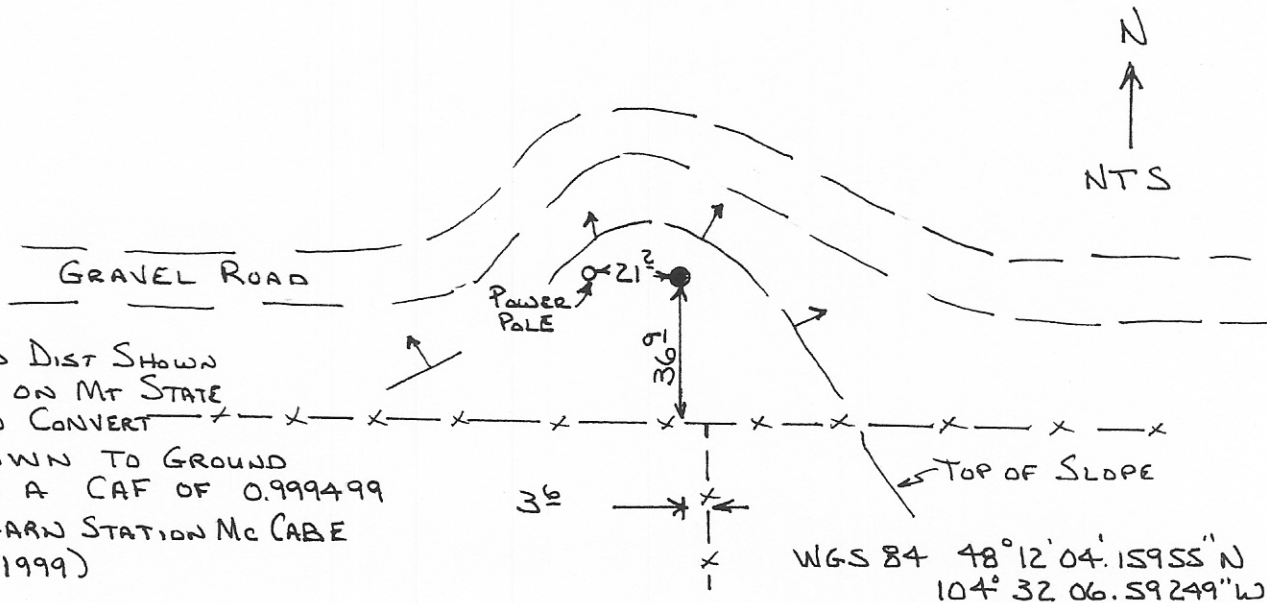

SKETCH OF CORNER

CERTIFICATION  
 I, Steve Borth  
 certify the information shown herein is true and correct.

Steve Borth  
 Signature Ground Party Chief

I, SCOTT BLOOMERADER  
 certify that this Corner Record correctly represents work performed  
 by me or under my direction in compliance with the "Corner  
 Recordation Act" (70-22-101, et seq., M.C.A.)

Scott Bloomerader  
 Signature of Surveyor & Seal

Date: 9/10/2002 Reg. No. 9005 LS

Employer: HKM ENGINEERING INC Billings  
 MT

Office of Clerk and Recorder, County of \_\_\_\_\_ . This "corner  
 record" was filed for record on \_\_\_\_\_  
 was noted on the cross-index plat and is assigned page No. \_\_\_\_\_ , in  
 book No. \_\_\_\_\_

County Official

Cross Index No. E-3 T. 28N R. S6E P.M.M.

Sec. 6 - T28N-RS6E

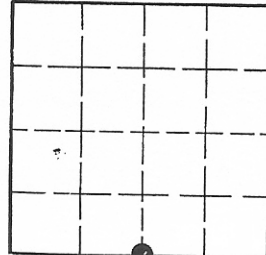

• - corner this sheet

RECORDED: 09/23/2002 9:00 COR RECORD CLERK AND RECORDER BY: Cheryl Hansen

M3