

CR# 849

330423

INSTRUCTIONS

1. Original and/or subsequent record used to evaluate the corner position.
2. Description of evidence found, note discrepancies in the record, state method of establishing lost or obliterated corners.
3. Description of monument and accessories set to perpetuate the corner position.
4. Sketch of corner, show all pertinent data which can best be shown in a sketch example, corner marking, topography ties, position of accessories, etc.
5. Certification must be signed and sealed by Land Surveyor registered in the State of Montana.
6. Fill in Cross Index & Section Diagram at bottom of sheet.

CERTIFIED CORNER RECORDATION

Corner C 1/4 Section 21 T. 30N R. 29E P.M.M. PHILLIPS County

Found 2" Iron Pipe, 75 Feet South of Fence Parallel to Highway, Buried 12" Below Surface.

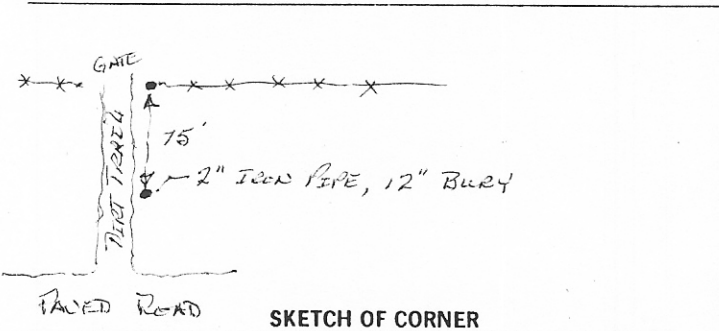

CERTIFICATION

I, _____
 certify the information shown herein is true and correct.

Signature Ground Party Chief
 I, MIKE KAISER

certify that this Corner Record correctly represents work performed by me or under my direction in compliance with the "Corner Recordation Act" (70-22-101, et seq., M.C.A.)

Michael Kaiser
 Signature of Surveyor & Seal

Date: 31 MARCH Reg. No. 1006745

Employer: KAISER

Office of Clerk and Recorder
 record" was filed for reco
 was noted on the cross-inc
 book No. _____

330423 B-CR P-0849
 PHILLIPS COUNTY MONTANA Fee \$.00
 Filed 05/07/2004 At 12:40 PM
 Laurel N Hines, Clerk and Recorder
 By Laurel N Hines, Deputy

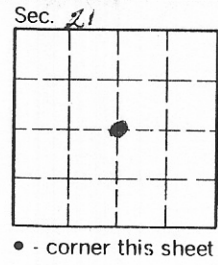

County Official
 Cross Index No. P-11 T. _____ R. _____ P.M.M.