

INSTRUCTIONS

1. Original and/or subsequent record used to evaluate the corner position.
2. Description of evidence found, note discrepancies in the record, state method of establishing lost or obliterated corners.
3. Description of monument and accessories set to perpetuate the corner position.
4. Sketch of corner, show all pertinent data which can best be shown in a sketch example, corner marking, topography ties, position of accessories, etc.
5. Certification must be signed and sealed by Land Surveyor registered in the State of Montana.
6. Fill in Cross Index & Section Diagram at bottom of sheet.

CERTIFIED CORNER RECORDATION

Corner 1/4 COR SECS 7 & 8 T. 33N., R. 6W., P.M.M. Glacier County

RECORD GLO
1907 Set a granite stone 14"x10"x5", 10" in the ground for 1/4 section corner, marked 1/4 on the West face. Dig pits 18"x18"x12" North and South of corner, 3' in distance. And raised a mound of earth, 3 1/2' base, 1 1/2' high, West of corner.

RECORD GLO
1922 Found a granite 4"x2"x1" above ground, marked and witnessed as described by the Surveyor General. West of stone, and 1/4 link distance, is an iron pipe, 2" in diameter, 10" above ground, for corner of allotments "770, 767, 2120 & 2122", with the numbers of the allotments stamped on the sides.

RECORD
G.G.DUBOIS
1999 Found a 2" iron pipe, no cap, buried 0.3' below ground, 6' south of an East/West canal, 10' North of fence corner North-South-East, in the North-South fence line. Stone not recovered. Uncover pipe, build 1' collar of stone, stake and flag area.

FOUND MDT
2000 Found 2" iron pipe flush with ground, approximately half-way up slope on the South side of irrigation ditch, running East/West. Pipe is 15.85' North of fence corner, of 4' high fence running South, North and East. Pipe is 7.55' South of gate post (for drop gate) at South top of bank of irrigation ditch.

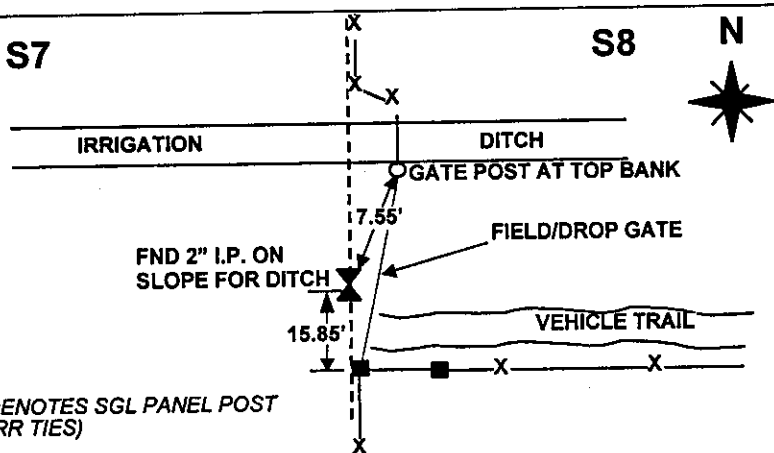

SKETCH OF CORNER

CERTIFICATION

I, Timothy A. Ferguson
certify the information shown herein is true and correct.

[Signature]
Signature of Ground Party Chief

I, Theodore M. Brown
certify that this Corner Record correctly conforms with
performed by me or under my direction in compliance with
the "Corner Recordation Act" (70-22501, et seq., MCA)

[Signature]
Signature of Surveyor & Seal

Date: 6/4/02 Reg. No. 11702LS

Employer: Montana Department of Transportation

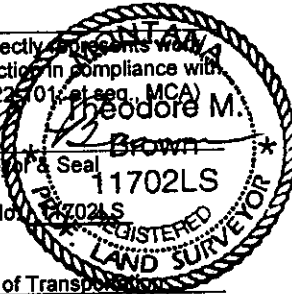

Office of Clerk and Recorder, County of Glacier. This "corner record" was filed for record on June 5, 2002, was noted on the cross-index plat, and is assigned Page No. _____, in Book No. Doc 250954

[Signature]
County Official

Sec. 8

● — Corner this sheet

Cross Index No. G-5 T. 33N., R. 6W., PMM

STATE OF MONTANA GLACIER COUNTY
RECORDED: 08/11/1999 10:23 BOOK: 54 MS
SYLVIA BERKRAM CLERK AND RECORDER BY:
CORNER RECORDATION FILE

DOC #: 245653

PAGE: 43

FEE: \$0.00

Loretta Torgerson

CERTIFIED CORNER RECORDATION

Corner 7 Secs 7/8 T. 33N. R. 6W. P.M.M. Glacier County

Record: (GLO 1922) "A granite stone, 4"x2"x1" above ground, marked & witnessed as described by the Surveyor General, west of stone, 1/4 link distant, is an iron pipe, 2" dia., 10 ins. above ground for allotments 770, 767, ~~2120~~, and 2122."

Found: A 2" iron pipe, no cap, buried 0.3 foot below ground, 6 feet south of an east-west canal, 10 feet north of a fence corner north-south-east, in the north-south fence line. Stone not recovered.

Set: Uncover pipe, build 1 foot collar of stone, stake and flag area.

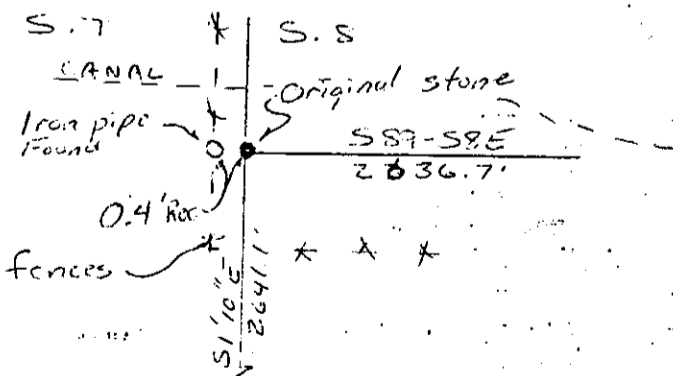
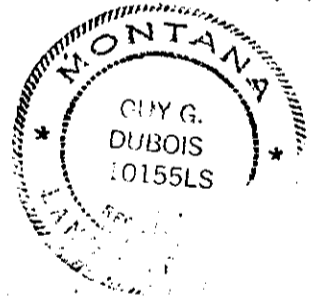

SKETCH OF CORNER

CERTIFICATION
I, *[Signature]*
certify the information shown herein is true and correct.
Signature Ground Party Chief
I, *[Signature]*
certify that this Corner Record correctly represents work performed by me or under my direction in compliance with the "Corner Recordation Act" (70-22-101, et seq., M.C.A.)
Signature of Surveyor & Seal
Date: 5-20-99 Reg. No. 10155LS
Employer: _____

Office of Clerk and Recorder, County of Glacier. This "corner record" was filed for record on 8-11-99 was noted on the cross-index plat and is assigned page No. _____, in book No. _____

Loretta Torgerson
County Official

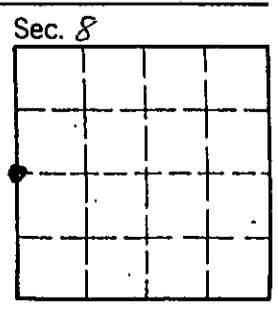

• - corner this sheet

Cross Index No. 6-5 T. 33 R. 6 P.M.M.