

CERTIFIED LAND CORNER RECORDATION

DESCRIPTION OF CORNER EVIDENCE FOUND, AND ORIGINAL RECORD (IF KNOWN)

From Book 1697, Page 12 (460): "Set basalt stone 18x14x10 ins. 12 ins. in the ground.....marked $\frac{1}{4}$ on W. face and raised a mound of stone alongside.

Found: Old post in cairn in basalt talus slope. Couldn't find original stone. Correlates closely with point shown on C/S 277.

DESCRIPTION OF MONUMENT AND ACCESSORIES ESTABLISHED TO PERPETUATE THE ORIGINAL LOCATION OF THIS CORNER:

Date of work: 4/4/81

SKETCH, WITH COURSE AND DISTANCE TO ADJACENT CORNERS IF DETERMINED IN THIS SURVEY. (MAY SKETCH OR PASTE REPRODUCTION ON REVERSE SIDE.)

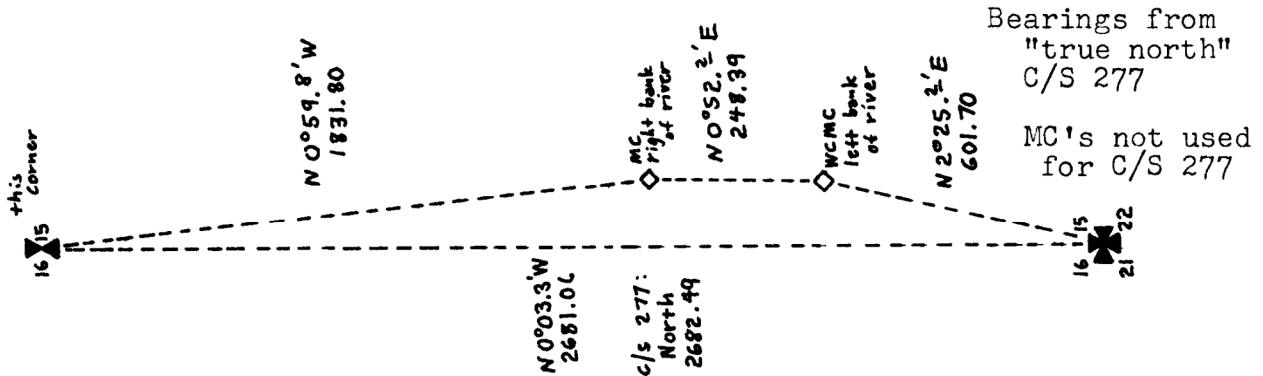

Surveyor's Seal



I,, certify that the information shown herein is true and correct.

Signature of Ground Party Chief

Henry A. Rate

I,, certify that I have carefully performed or reviewed the work done on the diagrammed corner as reported on this recordation form and approve the same.

Henry A. Rate
Signature of Surveyor

DIAGRAM OF CORNER:

N. T9S
R8E
MPM

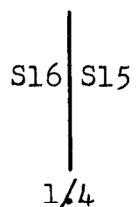

= Corner recorded on the sheet

3716S
Registration Number

168582

Office of Clerk and Recorder, County of Park

This "corner record" was filed for record on the 28th day of January, 1982, was noted on the cross-index plat and is assigned page No. 29, in book No. one @ 11:00 o'clock am Margaret Inouical
County Official

3 Form 125-7887 no fee

Cross Index No. L-13 T. 9 So. R. 8 E. Mer.