

CERTIFIED LAND CORNER RECORDATION

DESCRIPTION OF CORNER EVIDENCE FOUND, AND ORIGINAL RECORD (IF KNOWN)

From Book 1697, Page 12 (460): "Set granite stone 14x10x6 in., 9 in. in the ground..... marked MC and raised a mound of stone 2 ft. high, 4½ ft. base alongside....."

Found: Granite stone 10x6, 7 ins. out in mound of stone.
Marked "WCMC" on S. side.

DESCRIPTION OF MONUMENT AND ACCESSORIES ESTABLISHED TO PERPETUATE THE ORIGINAL LOCATION OF THIS CORNER:

Date of work: 3/24/80

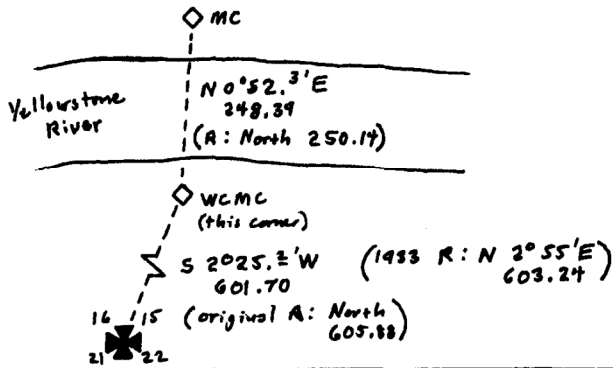

nothing done

Bearings from "true north", C/S 277

SKETCH, WITH COURSE AND DISTANCE TO ADJACENT CORNERS IF DETERMINED IN THIS SURVEY. (MAY SKETCH OR PASTE REPRODUCTION ON REVERSE SIDE.)

Surveyor's Seal

I, _____
certify that the information shown herein is true and correct.

Signature of Ground Party Chief

I, Henry A. Rate
certify that I have carefully performed or reviewed the work done on the diagrammed corner as reported on this recordation form and approve the same.

Henry A. Rate
Signature of Surveyor

DIAGRAM OF CORNER:

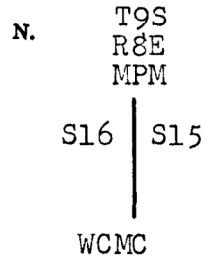

= Corner recorded on the sheet

3716S
Registration Number

Office of Clerk and Recorder, County of Park

168583

This "corner record" was filed for record on the 28th day of January, 1982, was noted on the cross-index plat and is assigned page No. 32, in book No. one

Form 125-7887 no fee

Margaret Monical
County Official
Cross Index No. M 1/2-13 T. 9 S. R. 8 E. Mer.