

INSTRUCTIONS

1. Original and/or subsequent record used to evaluate the corner position.
2. Description of evidence found, note discrepancies in the record, state method of establishing lost or obliterated corners.
3. Description of monument and accessories set to perpetuate the corner position.
4. Sketch of corner, show all pertinent data which can best be shown in a sketch example, corner marking, topography ties, position of accessories, etc.
5. Certification must be signed and sealed by Land Surveyor registered in the State of Montana.
6. Fill in Cross Index & Section Diagram at bottom of sheet.

CERTIFIED CORNER RECORDATION

Corner E 1/4 Cor. Sec. 16 T. 9 S. R. 8 E. P.M.M. Park County

1. In July 1883 U.S. Deputy Surveyor Rodney W. Page set a basalt stone 18"x14"x10" 12" in the ground for the 1/4 section corner between sections 15 and 16 marked 1/4 on west face and raised a mound of stone along side. Pits were impractical.
2. On a basalt talus slope I found an old post, located by Henry Rate and described on his certified land corner recordation form, book 1, page 29. Measuring to this post I found that the distance checked Rate's distance but did not fit G.L.O. distance. I then made a diligent search in the area and found a mound of stone and on the east edge of this mound I found a basalt stone marked 1/4 on the west face. Therefore, I accepted this evidence to be the same as described by R. W. Page in 1 above.
3. Paint original stone orange for easier identification and rebuild mound of stone.

Cut 4" cross on top of 4'x6' basalt boulder and paint cross orange. Cross bears N23°-29'W, 18.34'

Cut 3" cross on top of 3'x4' basalt boulder and paint cross orange. Cross bears S23°-32'W, 8.59'

Wood post bears N 35°44'W, 46.9'.

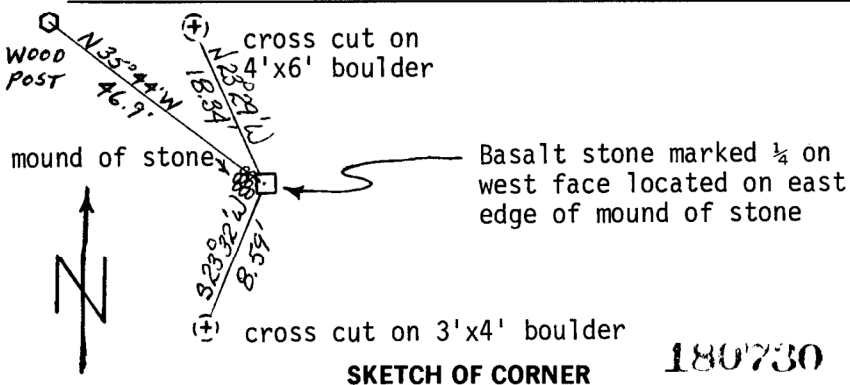

CERTIFICATION

I, Steven J. Barber
 certify the information shown herein is true and correct.
Steven J. Barber
 Signature of Ground Party Chief

I, Michael D. Weldon
 certify that this corner record correctly represents work performed by me or under my direction in compliance with the "Corner Recordation Act" (M.C.A. 82-101, et seq., M.C.A.)
Michael D. Weldon
 Signature of Surveyor & Seal

Date: 2/18/84 Reg. No. 7692 S
 Employer: U.S. Forest Service

Office of Clerk and Recorder, County of Park. This "corner record" was filed for record on June 11, 1984 @ 12:10 P.M. was noted on the cross-index plat and is assigned page No. 68, in book No. one
James Jennings
 County Official
 No Fee

