

INSTRUCTIONS

1. Original and/or subsequent record used to evaluate the corner position.
2. Description of evidence found, note discrepancies in the record, state method of establishing lost or obliterated corners.
3. Description of monument and accessories set to perpetuate the corner position.
4. Sketch of corner, show all pertinent data which can best be shown in a sketch example, corner marking, topography ties, position of accessories, etc.
5. Certification must be signed and sealed by Land Surveyor registered in the State of Montana.
6. Fill in Cross Index & Section Diagram at bottom of sheet.

CERTIFIED CORNER RECORDATION

Corner MC to Frac. Sec. 15 and 16 T. 9 S. R. 8 E. P.M.M. Park County

1. In July 1883, U.S. Deputy Surveyor Rodney W. Page set on the right bank of the Yellowstone River a sandstone 18"x14"x6" about 12" in the ground for a meander corner to fractional section 15 and 16 marked MC and raised a mound of stone 2' high and 1½' base along side. Pits were impractical.

In 1981 Surveyor Henry A. Rate found a granular granite stone 15"x12"x6" marked "MC" on the north side, leaning south. He straightened and reset the stone more firmly, then rebuilt cairn. Refer to Corner Recordation on file, book 1, page 32.

2. Found granular granite stone 15"x12"x6" marked "MC" on north side. Accepted same as original meander corner set by Page in 1883 and located in 1981 by Rate.
3. Replace granite stone marked "MC" with 2½"x30" aluminum pipe set 26" in the ground with 3¼" aluminum cap marked as indicated below. Rebuild mound of stone on west edge of aluminum monument and place original "MC" stone alongside **underground.**

Set 5/8"x24" rebar w/aluminum cap marked RM 1, which bears S80°-17'W, 20.61'

Set 5/8"x24" rebar with aluminum cap marked RM 2, which bears N43°-37'W, 24.96'

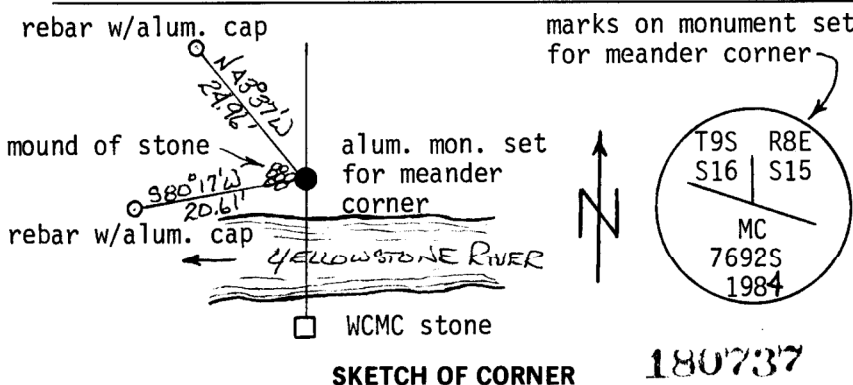

CERTIFICATION

I, Steven J. Barber
certify the information shown herein is true and correct.
Steven J. Barber
Signature Ground Party Chief

I, Michael D. Weldon
certify that this Corner Record correctly represents work performed by me or under my direction in compliance with the "Corner Recordation Act" (70-101, et seq., M.C.A.)
Michael D. Weldon
Signature of Surveyor & Seal

Date: 2/84 Reg. No. 7692 S
Employer: U.S. Forest Service

Office of Clerk and Recorder, County of Park. This "corner record" was filed for record on June 11, 1984 12:17 P.M. was noted on the cross-index plat and is assigned page No. 75, in book No. one No Fee

Jane Jennings
County Official

