

INSTRUCTIONS

1. Original and/or subsequent record used to evaluate the corner position.
2. Description of evidence found, note discrepancies in the record, state method of establishing lost or obliterated corners.
3. Description of monument and accessories set to perpetuate the corner position.
4. Sketch of corner, show all pertinent data which can best be shown in sketch example, corner marking, topography ties, position of accessories, etc.
5. Certification must be signed and sealed by Land Surveyor registered in the State of Montana.
6. Fill in Cross Index & Section Diagram at bottom of sheet.

CERTIFIED CORNER RECORDATION

Corner: NW Section 21

T. 1 N.

R. 58 E.

P.M.M.

Carter County

Record: 1889 GLO: Scheetz: " Set a sandstone 21x10x4 ins. 16 ins. in the ground for cor. to sec. 16,17,20,21. Marked 3 notches on S. and 4 notches on E. edges. From which:
 A pine 12ins. diam. bears N82°W, 22lks. Mkd. "T1N R58E S17 BT"
 A pine 14ins. diam. bears N70°E, 47lks. Mkd "T1N R58E S16 BT"
 A pine 26ins. diam. bears N88°E, 66lks. Mkd. "T1N R58E S16 BT"
 All other trees near – all dead. Raise a mound of stone alongside.

1933 GLO: Bandy: Found "Sandstone 16X14X4 ins. above ground, marked as described in the official record; the original bearing trees killed by fire; but still standing. On W. side of cor. stone, Set an iron post, 3ft. long 2ins. diam., 28ins. in the ground, with brass cap marked

T1N R58E
 S 17 | S 16
 S 20 | S 21
 1933

Dig pits 18x18x12 ins. in each Sec.

Found: 2 1/2in. GL.O. brass cap on 2in. pipe, 6in. above ground, marked as shown above.

Perpetuation:

Place a U.S.F.S 54-9 sign in fence NE 1.0ft. of corner
 A 10in. pine bears N81°W, 24.8ft., scribed "T1N R58E S17 BT". Signed with U.S.F.S. 54-3 and 54-9 signs.

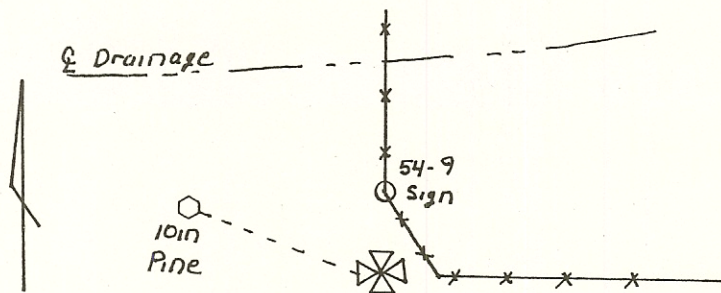

SKETCH OF CORNER

CERTIFICATION

I, JD Ingraham
 certify the information shown herein is true and correct

JD Ingraham
 Signature Ground Party

I, Gerald A. Pavlick
 certify that this Corner Record correctly presents work performed by me or under my direction in compliance with the "Corner Registration Act" (70-22-101, et seq., M.C.A.)

Gerald A. Pavlick
 Signature of Surveyor

Date: 11/3/2006 Reg. No. 8382 S

Employer: Morrison-Maierle, Inc.

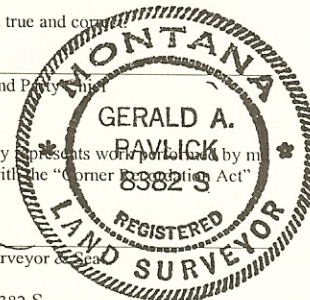

Office of Clerk and Recorder, County of

record" was filed for: **172788 Fee: \$ Bk CR FILE Pg 0**

was noted on the cross **CARTER COUNTY Recorded 02/16/2007 At 02:16 PM**

book No. _____ Pamela J. Castleberry, Clk & Rcdr By Virginia Ludwig, in

Return to: COUNTY CORNER RECORDS

County Official _____

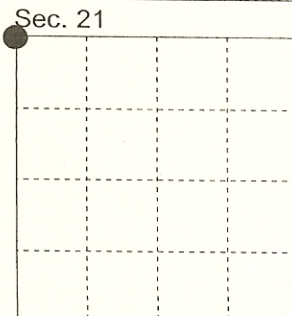

• - corner this sheet