

INSTRUCTIONS

1. On... and/or subsequent record used to evaluate the corner position.
2. Description of evidence found, note discrepancies in the record, state method of establishing lost or obliterated corners.
3. Description of monument and accessories set to perpetuate the corner position.
4. Sketch of corner, show all pertinent data which can best be shown in a sketch example, corner marking, topography ties, position of accessories, etc.
5. Certification must be signed and sealed by Land Surveyor registered in the State of Montana.
6. Fill in Cross Index & Section Diagram at bottom of sheet.

162718

CERTIFIED CORNER RECORDATION

Corner East Quarter Cor. Sec 4 T. 1 N., R. 58 E. P.M.M. Carter County

ORIGINAL RECORD: Surveyed by George Scheets in 1889.

Set a sandstone 17 x 12 x 10 ins. 11 ins in the ground for 1/4 Sec. Cor. marked 1/4 on the west face, dug pits 18 x 18 x 12 ins N & S of stone 5 1/2 ft. dist. and raised a mound of earth 1 1/2 ft high, 3 1/2 ft base alongside.

SUBSEQUENT RECORD: Dependently resurveyed by W.R. Bandy and Ernest Parker in 1933.

at the proportionate point for the 1/4 cor. Set an iron post, 3 ft. long, 1 in. diam., 30 ins. in the ground, with brass cap marked:

1/4  
|  
S41S3  
|  
1933

Dig pits 18x18x12 ins N. & S. of cor.

FOUND : Brass cap marked as per subsequent record. with fiberglass post as a witness post 1.5 ft south of cor.

SET : Monument in good repair. nothing new set.

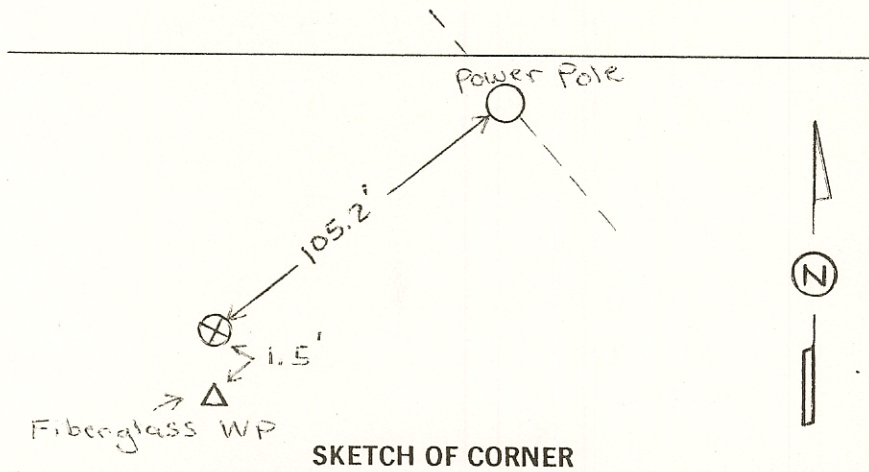

CERTIFICATION

I, Quinn Wright  
certify the information shown herein is true and correct.

Quinn Wright  
Signature Ground Party/Client

I, Jimmie T. Brewer  
certify that this Corner Record correctly represents work performed by me or under my direction in compliance with the "Corner Recordation Act" (70-22401, et seq., M.C.A.)

Jimmie T. Brewer  
Signature of Surveyor

Date: 9-17-90

Employer: Public Lands/HKM

Office of Clerk and Recorder, County of Carter. This "corner record" was filed for record on October 9, 1990 was noted on the cross-index plat and is assigned page No. \_\_\_\_\_, in book No. \_\_\_\_\_

Patricia J. Castleberry  
County Official

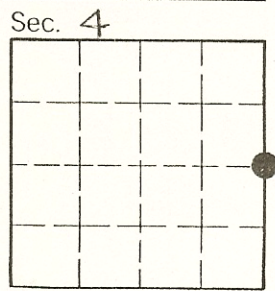

Cross Index No. C-13 T. 1N R. 58E P.M.M

• - corner this sheet

162718