

INSTRUCTIONS

1. Description of evidence found, note discrepancies in the record, state method of establishing lost or obliterated corners.
2. Description of monument and accessories set to perpetuate the corner position.
3. Sketch of corner, show all pertinent data which can best be shown in a sketch example, corner marking, topography lines, position of accessories, etc.
4. Certification must be signed and sealed by Land Surveyor registered in the State of Montana.
5. Fill in Cross Index & Section Diagram at bottom of sheet.

CERTIFIED CORNER RECORDATION

Corner 1/4 COR. 29 | 28 T. 6N R. 9W P.M.M. Deer Lodge County

**1869 GLO Record:** 'Set a 12"x10"x8" granite stone with pits....'

**November, 1992, Found:** Corner position falls on the East side of a North-South county road, and we find no evidence of original corner. The corner is set at proportioned position from section corners North and South.

**March, 1993, Set:** At above noted computed position, set 1"x30" alum. shaft (break-away magnet attached to bottom) with 3-1/4" PCI alum. cap, 4" below road surface, 5 feet East of centerline. Cap marked as shown below.

To reference the corner we set two (2) 5/8" rebars with 1-1/2" alum caps (2923S) in the N-S fence on the East side of the county road. Caps are stamped #1 and #2.

- \* R.M. No. 1 brs. S.56°E., 43.40 feet.
- \* R.M. No. 2 brs. N.63°E., 47.81 feet.

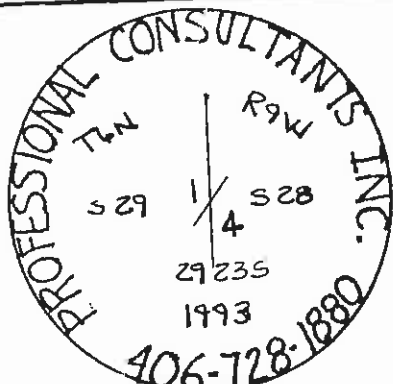
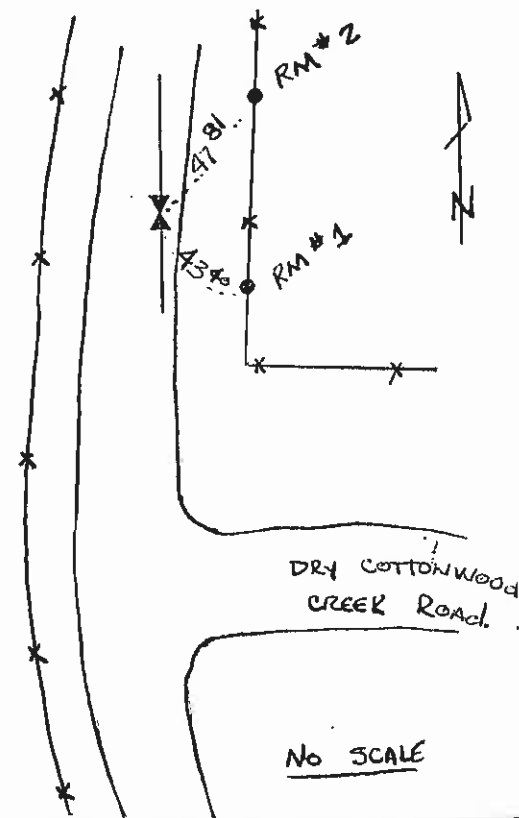

SKETCH OF CORNER

**CERTIFICATION**  
 I, Duane G. Schmitz  
 certify the information shown herein is true and correct.  
Duane G. Schmitz  
 Signature Ground Party Chief  
 I, Richard A. Ainsworth  
 certify that this Corner (Record) correctly represents work performed by me or under my direction in compliance with the "Corner Recordation Act" (70-22-101, et seq., M.C.A.)  
R. A. Ainsworth  
 Signature Professional Engineer & Land Surveyor  
 Date: 12/93 Reg. No. 2923S  
 Employer: Professional Consultants, Inc.

Office of Clerk and Recorder, County of Deer Lodge. This "corner record" was filed for record on December 16, 1994 was noted on the cross-index plat and is assigned page No. 375, in book No. 2 Micelle Anderson - Deputy County Official

• - corner this sheet