

INSTRUCTIONS

1. Original and/or subsequent record used to evaluate the corner position.
2. Description of evidence found, note discrepancies in the record, state method of establishing lost or obliterated corners.
3. Description of monument and accessories set to perpetuate the corner position.
4. Sketch of corner, show all pertinent data which can best be shown in a sketch example, corner marking, topography ties, position of accessories, etc.
5. Certification must be signed and sealed by Land Surveyor registered in the State of Montana.
6. Fill in Cross Index & Section Diagram at bottom of sheet.

CERTIFIED CORNER RECORDATION

Corner W. 1/4, S. 32 T. 6N. R. 24E. P.M.M. MUSSELSHELL County

W1/4 SEC. 32 T. 6N. R. 24E.

RECORDED: 1904 SUBD. BY F.L. CUMMINGS:
 SET SANDSTONE 18 X 12 X 3 INS. MKD 1/4 MI. W. FACE
 RAISE MOUND OF STONE W. OF COR.

FOUND: BROKEN SANDSTONE 2' X 8" X 10"
 MKD 1/4 LAYING LOOSE IN SCATTERED
 MOUND OF STONE. ACCEPT STONE
 AS CORNER. PLACE 30" X 6 REBAR
 28" IN THE GROUND, WITH 3/4" ALUM
 MIN. CSSA CAP MKD:

T. 6N. R. 24E
 1/4
 S31, S32
 1992

BURY ORIGINAL STONE ALONG N SIDE
 OF CORNER. BUILD MOUND OF STONE
 2' X 2', .5" HIGH AROUND COR.

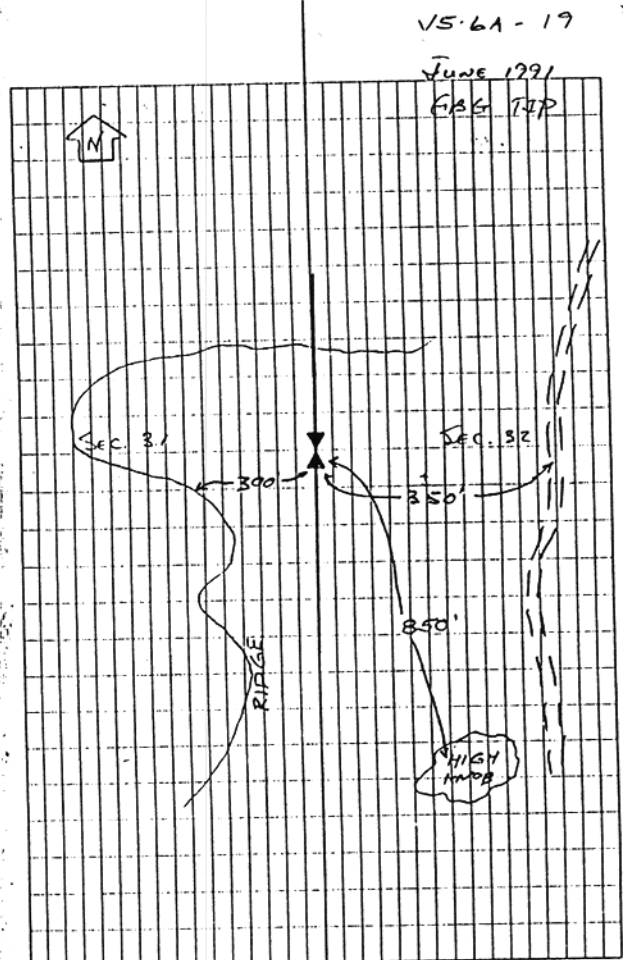

CERTIFICATION

I, GUNNAR B. GETCHELL
 certify the information shown here to be true and correct.

Gunnar B. Getchell
 Signature Ground Party Chief

GUNNAR B. GETCHELL
 certify that this Corner Record correctly represents work performed
 by me or under my direction in compliance with the "Corner
 Marking Act" (70-22-101, et seq., M.C.A.)

Gunnar B. Getchell
 Signature of Surveyor & Seal

Date: 1/93 Reg. No. 9758 LS

Employer: MORRISON-MAERLE/CSSA



SKETCH OF CORNER

Office of Clerk and Recorder, County of Musselshell. This "corner
 record" was filed for record on January 6, 1993 9:01 AM
 was noted on the cross-index plat and is assigned page No. _____, in
 book No. _____

Jane Emang
Roma M. Weigmann
 County Official

