

CERTIFIED LAND CORNER RECORDATION

DESCRIPTION OF CORNER EVIDENCE FOUND, AND ORIGINAL RECORD (IF KNOWN)

FOUND STONE MONUMENT BUT, DUE TO EROSION, NOT READABLE

GLO NOTES: "SET SANDSTONE 18"x18"x3" 12 INS IN THE GROUND FOR COR. OF SECS 9, 10, 15 + 16 MARKED WITH 4 NOTCHES ON S. AND 3 NOTCHES ON E. EDGES FROM WHICH A PINE 9 INS DIA BEARS N.81°E 1.92 CH DIST. MARKED T.6 N., R.26 E, S. 10 B.T. (GONE) A PINE 10 INS. DIA. BEARS S.75°E 1.68 CHS. DIST MARKED T.6 N., R.26 E. S.15 B.T. (FOUND) A PINE 30 INS. DIAMETER BEARS S.28°W. 2.29 CHS. DIST. MARKED T.6 N., R.26 E. S.16 B.T. A PINE 30 INS. DIAM. BEARS N.56°W 3.21 CHS. DIST. MARKED T.6 N., R.26 E., S. 9. B.T." (FOUND)

DESCRIPTION OF MONUMENT AND ACCESSORIES ESTABLISHED TO PERPETUATE THE ORIGINAL LOCATION OF THIS CORNER:

Date of work: JUNE JULY 1977

(SEE OTHER SIDE)

SKETCH, WITH COURSE AND DISTANCE TO ADJACENT CORNERS IF DETERMINED IN THIS SURVEY. (MAY SKETCH OR PASTE REPRODUCTION ON REVERSE SIDE.)

(SEE OTHER SIDE)

Surveyor's Seal

I, James D. Lehman certify that the information shown herein is true and correct. Signature of Ground Party Chief

I, James L. Hahn certify that I have carefully performed or reviewed the work done on the diagrammed corner as reported on this recordation form and approve the same. Signature of Surveyor

DIAGRAM OF CORNER:

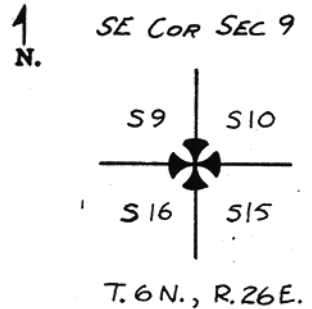

Symbol = Corner recorded on the sheet

2795 S Registration Number

Office of Clerk and Recorder, County of Musselshell

This "corner record" was filed for record on the 23 day of December 1980, was noted on the cross-index plat and is

signed page No. 29:20 AM, in book No. 1.00

Frances L. Dawson by Roberta Snider County Official Deputy

Form 125 - 45227 Cross Index No. N-13 T. 6 E R. 26 E Mer.

