

CORNER RECORD (Survey of Record Index)

See instructions

T 7N R 8W P.M.M. SEC 28 COUNTY POWELL, MONTANA

Please check () one: Subdivision _____, Certificate of Survey _____, Other
 Name _____
 and/or Number _____; Book _____, Page _____; Doc. No. _____
 Block/Lot/Parcel No(s). _____, Corner(s) _____

FOUND 2 1/2" GLO BRASS CAP
ON 1" POST, 14" OUT OF
THE GROUND FOR EAST 1/4
CORNER OF SECTION 29 ONLY

ORIGINAL RECORD
 GLO IN 1914, SET AN IRON POST,
 3' LONG, 1" IN DIA., 26" IN THE
 GROUND, 6" IN A MOUND OF
 STONE, FROM WHICH:
 AN ASPEN, 6" IN DIA. BEARS
 N12°00'E, 19 LKS.
 AN ASPEN, 6" IN DIA. BEARS
 S79°00'E, 25 LKS.

↑
 NORTH
 SCALE 1" = 20'

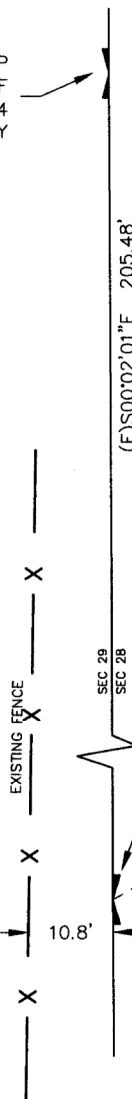
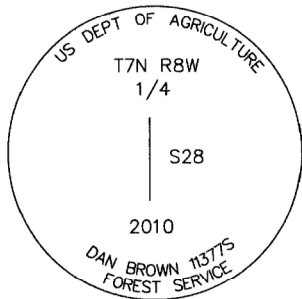
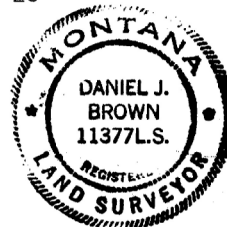

FOUND 1" IRON POST
 WITH 2 1/2" GLO BRASS CAP
 LYING ON GROUND NEXT TO POST
 FOR WEST 1/4 CORNER
 OF SECTION 28 ONLY
 REPLACED WITH 3 1/4"
 FOREST SERVICE ALUM. CAP
 ON 2 1/2"x30" PIPE SET 24"
 IN THE GROUND SURROUNDED
 BY A MOUND OF STONES
 AND MARKED WITH A 5' RED ANGLE IRON

ESTABLISHED NEW 8" DIA.
 ASPEN BEARING TREE
 SCRIBED 1/4 S28 BT

SURVEYOR NOTES

1. CORNER POSITION IN
 NAD83 (CORS 96) DATUM:
 LAT: 46°19'51.212"N
 LONG: 112°37'09.405"W

SEC. 28, T7N, R8W, P.M.M.

SKETCH: show enough information to clearly identify the corner (use back if needed).

● Location in Sec. 28

Office of Clerk and Recorder, County of _____ This "Corner Record" (Survey of Record) was filed for record	<p align="center">Certifications</p> I, <u>Paul Jessop</u> certify that the work represented herein was faithfully performed. <u>Paul Jessop</u> Signature of Ground Party Chief
<p>165965 Fee: \$0.00 Bk Pg POWELL COUNTY Filed 12/10/2010 At 11:10 AM Diane S. Gray, Clk & Rcdr By <u>Dante Beckels</u> Return To: FILING</p> <p>_____ County Official</p>	<p align="center"><u>Daniel J. Brown</u> Signature of Surveyor & Seal</p> Date: <u>12/7/10</u> Lic. No. <u>11377LS</u> Employer: _____